

Elysium Real Properties Pvt. Ltd.
Defining urban landscape through modern architecture

Elysium Central Brochure

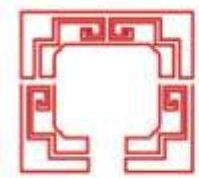

Elysium Real Properties Pvt. Ltd.
Defining urban landscape through modern architecture

About Us

- Residential and Commercial real estate developer
- The Firm was established to develop contemporary structures which are both aesthetically pleasing and combines utility and technology
- Our goal is to build unique multi-family residential structures that convey a sense of distinctive modern living and office / commercial structures that are of the highest international standards
- By anticipating future needs and demands, we develop our projects to fully complement future innovation and energy efficiency

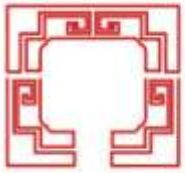

Elysium Real Properties Pvt. Ltd.
Defining urban landscape through modern architecture

Completed Project

ELYSIUM VISTARA is a state-of-the-art residential structure with modern finishes and unmatched amenities for the first time in the city of Coimbatore



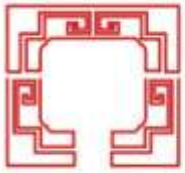

Elysium Real Properties Pvt. Ltd.
Defining urban landscape through modern architecture

Ongoing Projects

- ELYSIUM ACROPOLIS is another state-of-the-art multifamily building off Avinashi Road, Coimbatore
- ELYSIUM LOVEDALE is a Swiss holiday home themed residential project set in the backdrop of Kotagiri hills, Ooty



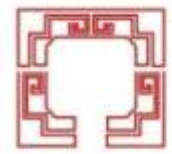

Elysium Real Properties Pvt. Ltd.
Defining urban landscape through modern architecture

Elysium Central

Coimbatore's Premier Commercial Development



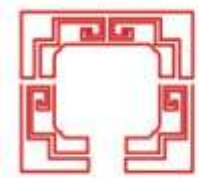

Elysium Real Properties Pvt. Ltd.
Defining urban landscape through modern architecture

Elysium Central

- Elysium Central is designed to cater the requirements of MNCs, leading local corporations and the IT/ITES sector
- State-of-the-art infrastructure and specifications
- Breathtaking elevation and unmatched building standards
- Impressive façade featuring granite throughout the lobby and high ceilings
- Incorporates a significant amount of green space into the common areas inspiring a new class of business lifestyle in Coimbatore

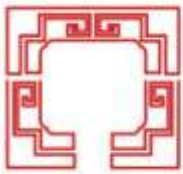

Elysium Real Properties Pvt. Ltd.
Defining urban landscape through modern architecture

Elysium Central - Location

- Elysium Central is located on Puliyakulam Road, Coimbatore
- 300 meters from Race Course
- 8 kilometers from the Airport
- Close proximity to world class hotels
- Close proximity to the upcoming TIDEL IT park
- Close proximity to major Nationalized & Private banks and Govt. Institutions

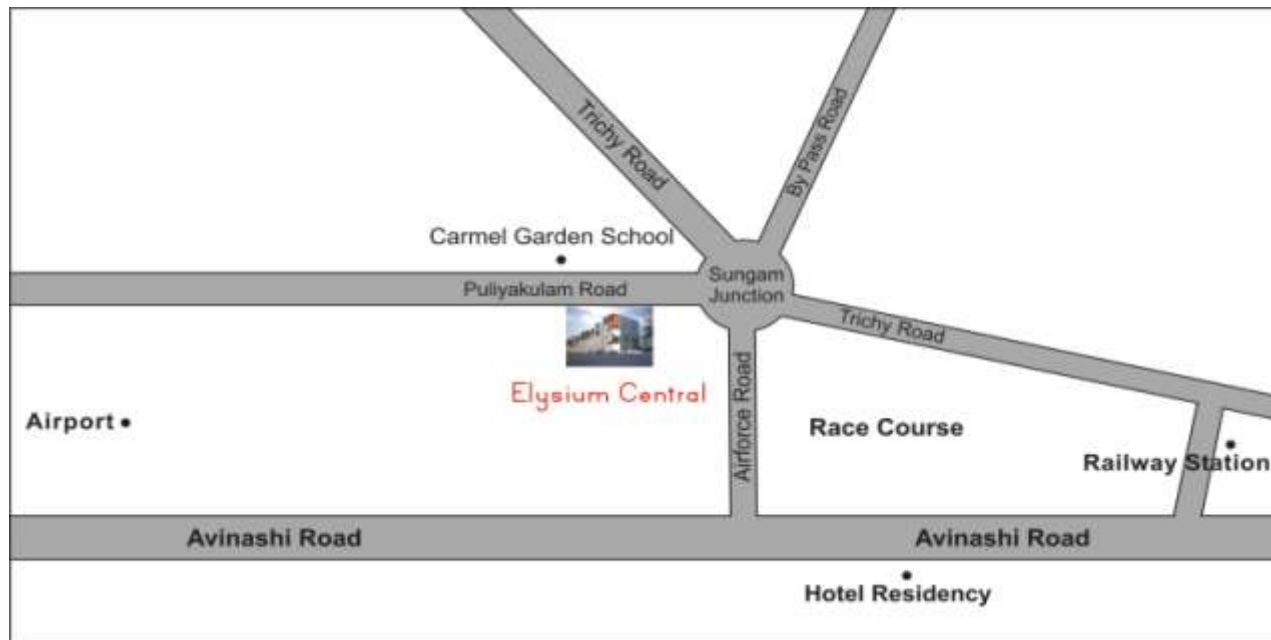

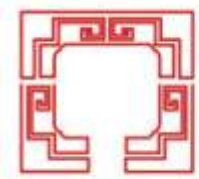

Elysium Central - Specifications

- Area: Super Built Up Area of 62,000 Ft²
- Floor Plate: Typical floor size of 15,500 Ft²
- No. of Floors: Basement + 4 Floors
- Car Park: More than 120 car spaces
- Flexibility: Multi-Tenant
- Floor Space Split: 8,080 & 7,420 Ft²
- Elevation: Glass, Aluminum Louvers and ACP panels
- Floor-to-ceiling: 12 ft height

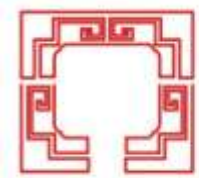

Elysium Real Properties Pvt. Ltd.
Defining urban landscape through modern architecture

Elysium Central - Specifications



- Vitrified Tile Flooring (Tenant option for Raised Flooring)
- Large Column Spans
- Seismic Compliant Building
- Premium Quality Construction Materials
- Granite Finishing in the Lobby Area

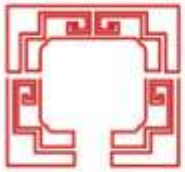

Elysium Central - Basement

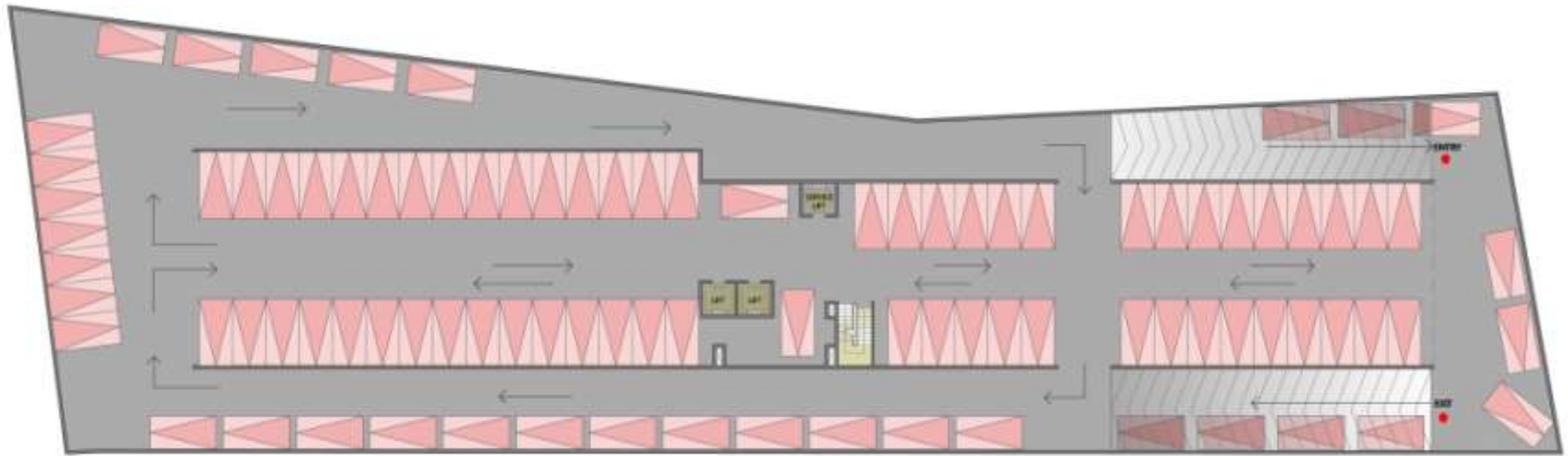

- Intelligent Parking Systems
- 100% power backup
- 120 Car Parks in the ratio of 1 car park for every 516 Ft² exceeding European Parking Norms

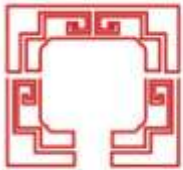

Elysium Real Properties Pvt. Ltd.
Defining urban landscape through modern architecture

Elysium Central – Ground Floor

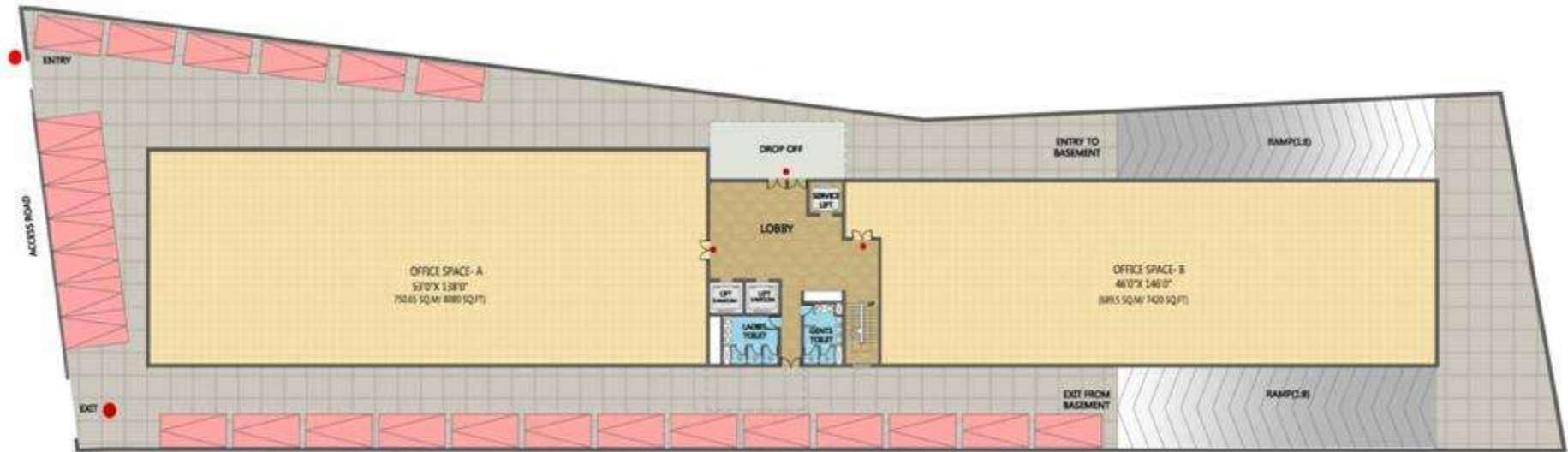

- Ideally located Greater Lobby Area to cater to all Tenants
- 7,000 ft² Hoarding Space on the Exterior for Tenant Advertising
- Tenant Signage

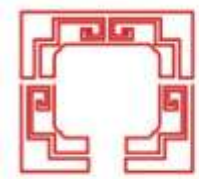

Elysium Real Properties Pvt. Ltd.
Defining urban landscape through modern architecture

Elysium Central – Ground Floor



- Flexibility of using Space either for Commercial or Office purposes

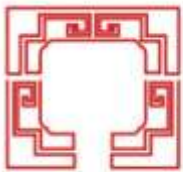

Elysium Real Properties Pvt. Ltd.
Defining urban landscape through modern architecture

Elysium Central – First Floor



- 22' & 26.5' Clear Span Interiors allowing Tenants freedom in Planning
- 90% Building Efficiency Ratio
- 2 High-Speed passenger Lifts with Automatic Rescue Control
- Telecommunication and Broadband available through multiple providers

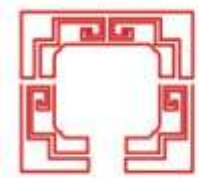

Elysium Real Properties Pvt. Ltd.
Defining urban landscape through modern architecture

Elysium Central – Interiors



- Abundant lighting evenly distributed at any given point
- Fire Alarm, Detection and Fire Hydrant Systems
- Building maintained by professional Facility Management Company

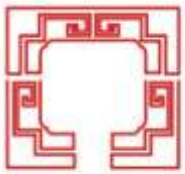

Elysium Real Properties Pvt. Ltd.
Defining urban landscape through modern architecture

Elysium Central – Toilets & Basement Parking



- Separate Service Lift
- Dedicated service shaft for HVAC systems
- Sufficient area for Services on Terrace

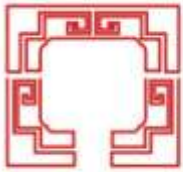

Elysium Real Properties Pvt. Ltd.
Defining urban landscape through modern architecture

Elysium Central Special Offer

- 2% Discount on Selling Price
- * Rental Guarantee on first 3 months of Leasable period
 - ✓ 1st Month – 25% of Proposed Rental Income
 - ✓ 2nd Month – 50% of Proposed Rental Income
 - ✓ 3rd Month – 100% of Proposed Rental Income
- * Free Car Parks until the Offer Period

* Note: Subject to Terms & Conditions

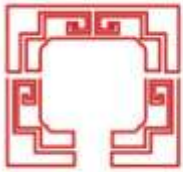

Elysium Real Properties Pvt. Ltd.
Defining urban landscape through modern architecture

Contact Us

Elysium Real Properties Private Limited

245 / 3-4, II Floor, Veejay Hall

Race Course, Coimbatore 641 018

Tamil Nadu, India

Tel: +91- 422 - 656 2222 / 3333/ 4444

Fax: +91 - 422- 420 4550 / 51

Info@elysium.in

www.elysium.in