

ARYAN FOUNTAIN SQUARE

Luxury with Style



Four side Ventilated Apartment



Aryan Founttain Square is an Luxury Apartment consist of 324 units of Flat in 2.25 Acres of Land and this residential enclave has 2 & 3 Bedroom varying from 779 Sqft. to 924 Sqft. which are comfortable to live in with world class amenities.

Aryan Founttain Square has been carefully designed only for you. Keeping in mind all the luxury amenities which will provide a great lifestyle within affordable budget. The construction quality environment and location of this residential project makes this a perfect place to settle down with your family.



Company Profile

- Aryan Hometec are a dedicated, experienced and competent team of construction professionals. We the “Aryan family” are strongly bound with a string of trust, commitment and unfailing support. When we promise Quality, what we are actually assuring you of is world class quality in terms of design and architecture, top notch quality of construction materials, fittings and fixtures for a betted quality of life that you will find irresistible.
- Completed projects are **Aryan orchid, Aryan Grand Residency and Aryan Fountain Square** . The company is currently developing 4 new projects including Aryan Golden Arena and Aryan Palm Grove.

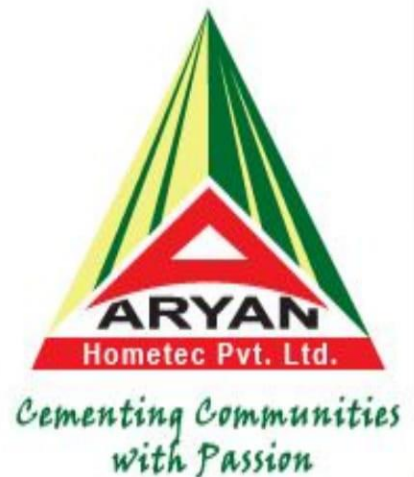

About the Project

- Total Area: 2.25 Acres
- Location: Sarjapura–Attibele Road
- Structure: Stilt+Ground+8 Floors
- Total Units: 324
- Configuration: 2BHK SBA(779sft, 793sft,
837sft)
3BHK SBA(924sft)

Pricing: 3500 per sft (All Inclusive)

Configuration	Saleable Area	Price	Loan
2BHK	779	27 Lakh	10:90
3BHK	924	33 Lakh	20:80

Scheme

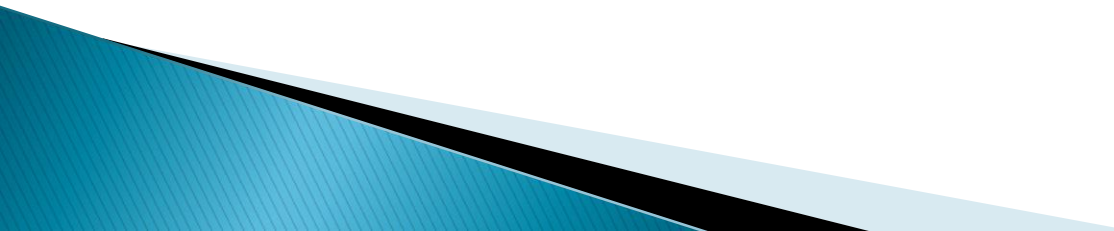
- Approved by All Leading Banks
 - 90% Home Loan will be provided
 - PMAY Scheme eligible
- 

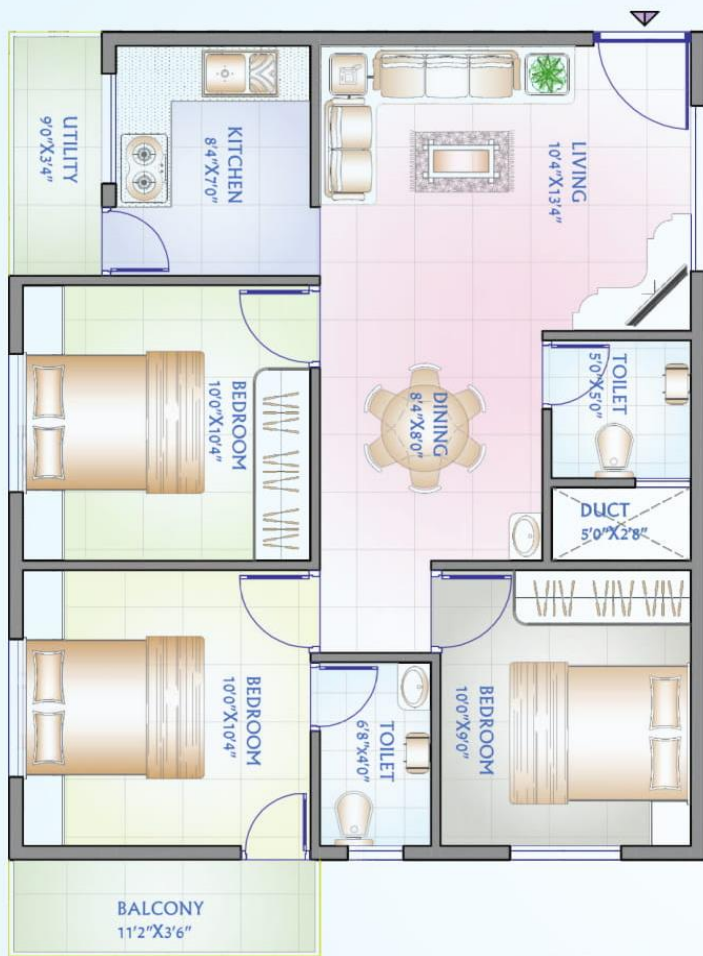

Flat No.	: 135 - 935
Type	: 3 BHK
Area	: 924 Sft
Entry Direction	: NORTH

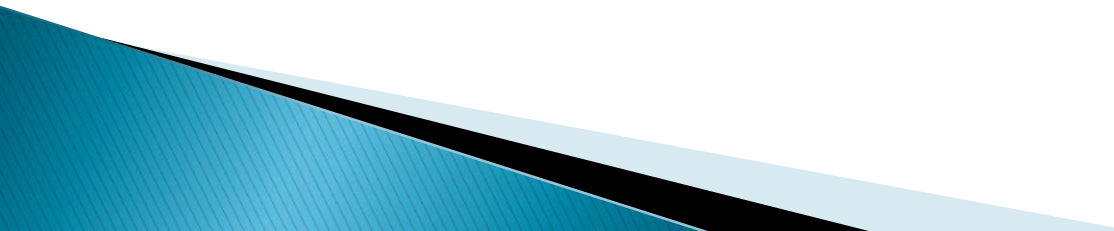

Pricing for 2BHK –779 sft

- ▶ Rs.3500/sft
 - ▶ All inclusive – Rs. 27 Lakh (Approx)
 - ▶ Only 10% down payment.
- 

Pricing for 3BHK –924 sft

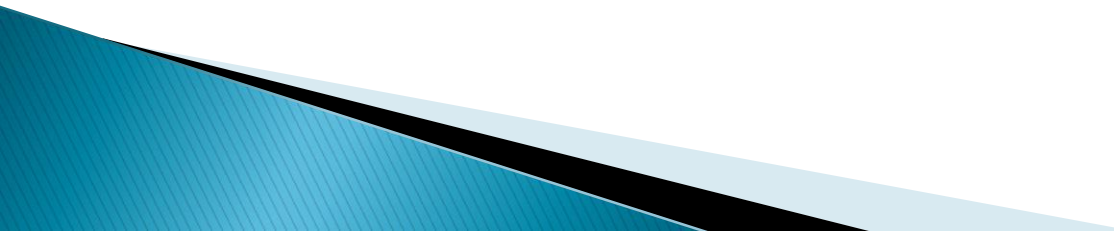
- ▶ Rs.3500/sft
 - ▶ All inclusive – Rs. 33 Lakh (Approx)
 - ▶ Only 20% down payment.
- 

AMENITIES :

- Swimming pool
- Amphitheater
- Multipurpose Hall
- Jogging Track
- A fully equipped club House
- Toddler's pool
- Utilitarian Landscaped Spaces
- Table Tennis
- Gymnasium
- Club house
- Super Market
- Round the clock security
- Power back up
- 8 Lifts (6 passenger capacity)
- Children's play area

EXISTING ROAD

ROAD MARGIN LINE

BUILDING LINE

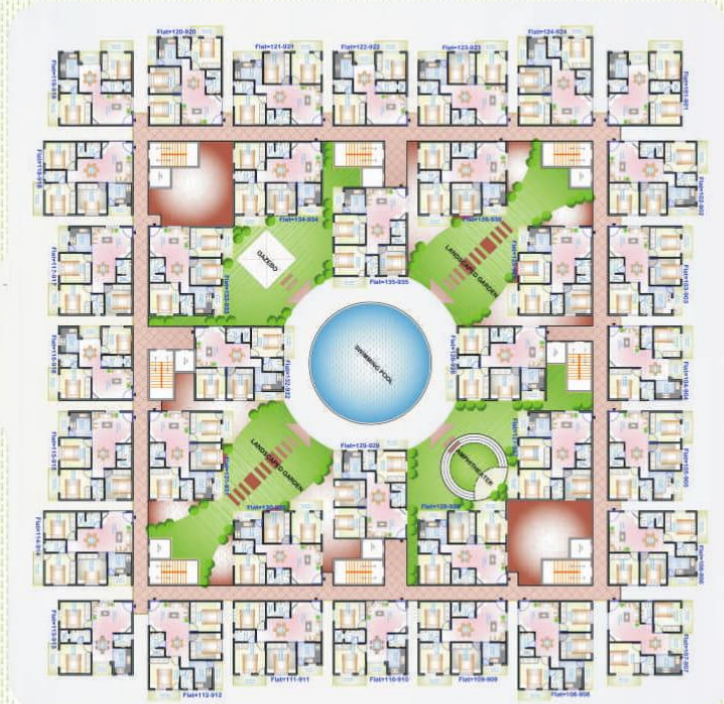

Fountain Square USP

- ▶ Property located at Sarjapura–Attibele Road (Proposed 300' STRR)
- ▶ 40–50 % of open spaces with the full of greenery.
- ▶ RERA Approved.
- ▶ BRS Global & Indus International School Nearby.
- ▶ Well connected to Good hospitals, School/College, Hotel/Resort, Hypermarket, Metro Station, Police Station, Fire Station, Bus Stop, Railway Station, IT Hub (Electronic City, Sarjapura).

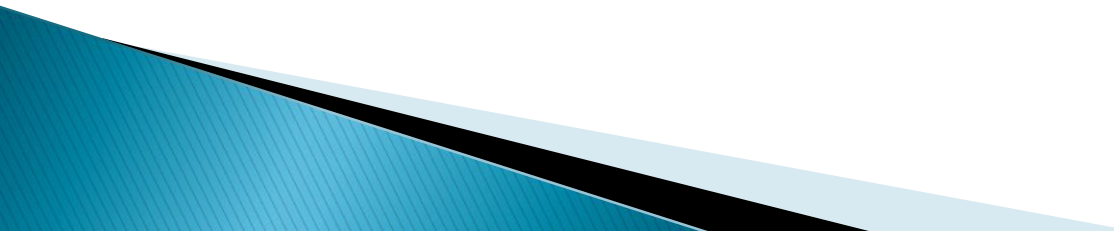
- ▶ Close proximity to major IT hub and Manufacturing companies like Infosys, Biocon, Wipro. Manufacturing companies like Titan, TVS and Ashok Leyland.
 - ▶ Near by proposed Infosys SEZ Tech Park of 202 acres.
 - ▶ Azim Premji University of 52 acres near by.
 - ▶ Ideal location for the people working for Bengaluru's IT corridor.
- 

*Thank
you*



**CONTACT: 9741083786
9620776000**