



LOGIX

City Center

"A BRAND NEW UNIVERSE!"



LOGIX CITY CENTER, NOIDA

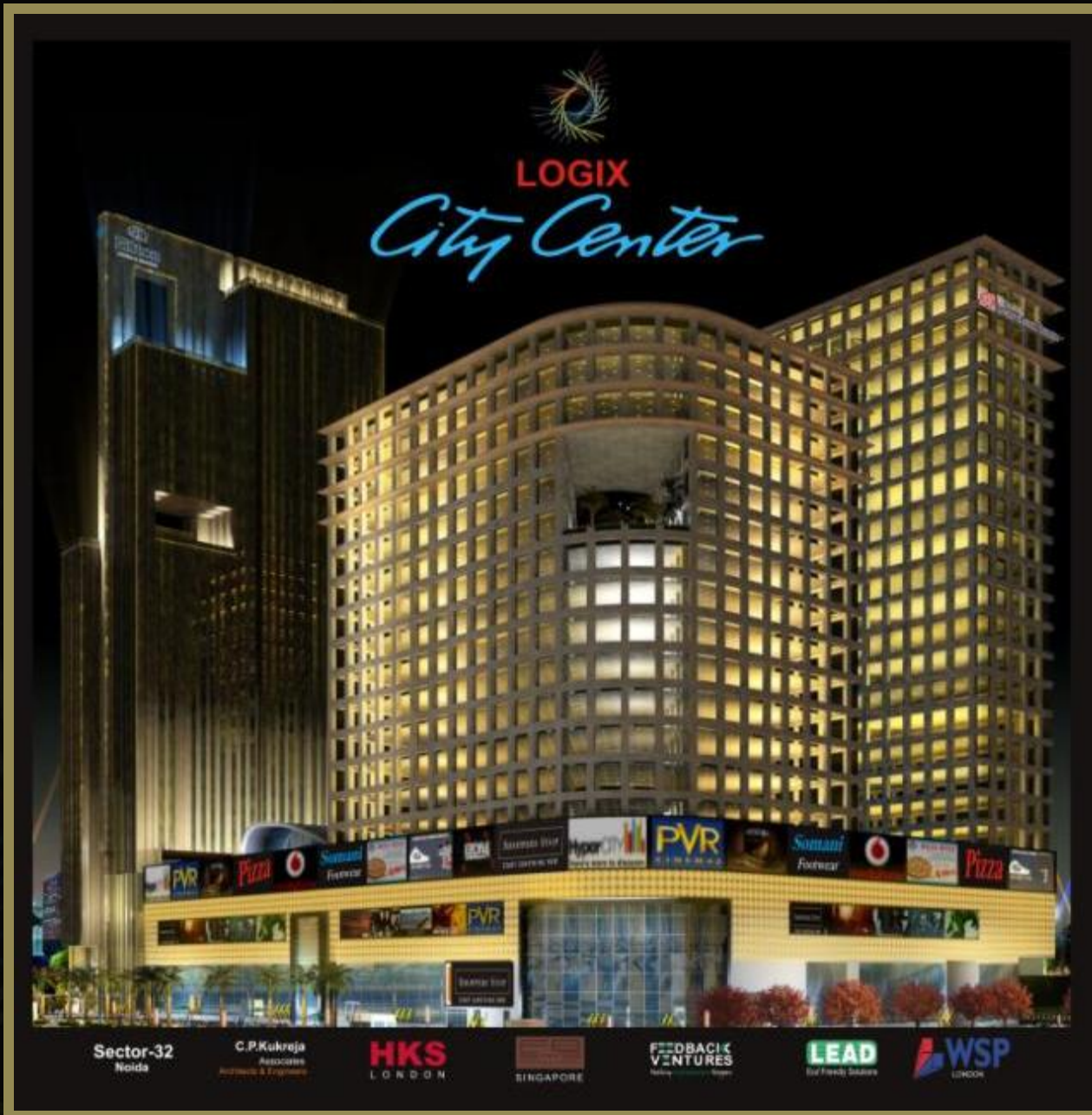

Sector-32
Noida

C.P.Kukreja
Architects
Architecture & Engineering

HKS
LONDON

SINGAPORE

FEEDBACK
VENTURES
Pune

LEAD
Your Friendly Solutions

WSP
LONDON

SITE MASTERPLAN



LOCATION MAP



Destination Par Excellence!

- ❖ Located at the nodal point of Noida City Center planned by Noida Authority.
- ❖ Great accessibility with roads of 45 & 75 mtrs on two sides.
- ❖ Well connected to all parts of Noida, South, East & Central Delhi through road & metro lines.
- ❖ Proposed Greater Noida metro line connects with Noida at the sector 32 metro station.
- ❖ 20 m green belt on both sides.

LOGIX CITY CENTER, NOIDA

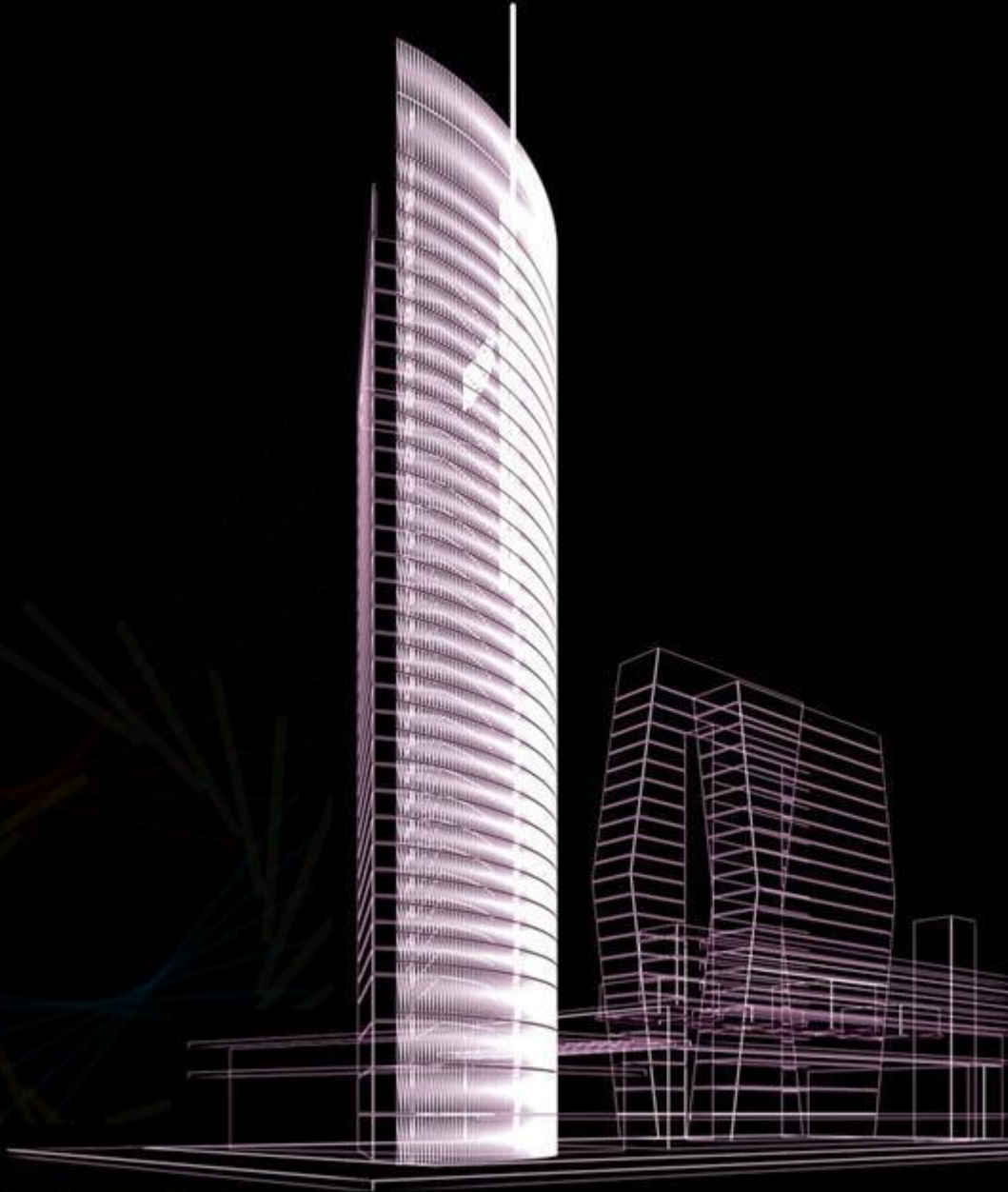

Project Brief

Project Size: ~ 1.7 million Sq.ft.

- 🌀 **Shopping Mall**
7.5 Lacs Sq.Ft
- 🌀 **One 5 Star Hotel**
4.5 Lacs Sq.Ft
- 🌀 **4 Star Hotel**
2 Lacs Sq.Ft
- 🌀 **Premium Office Tower**
3 Lacs Sq.Ft
- 🌀 **Ample Basement Parking**
For ~1200 Cars

5 STAR HOTEL & BANQUETS



Star Struck!

- ❖ Finest 5 Star Hotel chain for business & leisure travelers spread over 2 acres.
- ❖ More than 200 keys.
- ❖ Largest convention center & exclusive banquet hall.
- ❖ Luxury retail, lavish spa & fitness centre.

4 STAR BUSINESS HOTEL



- Signature Building
- One of the best business Hotel brands globally
- Green, environment friendly structure.
- Avenues for business & pleasure alike.

LOGIX CITY CENTER MALL

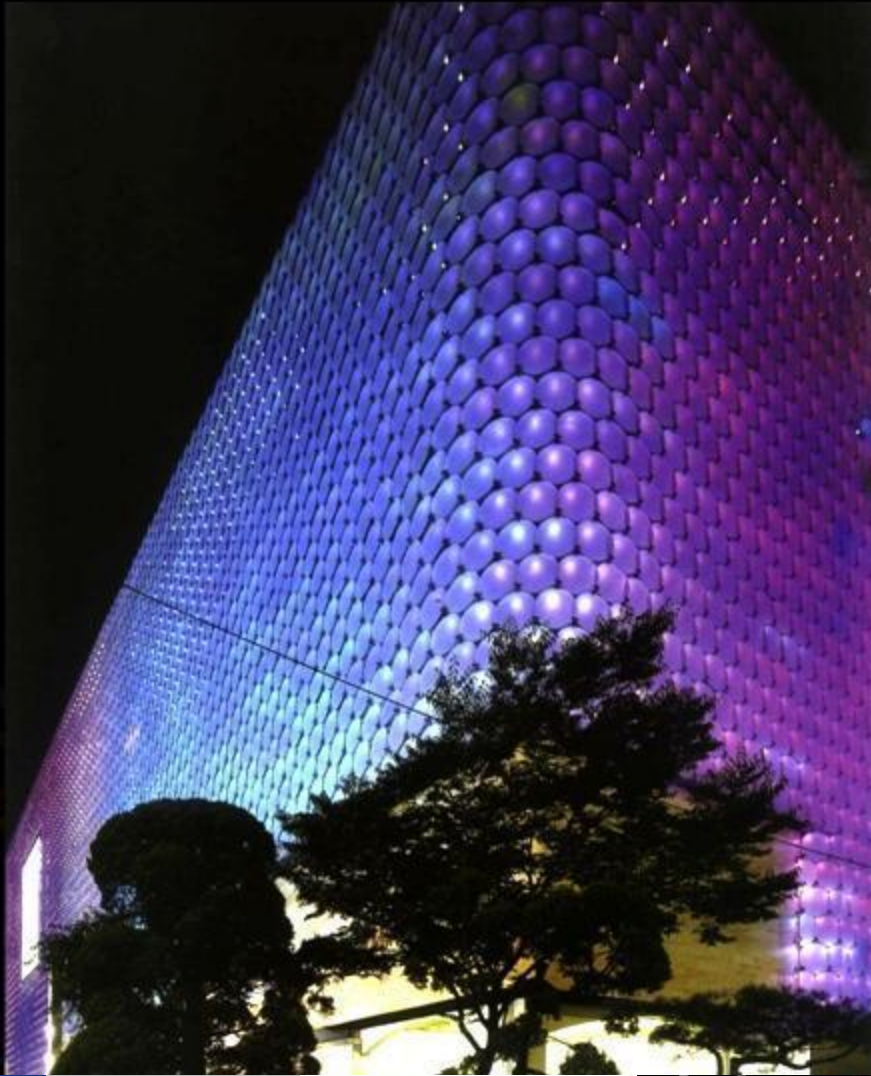

- ❧ Conceived as the Arterial activity area of the Logix City Center.
- ❧ 5 lac sq ft spread over 5 levels.
- ❧ Approx. 1 lac of retail & entertainment therapy on each level.
- ❧ Large inviting atrium area, beautifully landscaped terraces.
- ❧ Energy efficient design, systems & processes.

PVR
CINEMAS

SHOPPERS STOP
START SOMETHING NEW

HyperCITY
There's more to discover.

blu
RHYTHM & BOWL
A JOINT VENTURE BETWEEN PVR & MAJOR CINPLEX

Visit
**FOOD
UNION**

Jumbo

CROSSWORD

OFFICE



The Business Nebula

- ❖ Most coveted office address in NCR.
- ❖ Exclusive state-of-the-art corporate office space.
- ❖ Intelligently designed facilities providing long term infrastructure solutions.
- ❖ Super efficient floors equipped with modern corporate amenities like.
 - ❖ Hi tech business center.
 - ❖ Rejuvenating spa & well equipped fitness center.
 - ❖ Exclusive club lounge.
 - ❖ Concierge Service & Travel Desk.

OFFICE PRICE LIST

Basic Sale Price	Rs.8150/- per sq.ft.
IFMS	Rs.100/- per sq.ft.
Capital Replenishment Fund	Rs.150/- per sq.ft
Lease Rent	Rs.250/- per sq.ft
PLC (on road facing units)	Rs.200/- per sq.ft

PAYMENT PLAN

Booking Amount	10% of BSP
Within 30 days of booking	10% of BSP
Within 60 days of booking	10% of BSP
Within 90 days of booking	10% of BSP
Within 120 days of booking	7.5% of BSP + 50% of PLC
Within 150 days of booking	7.5% of BSP + 50% of PLC
Within 180 days of booking	7.5% of BSP
Within 210 days of booking	7.5% of BSP
Within 240 days of booking	5% of BSP
Within 270 days of booking	5% of BSP
Within 300 days of booking	5% of BSP
Within 330 days of booking	10% of BSP
At the time on offer of possession	5% of BSP + Lease Rent + CRF + IFMS

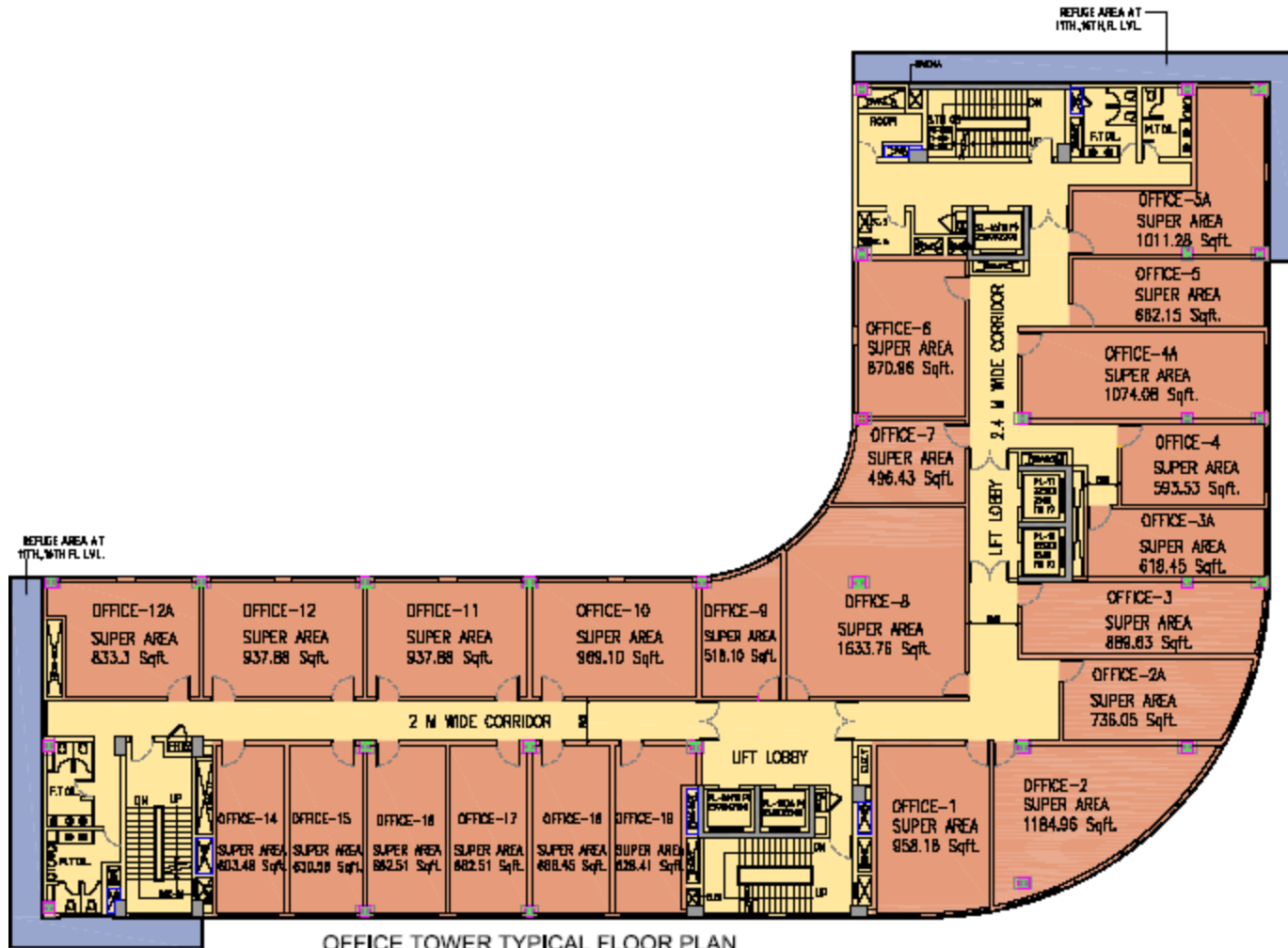

OFFICE TOWER TYPICAL FLOOR PLAN
6TH TO 11TH AND 15TH TO 17TH



LOGIX
City Center