



# YAMUNA ASHA CITY

PREMIUM GATED COMMUNITY RESIDENTIAL LAYOUT  
N.H. 66 KULAI, MANGALORE



ACK/KA/RERA/1257/334/PR/190614/003360



**YAMUNA ASHA CITY**

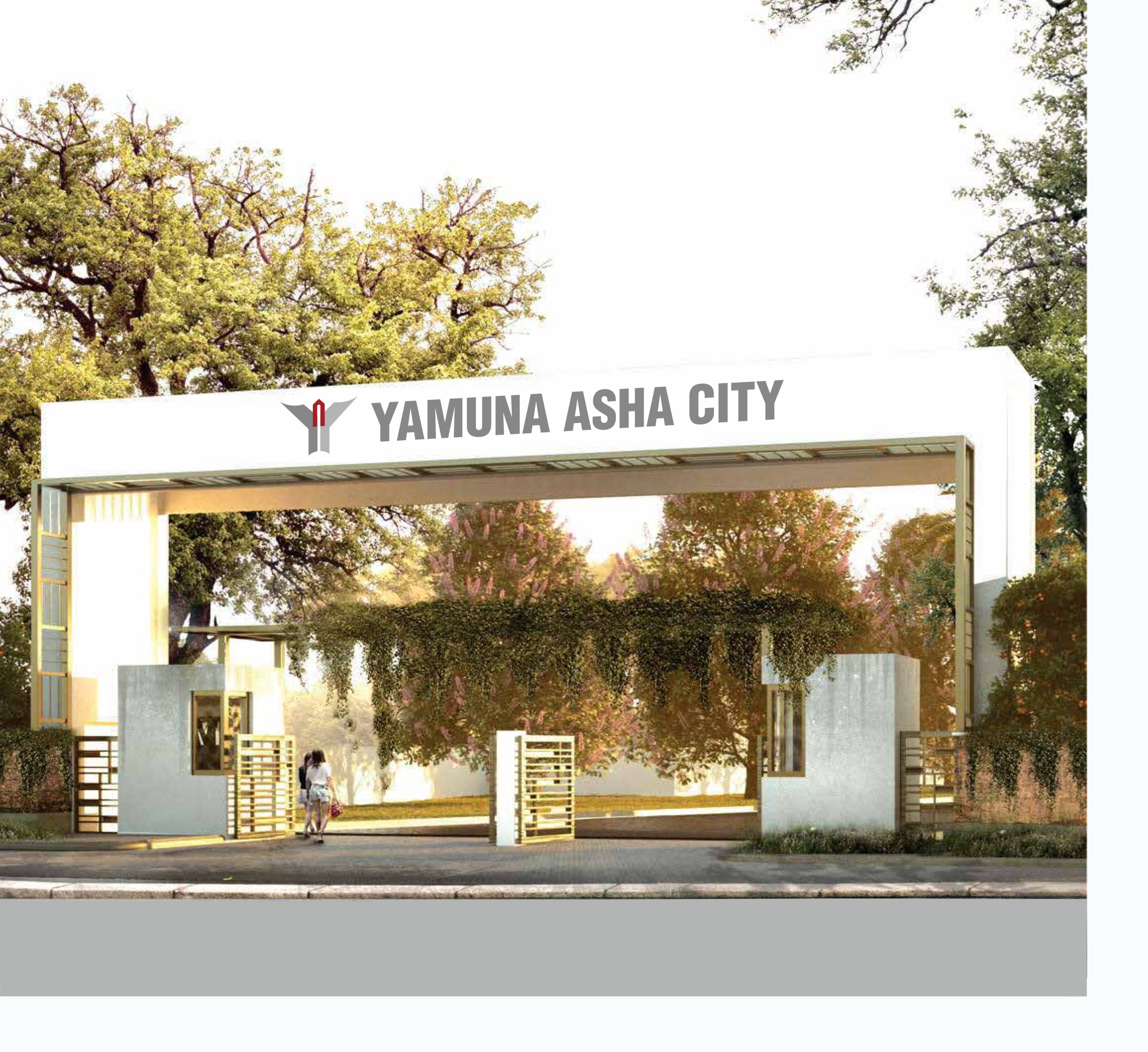

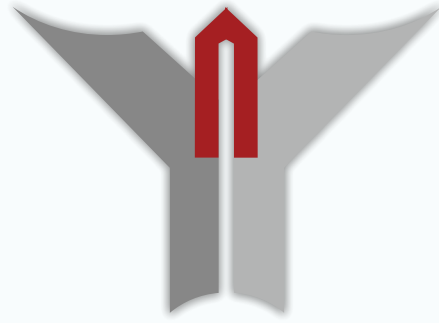

## WELCOME

Introducing Yamuna Asha city by Yamuna Homes & Design Pvt Ltd. The first of kind premium residential gated community sites consisting of 5, 6, 7 to 12 cents sites within a 45 acres residential habitat at N.H. 66 Kulai, Mangalore, Creating an exceptional new community in the Historic Beach city of Mangalore. The rapid growth of Mangalore city has led to a number of high rise apartments being built as a fixed template for collective housing.

Yamuna Asha City offers a refreshing change of a community habitat falling within 150 mtrs of the Arabian Sea. Here we strive to create an ambience for a contemporary lifestyle with modern amenities within a secure community. With only 30 percent of the enclave being utilised for built-up spaces, the residents will enjoy over 70 percent of free space. Lush gardens and water features aim to provide a serene environment for the residents. The layout and the architecture have been planned incorporating all requirements for modern living. Being within walking distance of the sea shore also provides you with additional recreational facilities. Proximity to reputed schools, colleges and business establishments makes Yamuna Asha City an ideal location for your home to lead a holistic and balanced lifestyle.



# PARK LIFE



**These beautiful new homes will be set alongside 4.5 acres of picturesque open parkland featuring wildflower meadows, waterbody and informal play areas designed to provide an excellent quality of life for generations to come.**



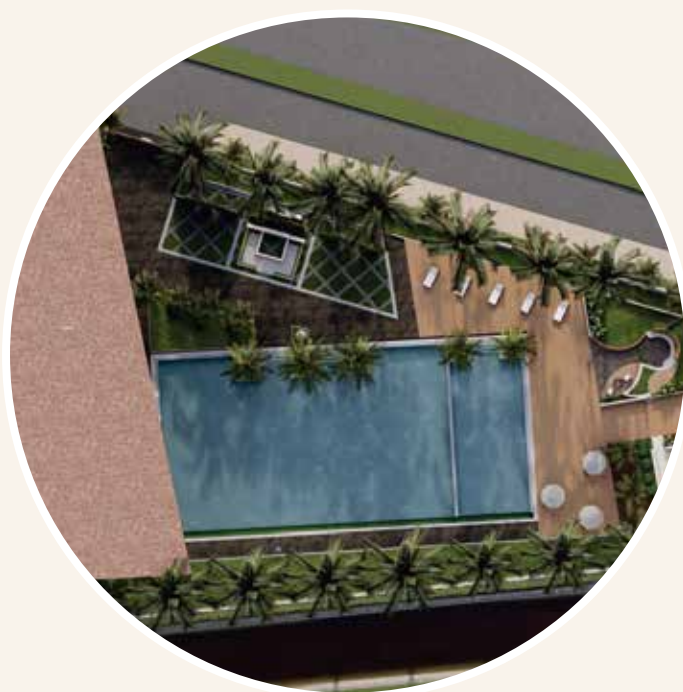



**CLUB HOUSE SITE PLAN**

**GROUND FLOOR PLAN**





**1ST FLOOR PLAN**

**2ND FLOOR PLAN**







GROUND FLOOR



FIRST FLOOR

AREA : 2090 SQFT

## VILLA TYPE - 1 FLOOR PLAN



GROUND FLOOR



FIRST FLOOR

AREA : 2554 SQFT

# VILLA TYPE - 2 FLOOR PLAN



AREA : 2554 SQFT

### VILLA TYPE -3 FLOOR PLAN



# AMENITIES



24-HOUR SECURITY WITH CCTV SURVEILLANCE.



CHILDREN'S PLAY AREA.



ASPHALT-FINISH ROADS AS PER IRC STANDARDS.



SOLAR STREET LIGHTS.



CENTRALIZED S.T.P WITH RECYCLED WATER USED FOR LANDSCAPING.



INFORMAL PLAYGROUND WITH BASKETBALL & TENNIS COURTS. INDOOR BADMINTON COURT



FULL-FLEDGED CLUB HOUSE WITH SWIMMING POOL. GYMNASIUM



UNDERGROUND ELECTRICITY CABLES WITH INDIVIDUAL SERVICE TRENCH FOR EACH SITE.



24-HOUR WATER SUPPLY WITH OVERHEAD TANK OF 2 LAKH LITRES STORAGE CAPACITY.



4.5 ACRE LUSH GREEN PARK WITH SEATING AND OTHER COMFORTS.



WIDE ROADS WITH BEAUTIFUL STREETSCAPE AND STORM WATER DRAINS.



LANDSCAPED WATERFRONT DEVELOPED WITH JOGGING & BICYCLE TRACKS.

# MASTER PLAN



 EAST ENTRANCE GATEWAY	<b>1</b>	 PARK	<b>9,10 &amp;11</b>
 COMMERCIAL SITE	<b>2</b>	 CLUB HOUSE	<b>12</b>
 VISITORS WAITING AREA	<b>3</b>	 CHILDREN'S PLAY AREA	<b>13</b>
 SITE OFFICE	<b>4</b>	 PLAYGROUND	<b>14</b>
 TREE PARK	<b>5</b>	 JOGGING TRACK	<b>15</b>
 FLORAL PARK	<b>6</b>	 BASKETBALL & TENNIS COURT	<b>16</b>
 WATER FRONT DEVELOPMENT	<b>7</b>	 S.T.P. S.T.P.	<b>17</b>
 YOGA RETREAT PARK	<b>8</b>	 SOUTH ENTRANCE GATEWAY	<b>18</b>



RAHEJA WATERFRONT



TOWARDS MANGALORE CITY

NH 66

TOWARDS SURATHKAL

# LOCATION





A UNIQUE VENTURE BY



1st Floor, Nalapad Building, Mallikatta, Kadri, Mangalore - 575 003  
Landline: +91 824 2217 755



**PRESENTED BY :**



**For Bookings Contact :**

**+91-97417 35307, +91-94489 12515**

Essel Tower, 1st Floor, Bunts Hostel Circle, Mangalore 575003

Email: [sales@vajrarealties.com](mailto:sales@vajrarealties.com) Website: [vajrarealties.com](http://vajrarealties.com)