



Suncity Projects Pvt. Ltd.

Chandigarh Office : SCO No. 173-174, Ground Floor, Sector 17-C, Chandigarh. Ph. : +91-9357505011, +91-9357505012.

Corporate Office : N-49, First Floor, Connaught Place, New Delhi - 110001 (India). Ph. : +91 -11 -4152 3164-168, Fax. : +91-11 -41517870/ 23324536.

Site Address : Sector-20, Panchkula.

email : infoparikrama@suncityprojectsLtd.com; website : www.suncityprojectsLtd.com/parikrama.htm

LIVE A GREEN LIFESTYLE





*Satisfy your taste for a good life ,as
Parikrama lets you experience the best.*

PARIKRAMA - BIRD'S EYE VIEW



PARIKRAMA SITE PLAN



LEGENDS

1. ENTRANCE PLAZA
2. LAP POOL
3. LEISURE POOL
4. CHILDREN'S POOL
5. PUTTING GREEN
6. PARTY LAWN
7. SHOPPING PLAZA
8. LAWN
9. SAND PIT
10. TRELLIS
11. WATER PLAY
12. AMPHI-THEATRE
13. SIT-OUT WITH CHILDREN'S PLAY AREA
14. TOWER ENTRANCE COURT
15. PARKING
16. BASKET BALL COURT
17. LAWN TENNIS COURT
18. SKATING RINK
19. BADMINTON COURT
20. CRICKET PRACTICE PITCH
21. RAMP DOWN TO BASEMENT
22. CLIMBING WALL
23. JOGGING TRACK
24. SHOPS
25. CLUB
26. SPORTS CENTER WITH INDOOR SQUASH COURT
27. DROP-OFF AREA





ENGINEERED FOR A LIFETIME OF BEAUTY & SERVICE,

PARIKRAMA

CAN ONLY BE DESCRIBED AS CAPTIVATING.



Spirited colours of the environs at the Parikrama are complimented by unmatched selection of facilities & amenities.

Confirming to the widely accepted norms of luxury and splendor, Parikrama offers an array of amenities that define not only the lifestyle one aspires for but also the very essence of comfort and grandeur.

It caters to more than the basic residential requirements, providing an ambience that facilitates a confluence of tranquility and effervescence.

Located in the serene and verdant environs of Panchkula, Parikrama is close to the highway, railway station, Chandigarh Airport and the IT Park. It is unique in its design and form, with

its state-of-the-art apartments and activity zones, sprawled over twenty-six acres. The multistoried towers at Parikrama offer choices of air-conditioned apartments and non-airconditioned apartments along with which you have easy access to an on premises convenience store. Its in-house club offers a bar lounge, banquet hall, gymnasium, library, conference room, kids play area, card room and a restaurant, 3 swimming pools (kids pool, lap pool and leisure pool), state-of-the-art health club with steam-sauna facility and a sports complex that provides golf putting green, jogging tracks, badminton, basket ball, tennis & squash courts, cricket pitch (for practice), skating rink and sand pits for kids.

PARIKRAMA OFFERS YOU THIS AND MUCH MORE.

THE EDIFICE

There has been an immense application of mind to bring out an architectural refinement within the Group Housing Complex. Firstly, the location has been judiciously decided, giving the customer the finest of green serene space.

The developer has fashionably-dressed the surroundings with smart use of nature, natural resources and man made resources, fusing it incredibly with art, giving you "PLANNED AESTHETICS".

Foundations laid on the ground are strong, enabling every structure to withstand all adversity. The exteriors are imposing, and stand majestic and impressive.

Note : The property of Parikrama is freehold and the license to construct on the property has been obtained from HUDA.

THE ENVIRONMENT

18 ACRES OF GREEN AREA

We are committed to provide you an ecologically acceptable state-of-the-art technology which brings in a safe and healthy environment to live in.

Reverse osmosis system for clean and safe drinking water; rain water harvesting for utilization of rainwater which benefits the soil and sprinklers for horticultural use are all part of the plans in order to provide you with a trouble free environment and a healthy lifestyle.

And of course, in order to give you a safe and secure environment, there is a state-of-the-art security system, starting right from the main gate to your tower.

THE LANDSCAPES

The landscapes are to be created while keeping the Green Space in mind. Soothing for the eyes and healing to the soul is how you can describe the very glimpse of the magnetizing beauty of the territory.



THE LIVING ROOM

- Walls : POP punning with acrylic
- Floors : *Imported marble / equivalent
- Doors : **Vitrified tiles / equivalent
- Window / Glazing : Hardwood door frame with European style flush door
- Ceiling : Powder coated aluminum with double rebate
- : Acrylic emulsion paint



THE KITCHEN

- Walls : 2' high ceramic tiles above the counter / equivalent
- Floors : Ceramic tiles / vitrified tiles / equivalent
- Doors : Hardwood door frame flush door
- Window / Glazing : Powder coated aluminum with double rebate / equivalent
- Ceiling : Acrylic emulsion paint
- Wood Work : Modular woodwork with accessories (Italian Style) / equivalent
- C.P. Fittings Sanitary Fixtures : Double bowl stainless steel sink with drain board and with single lever fittings



THE BEDROOM

- Walls : POP punning with acrylic
- Floors : Vitrified tiles, laminated wooden flooring in master bedroom
- Doors : Hardwood door frame with flush doors
- Window / Glazing : Powder coated aluminum with double rebate
- Ceiling : Acrylic emulsion paint
- Wood Work : Complete wardrobe woodwork



THE BATHROOM

- Walls : Imported tiles / equivalent
- Floors : Ceramic tiles / vitrified tiles / equivalent
- Doors : Hardwood door frame with flush doors
- Window / Glazing : Powder coated aluminum with double rebate
- Ceiling : Cement plaster with false ceiling gypsum board or equivalent
- C.P. Fittings Sanitary Fixtures : *Granite counter, Italian counter top in master toilet, mirrors, sanitary fixtures, single lever C. P. fittings in wash basin & shower. Provision for hot & cold water supply system / equivalent
- : **Granite counter, mirrors, sanitary fixtures & single lever C. P. fittings in wash basin & shower. Provision for hot & cold water supply system / equivalent

THE SERVANT ROOM

- Walls : Acrylic emulsion paint
- Floors : Ceramic tiles
- Doors : Hardwood door frame with flush doors
- Window / Glazing : Powder coated aluminum with double rebate
- Ceiling : Acrylic emulsion paint

THE BALCONY

- Floors : Ceramic tiles
- Ceiling : Permanent paint finish

THE FACADE

- Walls : Permanent texture / Paint finish

*Features available in A.C. Apartments only / **Features available in Non A.C. Apartments only



THE CONVENIENT SHOPPING

Looking at the daily shopping need of the customer, the connoisseur plans to give you convenience stores which will take care of all your basic daily requirements.



THE EDUCATIONAL INSTITUTION

For the young aspirants, there is a school in the complex that provides world class education. Access to knowledge couldn't be better and easier.

THE CLUB HOUSE



BANQUET HALL

GYMNASIUM

LIBRARY

CONFERENCE ROOM

KIDS PLAY AREA

CARDS ROOM

RESTAURANT

BAR LOUNGE

KIDS POOL

LAP POOL

LEISURE POOL

STEAM - SAUNA BATH



SPORTS COMPLEX



GOLF PUTTING GREEN

JOGGING TRACKS

TENNIS COURTS

BADMINTON COURT

BASKET BALL COURT

SQUASH COURT

SKATING RINK

SAND PITS FOR KIDS

CRICKET PITCH (FOR PRACTICE ONLY)



TOWER C

NON AC APARTMENT

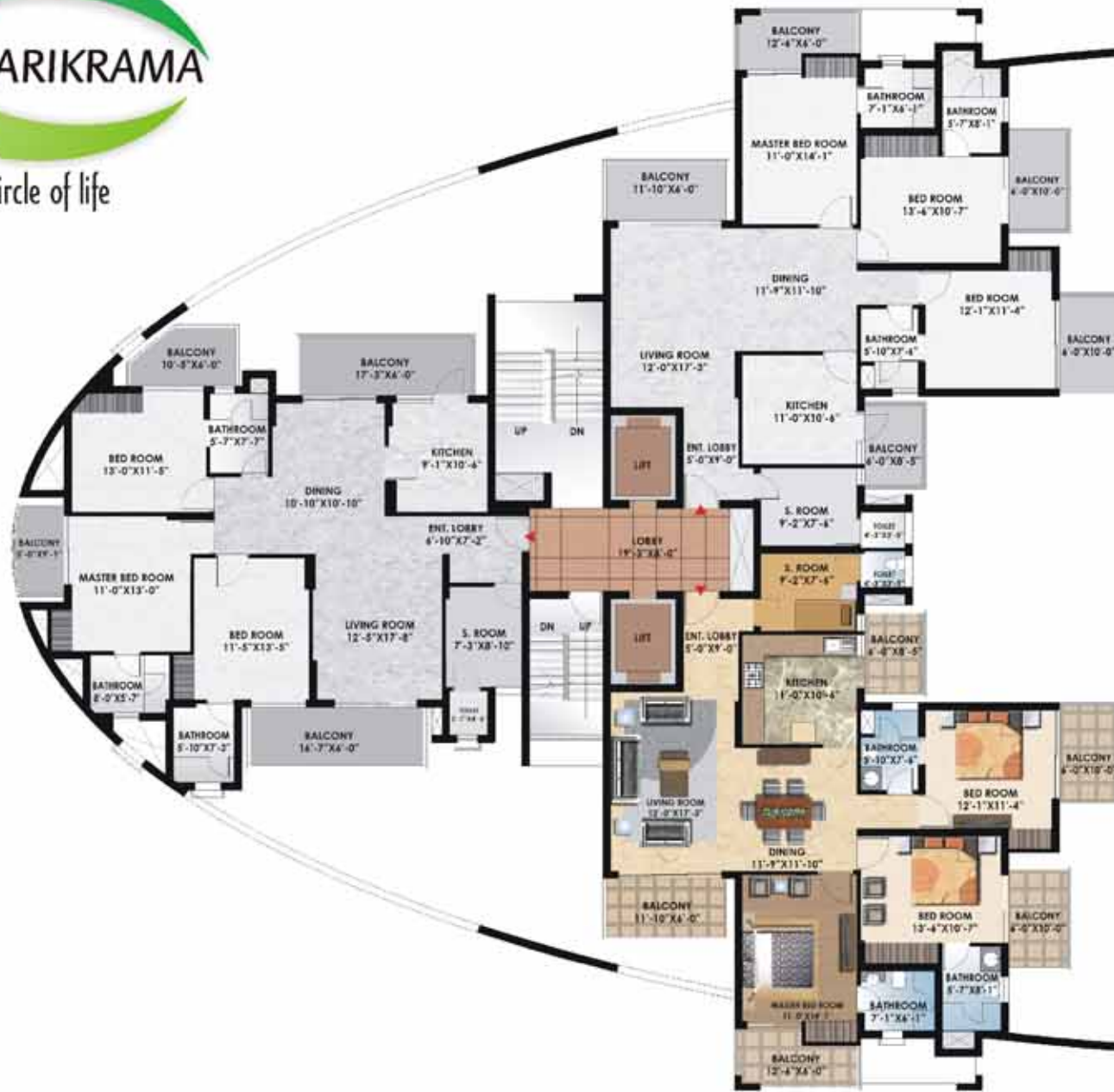

TOWER C

NON AC APARTMENT

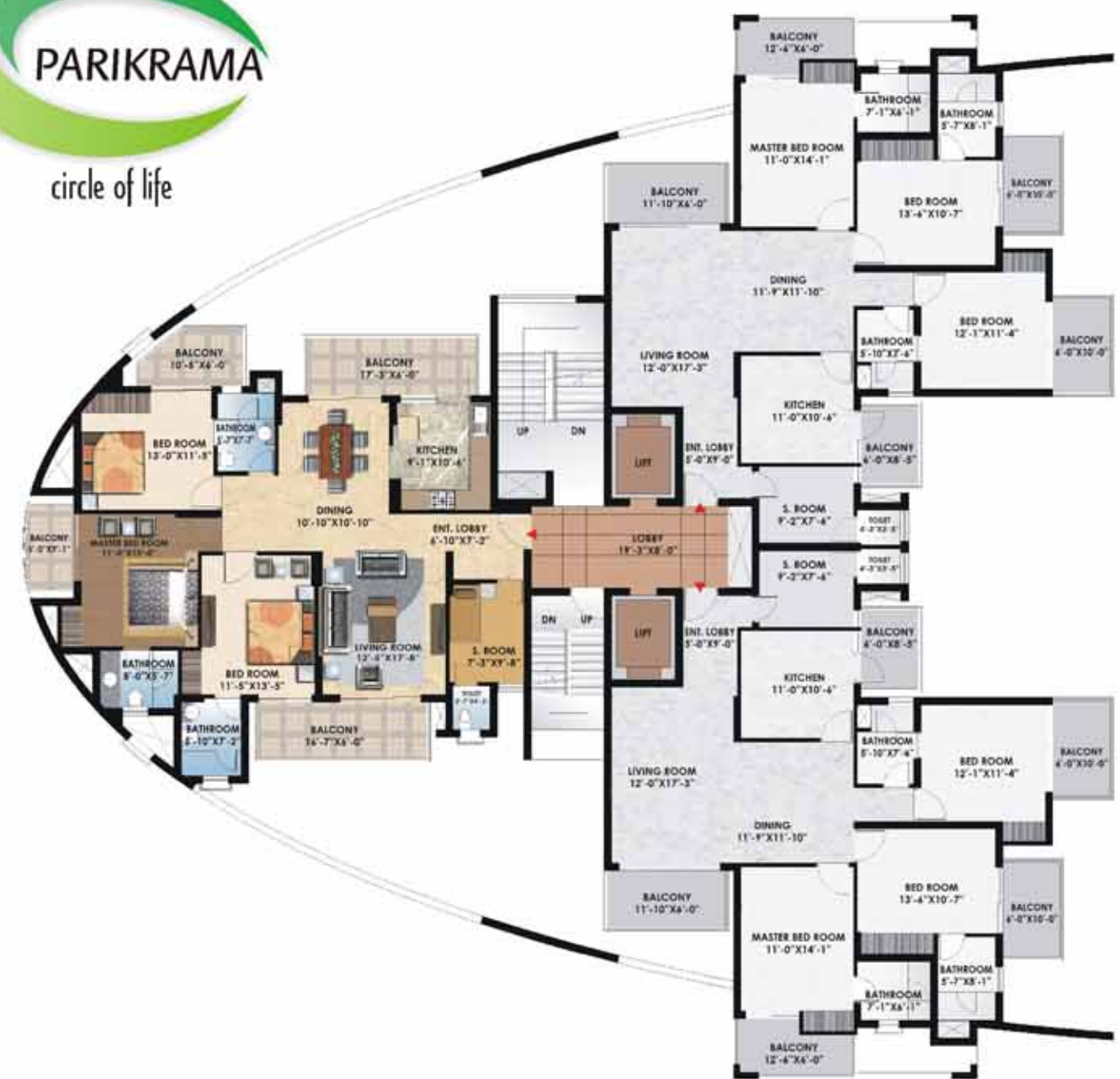

3 BEDROOM
+ S. ROOM
SALE AREA = 1850 SQ. FT.

GREY MARKED BLOCKS SHOWN IN THE DRAWING ARE TOWERS FOR THE ABOVE MENTIONED TYPE OF APARTMENT.



3 BEDROOM
+ S. ROOM
SALE AREA = 1850 SQ. FT.

GREY MARKED BLOCKS SHOWN IN THE DRAWING ARE TOWERS FOR THE ABOVE MENTIONED TYPE OF APARTMENT.

TOWER B

AC APARTMENT



PARIKRAMA

circle of life

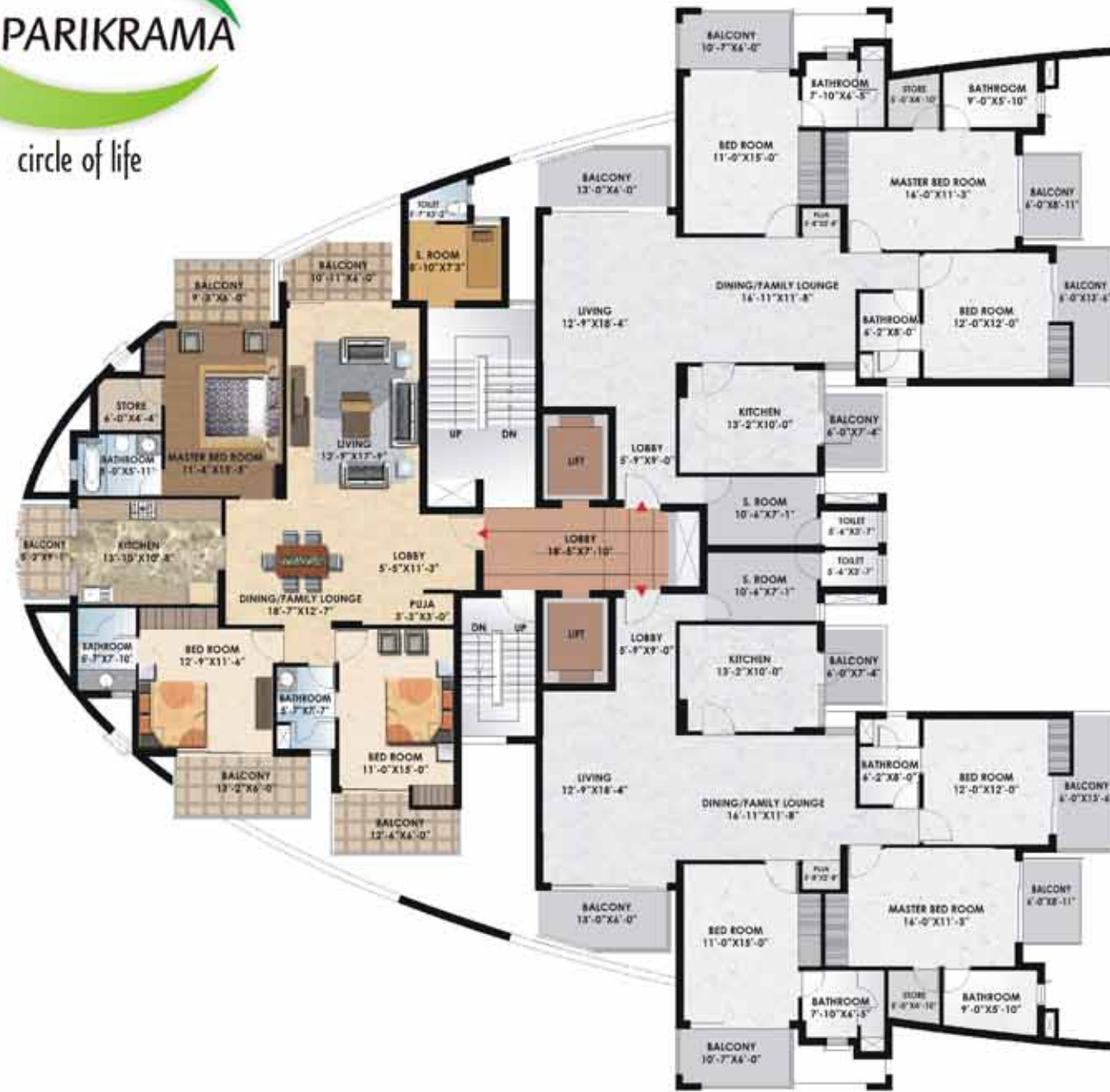

TOWER B

AC APARTMENT



PARIKRAMA

circle of life



3 BEDROOM
 + S. ROOM + STORE + PUJA ROOM
 SALE AREA = 2150 SQ. FT.

GREY MARKED BLOCKS SHOWN IN THE DRAWING ARE TOWERS FOR THE ABOVE MENTIONED TYPE OF APARTMENT.



3 BEDROOM
 + S. ROOM + STORE + PUJA ROOM
 SALE AREA = 2150 SQ. FT.

GREY MARKED BLOCKS SHOWN IN THE DRAWING ARE TOWERS FOR THE ABOVE MENTIONED TYPE OF APARTMENT.

TOWER A

AC APARTMENT



PARIKRAMA

circle of life

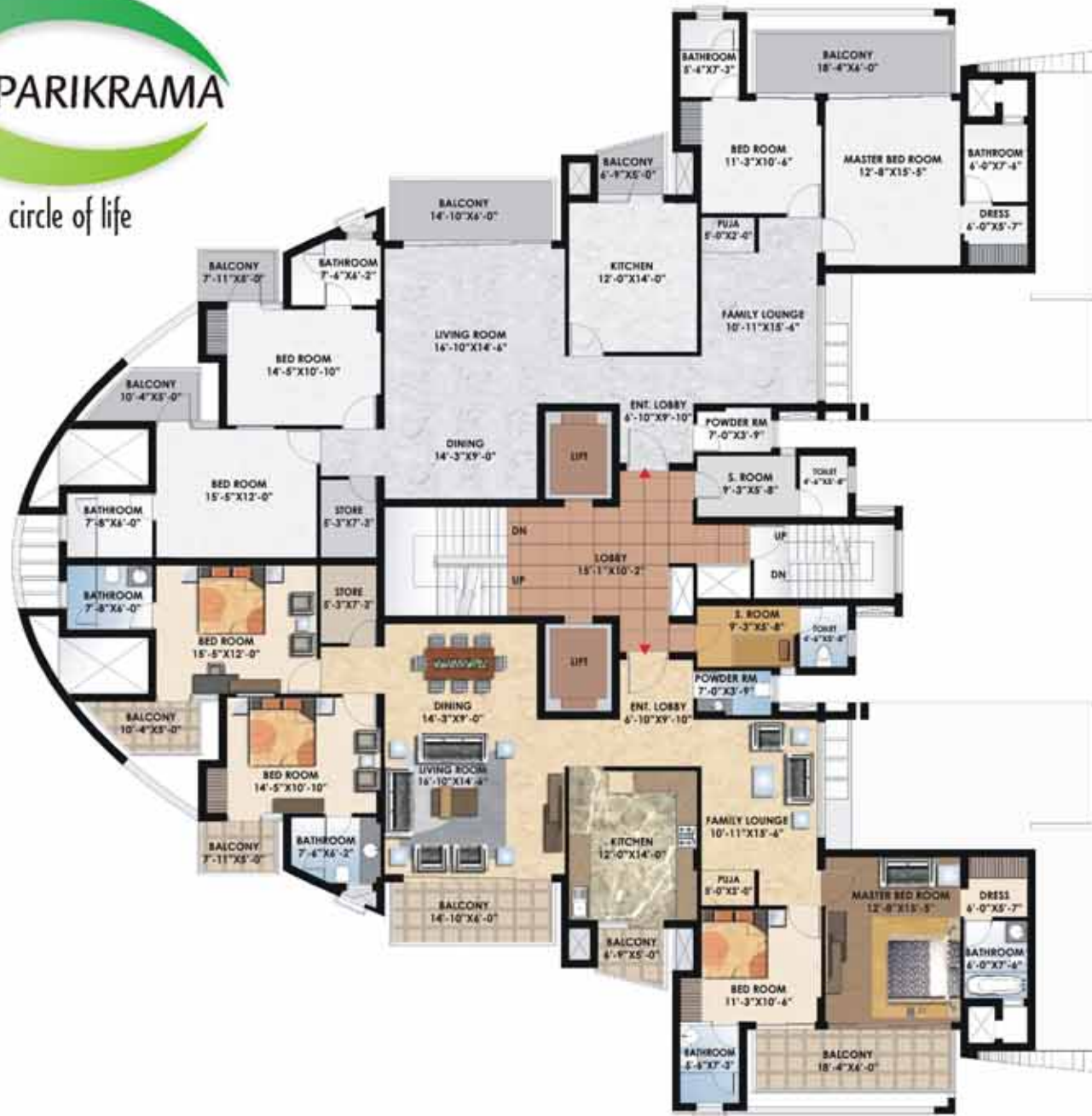

TOWER A

AC APARTMENT



PARIKRAMA

circle of life



4 BEDROOM
 • S. ROOM • STORE • LOUNGE • PUJA ROOM
 SALE AREA = 3050 SQ. FT.

GREY MARKED BLOCKS SHOWN IN THE DRAWING ARE TOWERS FOR THE ABOVE MENTIONED TYPE OF APARTMENT.



5 BEDROOM
 • S. ROOM • STORE • LOUNGE • PUJA ROOM
 SALE AREA = 3600 SQ. FT.

GREY MARKED BLOCKS SHOWN IN THE DRAWING ARE TOWERS FOR THE ABOVE MENTIONED TYPE OF APARTMENT.

TOWER A

AC APARTMENT



PARIKRAMA

circle of life



TOWER A

AC APARTMENT



PARIKRAMA

circle of life



**DUPLEX LOWER FLOOR
5 BEDROOM**
• S. ROOM • STORE • LOUNGE • BAR • COURTYARD
SALE AREA = 6300 SQ. FT.

GREY MARKED BLOCKS SHOWN IN THE DRAWING ARE TOWERS FOR THE ABOVE MENTIONED TYPE OF APARTMENT.



**DUPLEX UPPER FLOOR
5 BEDROOM**
• S. ROOM • STORE • LOUNGE • BAR • COURTYARD
SALE AREA = 6300 SQ. FT.

GREY MARKED BLOCKS SHOWN IN THE DRAWING ARE TOWERS FOR THE ABOVE MENTIONED TYPE OF APARTMENT.

PROJECT SPECIFICATIONS AND FEATURES

FEATURES	A.C. APARTMENTS	NON A.C. APARTMENTS
1. C.P. fittings	Jaquar or equivalent	Jaquar Continental or equivalent
2. Chimney & hob	Kaif or equivalent	Sun flame or equivalent
3. Modular switches	Anchor Roma or equivalent	Anchor Roma or equivalent
4. Geyser	Racold or equivalent	X
5. Fan	Crompton or equivalent	X
6. Chinaware	Keramang or equivalent	Cera, Hindware or equivalent
7. Jacuzzi	Master bedroom	X
8. Shower cubical in all bathrooms	✓	Only in master bathroom
9. Designer light fittings	✓	X
10. Centralized communication system	✓	✓
11. Modular kitchen	✓	✓
12. R.O. drinking water	✓	✓
13. Optical fibre cable	✓	✓
14. Provision for Dish T.V.	✓	✓
15. Club features		
Bar lounge		
Gymnasium		
Banquet hall		
Card room		
Restaurant	Free membership	Optional membership with charges
Library		
Conference room		
Kids play area		
Steam/sauna bath		
Kids Pool, lap pool & leisure pool		
16. Sports complex		
Golf putting greens		
Jogging tracks		
Badminton, basket ball / tennis court		
Squash	✓	✓
Cricket pitch		
Skating rink		
Sand pits for kids		
17. Video door phone	✓	X
18. Power backup	8 Kw	4 Kw
19. Convenience store	✓	✓
20. 24 hours three tier security	✓	✓
21. High speed lifts	✓	✓
22. Children's playground	✓	✓
23. Drivers lounge	✓	✓
24. Provision for gas system	✓	✓
25. Fire fighting	✓	✓
26. Earthquake resistant structure	✓	✓
27. School	✓	✓



Launched Projects

Township
Sector-54, Gurgaon

Retail with Office Space
Vasant Kunj

Business Unit, Sector 54
Gurgaon

Life at its best
Group Housing
M. G. Road, Gurgaon

Mall cum Multiplex
Delhi

Business Unit, Sector-65
Gurgaon

Township
Jaipur-Sikar Road, Jaipur

The World's Mall
Mall cum Multiplex
New Delhi

Business Unit, Sector-21
Gurgaon

Township
Sector 34,35,36 Rohtak-Sonipar Road, Rohtak

Mall cum Multiplex with Office Space
Jaipur

Township, Main AB Bypass Rd
Indore

Township
Sec-33, Kaithal

Business Unit
M.G Road, Gurgaon

Multi-storied Apartments
Jaipur

Forthcoming Projects

Jaipur
An Exquisite Retail Destination

Mohali
An Exquisite Retail Destination

BAREILLI MALL
An Exquisite Retail Destination

HI-TECH CITY
GHAZIABAD
Hi-tech Township
Ghaziabad

HI-TECH CITY
MATHURA
Hi-tech Township
Mathura

IT SEZ
Pataudi Road
Gurgaon

LEISURE CITY
Entertainment Destination
Greater Noida

The contents of the design have no legal bindings and are subject to changes without any notice as per the circumstances. The pictures used are purely depictions and may vary from the actual site.

ACCESS TO PARIKRAMA

