

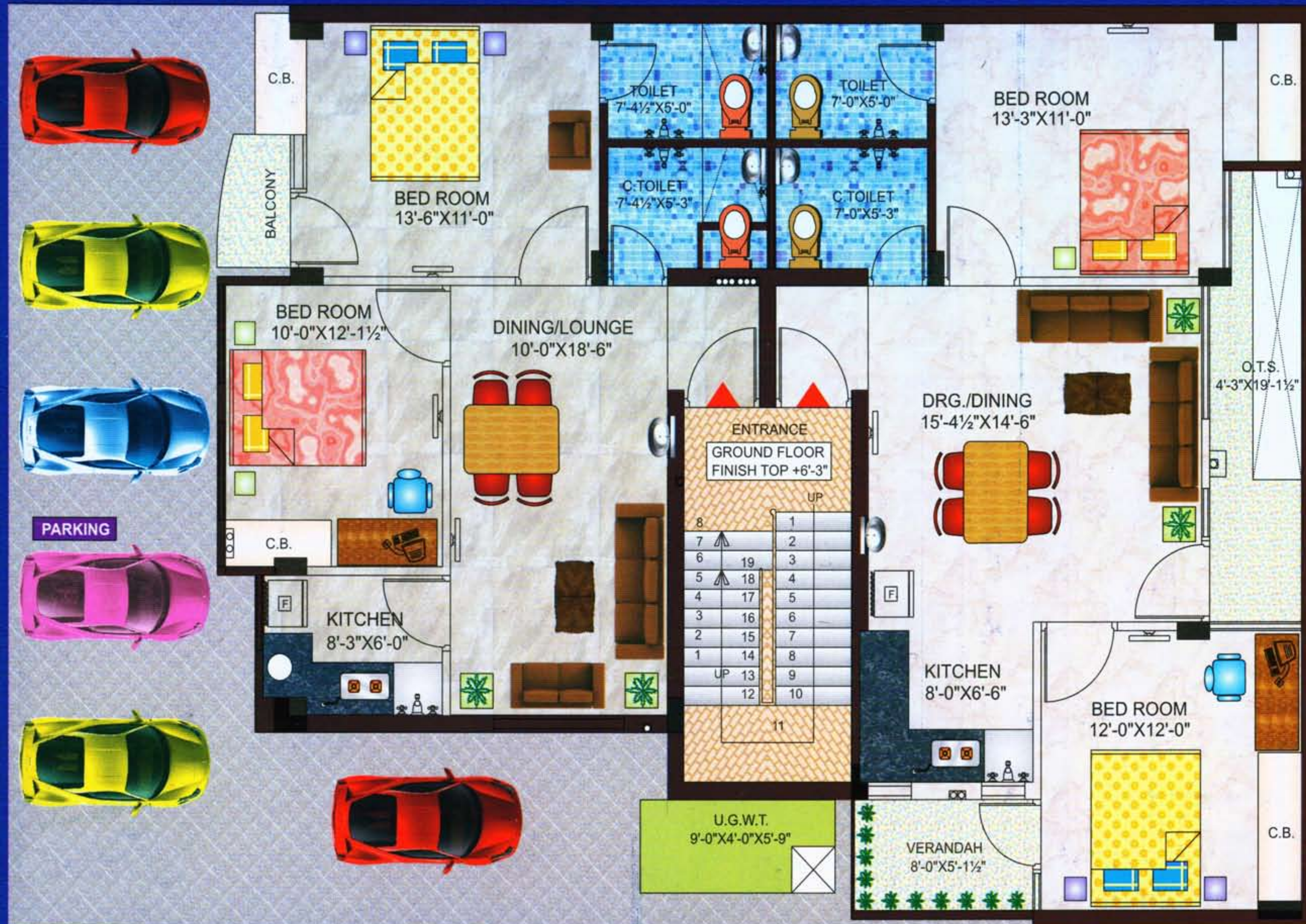

Tulsi Villa





GROUND FLOOR PLAN





TYPICAL FLOOR PLAN



Specification for Residential –

Structure:

- RCC framed structure with seismic zone compliances
- Finish level 10.5ft for each floor

Toilets :

- Glazed tiles dado up to 6' height
- Sanitary of Hindware or adequate brands
- Bathroom fittings of Marc , Jaquar or adequate brands
- Concealed Plumbing

Electricals:

- Electrical copper wiring with Vimal , KEI or adequate brands
- Adequate points with modular switches
- Light fittings in entire apartment
- Fan & Tube light for all rooms

Kitchen:

- Semi modular kitchen
- Granite Platform with sink
- Two feet glazed tiles dado above platform
- Provision for water purifier , Geyser and Exhaust fan point

Special Features

- Steel Railings
- Door and window fittings of brass
- False ceiling in Drawing , Dining and hall
- Distemper of Asian paints or Berger
- Well organized Reserved car parking
- 24 hours securities by well trained security staffs
- After sale service by Builder
- Based on north facing 40ft wide road
- 100% Bank loan available
- 24hrs water supply by own bore well

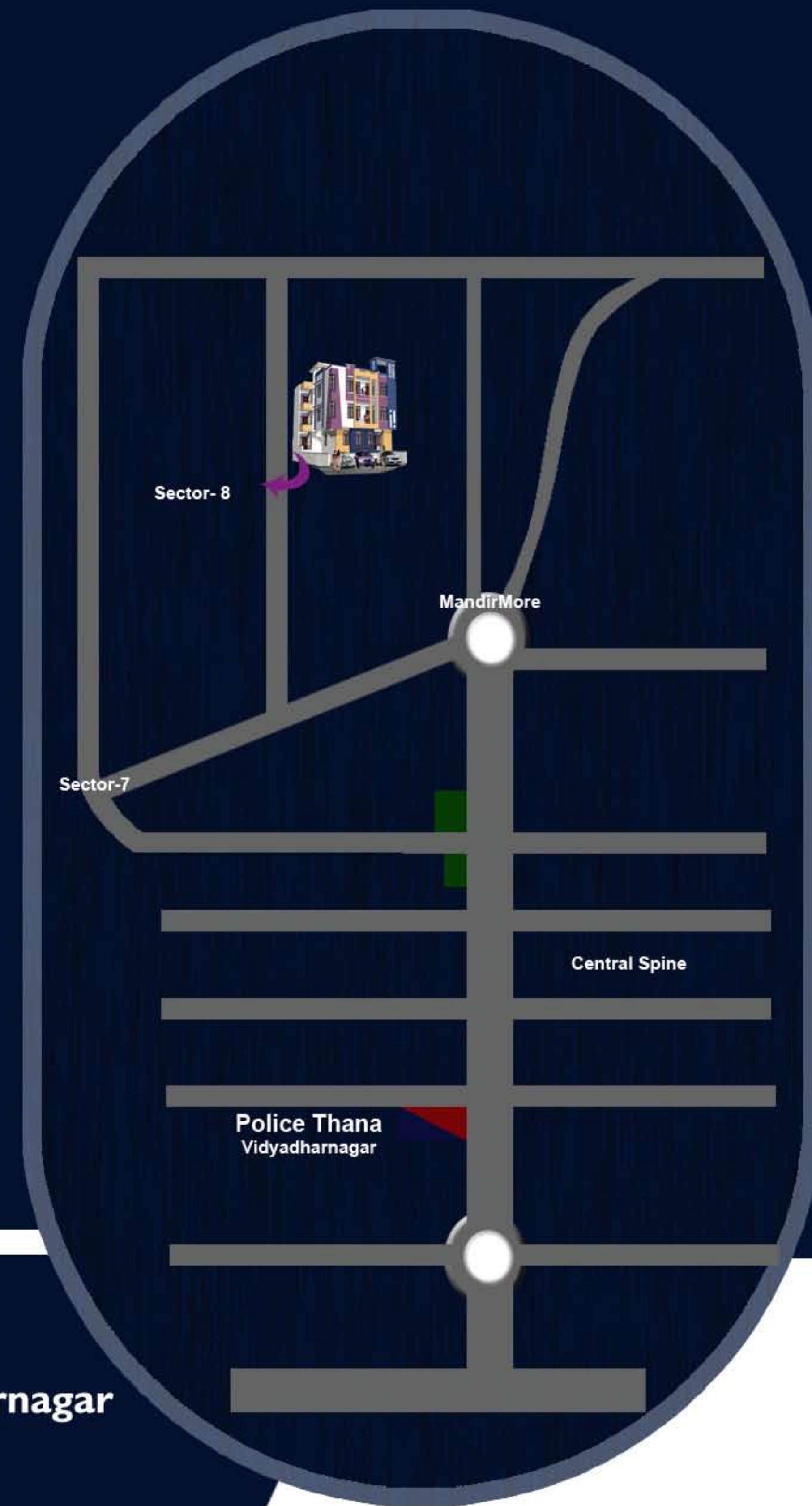

Head office-
APEKSH GROUP
403, Alankar Plaza, Central Spine, Vidyadharnagar

Project Office-
PINKCITY PROPERTY
CineStar , Central Spine , Vidyadhar Nagar, Jaipur
9414042096, 9829013571
E-mail- manoj7771@gmail.com