

KITCHEN

Black granite kitchen platform 20mm thick, stainless steel sink with drain board, 2 feet dado above granite kitchen platform with ceramic glazed tiles. Provision for Aqua guard, Freezer, exhaust fan and washing machine point in kitchen utility.

ELECTRICAL

TV & Telephone points in both the living room and master bed room. Fire resistant 3/20 & 7/20 electrical wires. Elegant modular electrical switches and sockets of anchor make or equivalent. 3KW power for each flat. Standby generator for common areas.

DOORS & WINDOWS

Main door teak wood frame with veneer shutter. All other door frames in non teak wood. Flush doors in bed room with enamel. Toilet doors in water proof shutter. Good quality hardware for all doors. Powder coated aluminum sliding windows with glass, M.S.Grills for windows for all flats, toilet ventilators with translucent glass.

STRUCTURE

RCC framed structure, Concrete solid block masonry external 6" internal 4". Elegant entrance lobbies, Cladding of lift lobbies up to ceiling on the lift side wall, designated car parking on cellar.

TOILET FITTINGS & ACCESSORIES

Ceramic glazed tiles dado upto 7 Feet height in bathroom, wash basin in master bed toilet. White sanitary ware in all toilets of Parryware/Hindustan or equivalent make, Hot and cold water mixer unit of ideal orient/Jaquar or equivalent make for shower in all the toilets. Health faucet for all toilets, concealed master cock from inside. Provision for exhaust fan.

WATER SUPPLY

OHT with sump, 24 hours water supply from BORE WELL'S.

FLOORING

2'x2' vitrified tiles flooring for all the rooms.

Antiskid ceramic tiles flooring for all toilets and balconies.

PLASTERING

Internal walls are smoothly plastered with altek.

LIFT

Two Nos of 6 passenger capacity lift of reputed make with intercom security.

PAINTING

INTERIOR OBD paint,

EXTERIOR Water proof colored cement paint and textured paint selective places.

LOCATION MAP

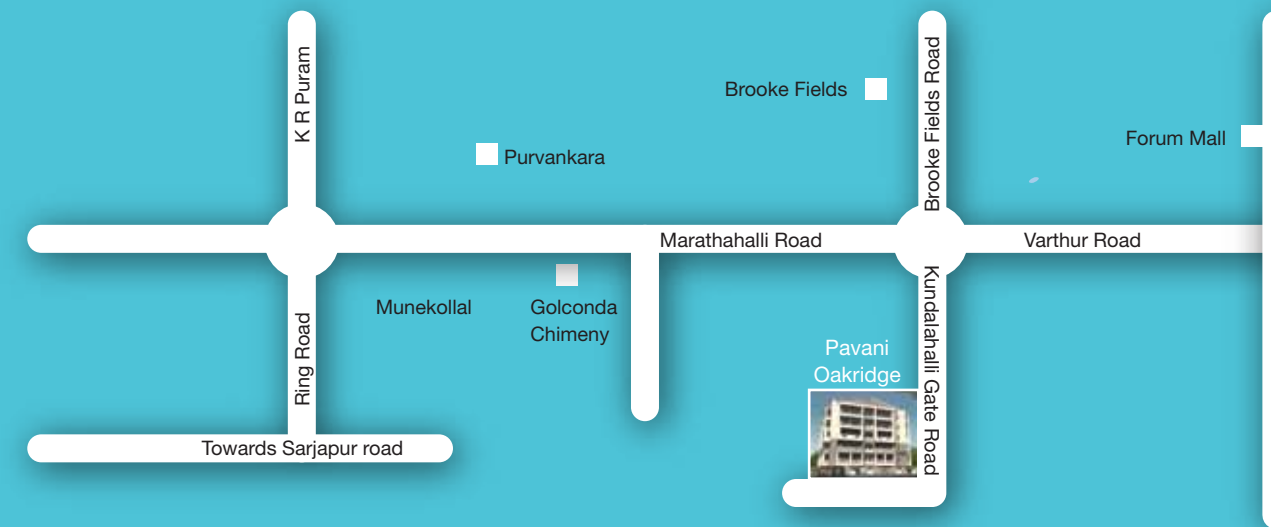

Site Address

PAVANI OAKRIDGE

Sai Baba Temple Street
Green Garden Layout, Kundalahalli Gate
Munekoalala, Bangalore 560 037

PAVANI OAKRIDGE

Let us help you make the decision by
making you feel at home with us



OUR PRESTIGIOUS PROJECTS



Pavani Prestige



Pavani Parkwest



Pavani Chandana

This brochure is truly conceptualized

OUR COMPLETED PROJECTS



Pavani Sankaramangalam



Pavani Marvel



Pavani Fortune

Builders & Developers

SAI SRAVANTHI INFRA PROJECTS (P) ITD

No.201, Ashish Apartment, Inner Circle
Whitefield Main Road,
Bangalore- 560 066

e-mail: sales@pavanihomes.com
wasim@pavanihomes.com

url: www.pavanihomes.com

Mobile: +91 98450 88194
+91 99160 77276

Designed by www.krayons.biz

SAI SRAVANTHI INFRA PROJECTS (P) ITD

No.201, Ashish Apartment, Inner Circle
Whitefield Main Road, Bangalore- 560 066
e-mail: sales@pavanihomes.com
url: www.pavanihomes.com



BANGALORE CHENNAI HYDERABAD NELLORE

TYPICAL FLOOR PLAN

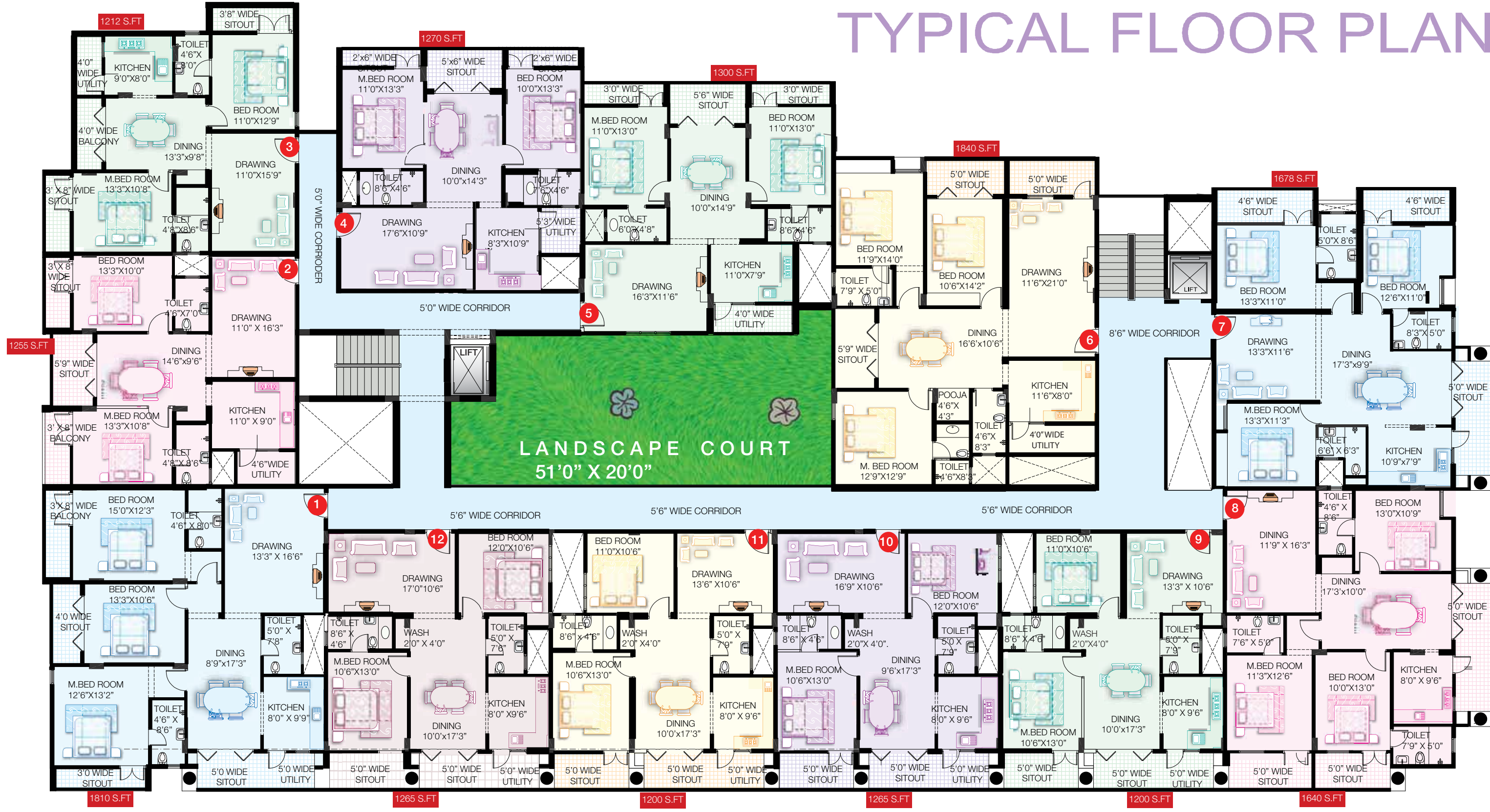

ABOUT US

Owning a house is a long nurtured dream for many. To have a home, you have to own one. The goal of any home is to see that all the elements in the home add to a homely feeling and utilization of space.

Mr. P.V RAGHAVA RAO founded PAVANI GROUP IN 1995 to promote Apartment construction in Nellore town, at a point of time when Apartment Culture was still new there. He thus become pioneers in Apartment Industry within a short span of time. with all his hardwork, foresight and vision the group of companies has completed 35 projects and five projects are in progress and many more in the anvil, spreading all over south India, Viz Hyderabad, Chennai, Nellore and Bangalore.

PAVANI GROUP, backed up by Fifteen years of experience in architectural planning, design and implementation, has come of age, in that, the company has analyzed the demanding choosy requirements of home owners that encompass above parameters and they are determined to a deliver a home tailor made for each owner, snug fitting his or her aesthetics, psychology and ethical Standards. PAVANI GROUP keep in its mind the futuristic requirements. This calls for worldclass specifications and high standards of construction practice. Backed up by highly and experienced Civil

Project Directors with their team of young field engineers, who have completed a number of projects in and around Bangalore, Chennai, Nellore and Hyderabad covering Residential, Commercial Buildings, PAVANI GROUP is never short of concept for timely completion of high quality buildings. While doing so they ensure that they do not end up functional Architectural culdesac.

STRENGTH OF THE COMPANY

- 15 years of hands on experience in construction
- Uncompromising quality
- Exceptional customer care
- Outstanding service after sale
- Inhouse team of professionals, skilled and semiskilled workers
- Sound financial backup and planning
- Dynamic, wellexperienced marketing team
- Established network of banks, liason team, etc.
- Unmatched professional backup of legal advisors, architects, engineers, consultants etc. On panel

CONCLUSION

Over Fifteen years of our experience has made us versatile in the field knowing the exact requirements of customers. Our motto is to give the best possible value for every rupee the customers invest in the house build by us. Pavani Group is an organisation driven by long term vision, its ultimate goal being developing and retaining large number of happy and satisfied customers.



ABOUT PAVANI OAKRIDGE

Lifestyle finds yet another destination in Pavani GROUP, we committed to building world class homes from the very onset, our philosophy has been to build valuefor money with a great locational advantage. We are committed to delighting our customers by exceeding their expectations with their entire Housing experience. In future we shall continue to go ahead and improve on the same vision and mission to guide the company in the years ahead. Pavani GROUP with peaceful surroundings and healthy environment ensure convenient, comfortable and enjoyable living.

AMENITIES

- Gym and Health Club
- Rain water harvesting
- Intercom facility
- Landscaping
- Servants bath/toilet
- Children Play area

