



# SIGMA ICON II



After the completion of famous Sigma Icon, our auspicious project called Sigma Icon II is ready to rule your mind. We have always believed in conquering the odds that make a task seem impervious. A belief reflected in numerous landmarks that stands tall in various prime locations across the city. Because at the Sigma Group of Companies, the vision is to achieve the kind of excellence that makes all our projects timeless. We are specialist to turn your realty dreams in to reality.



# Ground Floor

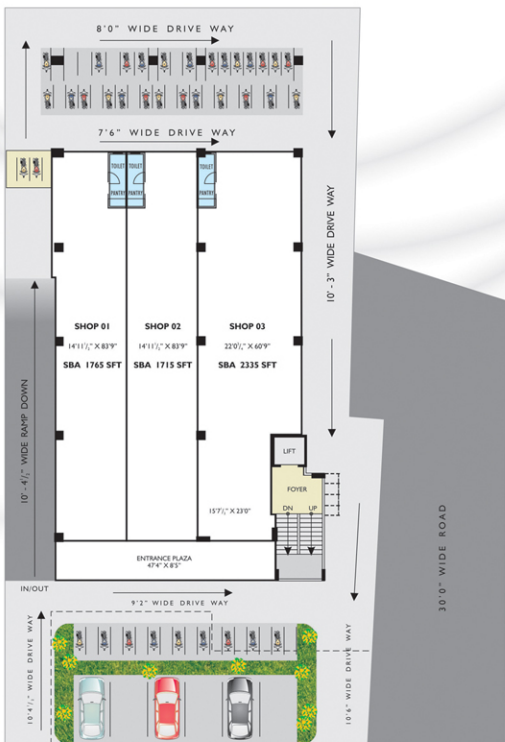

# First Floor

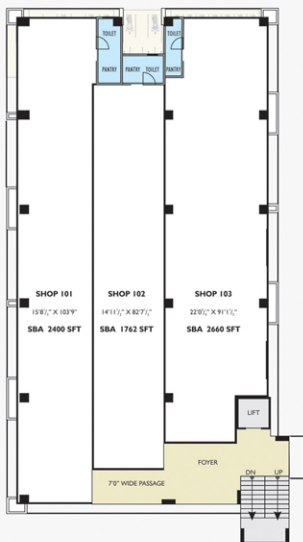

30'0" WIDE ROAD

132' WIDE RING ROAD



# 2<sup>nd</sup>, 3<sup>rd</sup>, 4<sup>th</sup> Floor

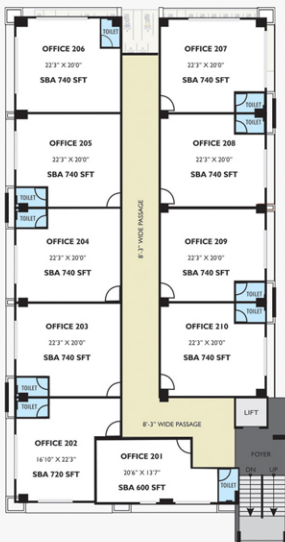

30'0" WIDE ROAD

132' WIDE RING ROAD



# Fifth floor

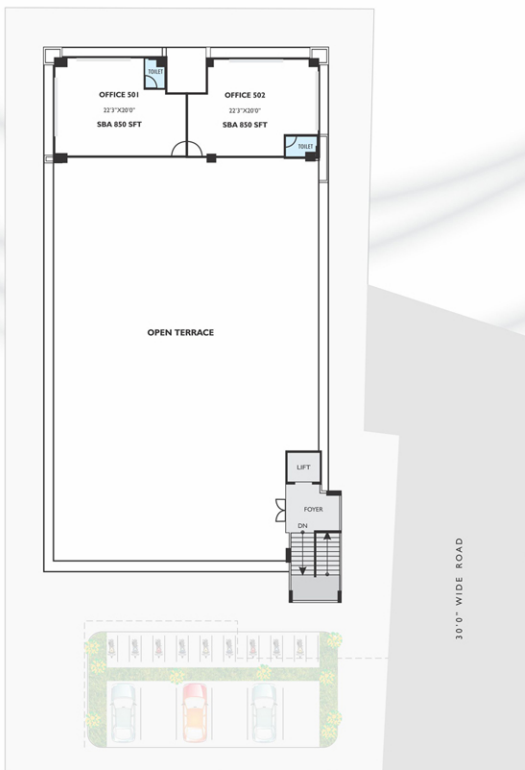

132' WIDE RING ROAD



# Basement

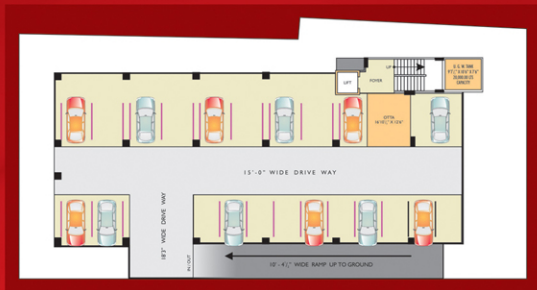

## completed projects:

- SIGMA CORPORATES (Rajpath Club)
- SIGMA II (Drive-In)
- SIGMA EXCELLENCE (Vastrapur)
- SIGMA ICON (132ft. Ring Road)
- SIGMA (V. V. Nagar)

## ongoing projects:

- LEGACY (IIM)
- SIGMA ICON II (132ft. Ring Road, Satellite)
- LIFE CARE (Memnagar)
- GARDEN CORPORATES (Bodakdev)
- SIGMA PRIME (V. V. Nagar)
- SIGMA OASIS (Mehsana)

## upcoming projects:

- SIGMA AT (Maninagar)
- SIGMA ARCADE (Sabarmati)
- SIGMA (Residence @ Sabarmati)
- SIGMA (Residence @ Nikol)
- SIGMA MALL (Baroda)
- SIGMA (Ghodasar)

## SPECIFICATIONS:

- Granamite flooring.
- Adequate electric points including Telephone & A.C. Points.

## SALIENT FEATURES:

- Well paved open & margin area.
- High quality elevator.
- 24 hour water supply with complex's own bore well.
- Allotted car parking.
- Elegant appearance of the building.

## TERMS & CONDITIONS:

- Maintenance, A.E.C., AMC, Stamp duty & other legal charges shall be borne by the members.
- Rights are reserved by the developer to make any changes in plan, elevations and other details which will be binding to all the members.
- In order to maintain the aesthetics of the building at a very high level, sign boards and signages will be allowed to be displayed only at the earmarked location on site, installation of AC units will be permitted at the designated spots and nowhere else, changes which effect the elevation and structure shall not be permitted for all times to come.
- Encroachment, in any form, outside the defined unit shall not be allowed.
- Merchandise, Articles etc. can not be stroked/kept in common areas as defined by the project managers.
- Only internal changes shall be made with prior permission & shall be charged extra in advance.
- All dimensions shown in the plans are approximate average unfinished and subject to variations.



**SIGMA**  
adding values to relation

A - 211, Shivalik Corporate Park, 132' Ring Road,  
Nr. Shyamal Cross Roads, Ahmedabad - 380 015  
Telefax : +91 79 4006 6171  
Mobile : 94266 22228 94266 22227  
E-mail : admin@sigmarealities.com  
Website : www.sigmarealities.com

