

4'6" WIDE CORRIDOR

4'-6"

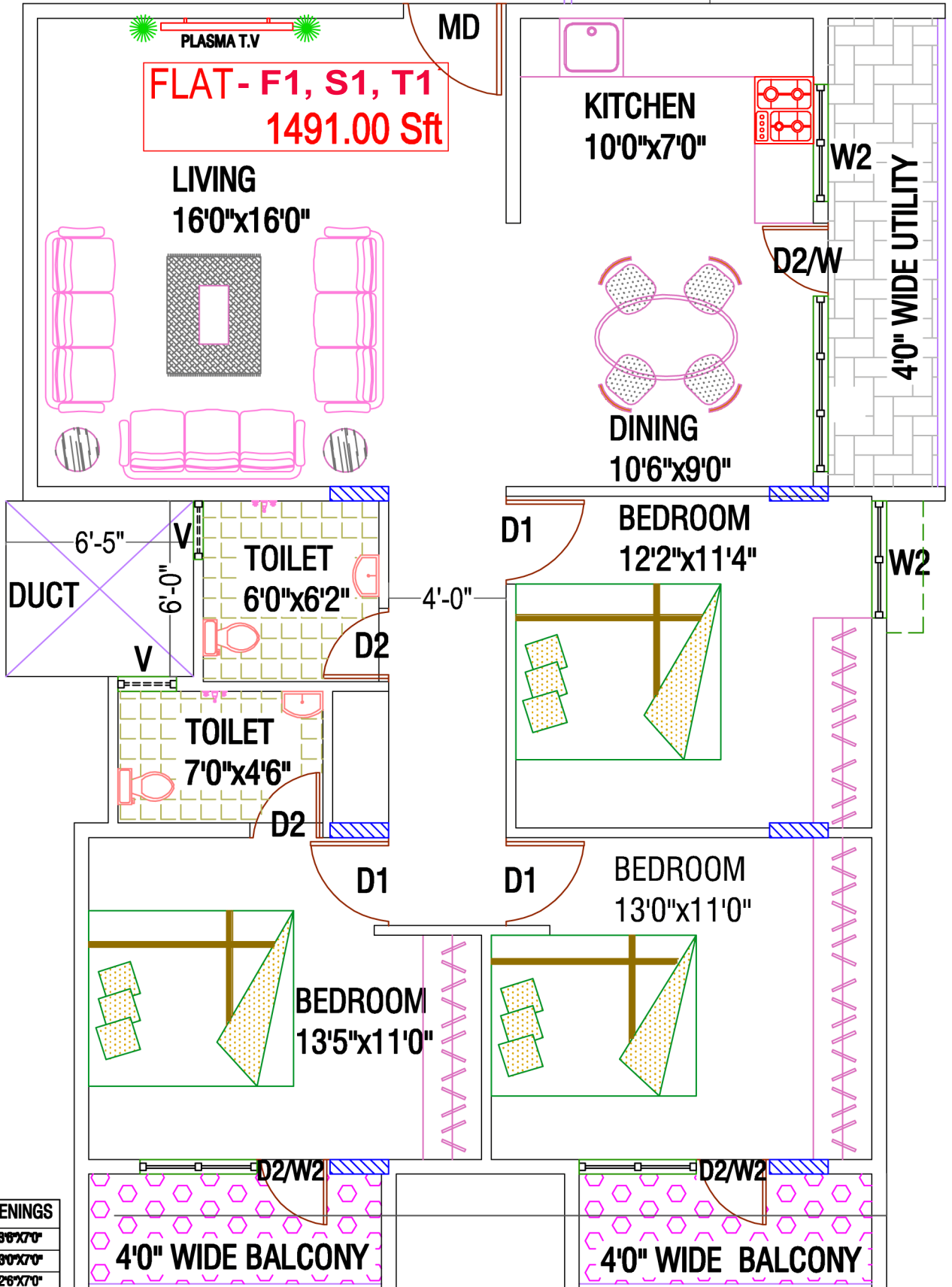

FLAT - F1, S1, T1
1491.00 Sft

LIVING
16'0"x16'0"

KITCHEN
10'0"x7'0"

DINING
10'6"x9'0"

BEDROOM
12'2"x11'4"

BEDROOM
13'5"x11'0"

BEDROOM
13'0"x11'0"

TOILET
6'0"x6'2"

TOILET
7'0"x4'6"

4'0" WIDE BALCONY

4'0" WIDE BALCONY

SCHEDULE OF OPENINGS

DOORS	MD	3'6"x7'0"
	D1	3'0"x7'0"
	D2	2'6"x7'0"
DOOR/WINDOW	D2/W2	2'6"x7'0"/ 4'0"x4'0"
	W	6'0"x5'8"
	W2	4'0"x4'0"
	W4	4'0"x3'0"
VENTILATORS	V	2'0"x2'0"

PROJECT
 PROPOSED RESIDENTIAL APARTMENT
 BUILDING AT SITE NO. 118/1362 -J,
 B.T.M 4TH STAGE,
 2ND BLOCK, BANGALORE.

BUILDER
**SRIVARI INFRASTRUCTURES &
 PROJECTS COY.**
TITLE
 ARCHITECTURAL DRAWING.

DEALT BY : KANTHA
DATE: 15-10-2010
SCALE : N.T.S

CKD BY :

PAPANNA ASSOCIATES
 ARCHITECTS AND ENGINEERS
 NO .142/1 , FIRST FLOOR
 SHIVA COMPLEX,5TH MAIN ROAD,
 CHAMARA,PET,BANGALORE.
 PH NO -080-28607612.
 MOBILE NO -9846898929
 Email:papanna.associates@rediffmail.com