

## 3 Bedroom Apartment / Flat for sale in Pristine Allure, Kharadi, Pune

97 lakhs



★ Featured

### Premium Project In Kharadi

Kharadi, Kharadi, Pune - 411014 (Maharashtra)

- Project/Society: [Pristine Allure](#)
- Area: 1015 SqFeet
- Bedrooms: Three
- Bathrooms: Three
- Floor: Seventh
- Total Floors: Thirteen
- Facing: East
- Furnished: Unfurnished
- Transaction: New Property
- Price: 9,700,000
- Rate: 9,557 per SqFeet <sup>-15%</sup>
- Age Of Construction: Under Construction
- Possession: Within 3 Years

### Description

Positioned at well connected locality Kharadi, Pristine Allure is an aesthetically built project of Pune. Spread over a vast area of 5 Acre, the project is a well-established one. The entire project consists of over 624 residential units.

The Residential complex is equipped with top-of-the-line amenities that are ideal for people of all ages. The project offers Under Construction units. Flat are the various types of units available, each of which has been created to provide total satisfaction. The property units offer a comfortable space, and vary in size. The well-planned site has 8 towers, and each of them have their own plus points. This sought-after project is already commissioned in 01 November 2023. The possession date of this project is 01 December 2027.

When you call, please mention that you saw this ad on PropertyWala.

### Location

\* Location may be approximate

### Locality Reviews

Kharadi, Pune

Kharadi is considered a good investment destination for several reasons. Firstly, it is one of the fastest-growing areas in Pune, with excellent connectivity to major IT hubs like Magarpatta and Kalyani Nagar. Kharadi has seen a steady increase in property prices, driven by the high demand for residential and commercial properties in the area.

#### Pros:

- Infrastructure
- Connectivity
- Price trend

Posted: May 23 by Amit Kumar

One of the promising place to live in. With all the services, malls within 6km radius.

#### Pros:

- Easy connectivity

#### Cons:

- Prices high

Posted: Sep 2, 2020 by Tippy J

Everything is nearby.  
Sophisticated atmosphere.  
Hygienic.

All shopping malls, schools, hospitals, gymnasium, etc everything is nearby.

#### Pros:

- 1) Everything is Nearby.

### Advertiser Details

**Pixel Homes**  
Vikas Uttarwar  
Director

Kharadi, Pune  
mob: 7420852857  
tel:  
mail: help@pixelhomes.net  
www.propertywala.com/pixel-homes

Scan QR code to get the contact info on your mobile

[View all properties by Pixel Homes](#)

### Pictures

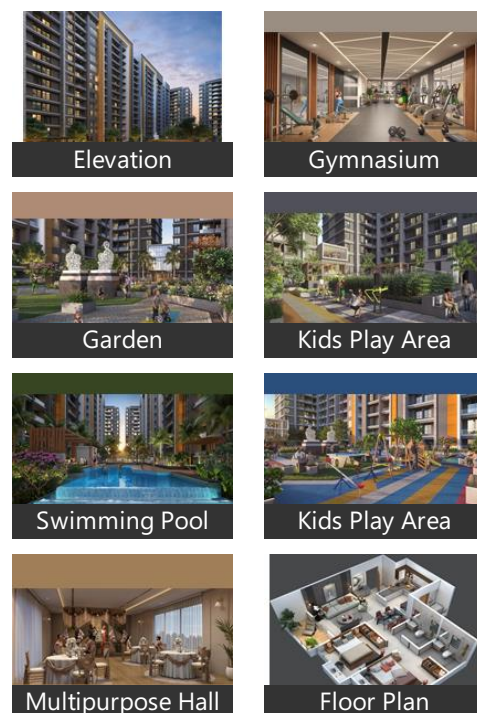

### Project Pictures

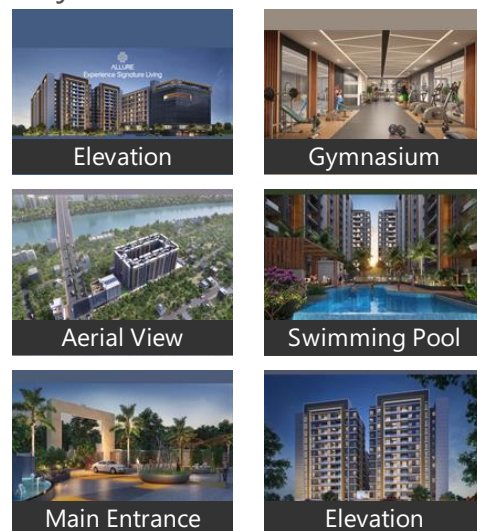

\* These pictures are of the project and might not represent the property

### Project Floor Plans

- 2) Sophisticated atmosphere
- 3) Hygienic

**Cons:**

- NO CONS

Posted: Aug 9, 2020 by Shubham Kaswa

Kharadi is the latest, rapidly developing IT Hub of Pune. It is centrally located in the heart of the city. With EON IT Park, many world renowned businesses are setting up their offices in this location. Property rates in this location are shooting up fast. It is a sought-after locality for IT brands and residential projects are selling at a rapid pace. Kharadi is the hot location for investments and growing businesses.

**Pros:**

- Good connectivity, widest roads
- Malls,hospitals, multiplexes, schools in vicinity

Posted: May 15, 2019 by Sneha Bijlani

One of the fastest growing locality of Pune. Great connectivity to airport, railway station and access to Solapur and Ahmednagar highways. Close to shopping malls and movie theaters

**Pros:**

- Good transport connectivity
- Proximity to offices
- Close to the airport

**Cons:**

- Prices increasing rapidly

Posted: Feb 11, 2019 by Prabal Deb

Kharadih is one of the fastest growing residential and commercial hubs in Pune. With IT hubs and Commercial Malls, every thing from work to fun is within minutes of reach. Several gated communities and vicinity to airport and areas like Koregaon Park, Kalyani nagar and Viman Nagar are an added advantage.

**Pros:**

- Nearer to work places like MIDC, WTC
- Several Malls like Seasons Mall, Amonara Mall, Several Hospitals with emergency care units
- Cultural Diversity

**Cons:**

- The traffic at peak hours is sometimes bad

Posted: Jun 7, 2017 by Abhijit Majumdar

World Trade Center in Kharadi - hub of business in Pune. DP road connecting EON to Wagholi and Surrounding areas.

**Pros:**

- IT Hub
- International Company Presence
- Well developed Infrastructure

Posted: Jul 17, 2014 by [Jennifer A \(Gulmohar Development\)](#)

Good connectivity to EON IT park, distance is just 3.5 kms, and from Nagar road just a 200 m. Also well connected to Kharadi bypass and Magarpatta city.

**Pros:**

- Good connectivity to Eon IT park, Kharadi bypass and also Magarpatta city

Posted: May 4, 2013 by [Sagar sudame \(Pristine Group\)](#)

Kharadi, Pune is rated 8 out of 10 based on 8 user reviews.

Disclaimer: The reviews are opinions of PropertyWala.com members, and not of PropertyWala.com.

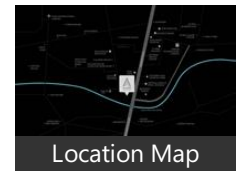
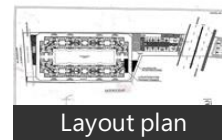

\* These floor plans are of the project and might not represent the property

Explore

- [Similar Properties](#)
- [Properties in Kharadi, Pune](#)
- [Projects in Pune](#)
- [Brokers in Pune](#)

More Information

Report a problem with this listing

Is this property no longer available or has incorrect information?

[Report it!](#)

**Disclaimer:** All information is provided by advertisers and should be verified independently before entering into any transaction. You may visit the relevant RERA website of your state to verify the details of this property. PropertyWala.com is only an advertising platform to help connect buyers and sellers and is not a party to any transactions, nor shall be responsible or liable to resolve any disputes between them.