

3 Bedroom Apartment / Flat for sale in Majestique Codename 39, Kharad.. 1.5 crore

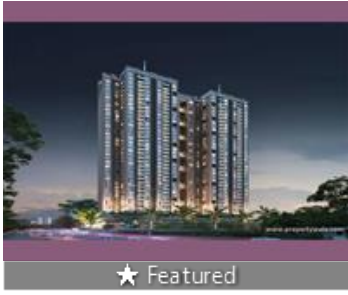

3 Bedroom Apartment For Sale In Kharadi, Pune
Majestique Codename 39, Kharadi, Pune - 411014 (Maha..

- Project/Society: [Majestique Codename 39](#)
- Area: 97 SqMeters ▾
- Bedrooms: Three
- Bathrooms: Three
- Total Floors: More than 20
- Furnished: Unfurnished
- Transaction: New Property
- Price: 15,000,000
- Rate: 1.55 lakh per SqMeter **+25%**
- Age Of Construction: Under Construction
- Possession: Within 3 Years

Advertiser Details

TRESPECT
TRESPECT INDIA
Director

Bandra Kurla Complex, Mumbai
mob: 9999788104
tel:
mail:
ertywala.com/trespect-india-private-limited

Scan QR code to get the contact info on your mobile
[View all properties by TRESPECT INDIA PRIVATE LIMITED](#)

Description

Majestique Codename 39 is located in the heart of Central Kharadi, Pune offers 3 BHK apartments with sizes ranging from 97 sq meters having spread over an area of 10.5 acres of land. The project has 8 buildings with G+5+28 Floors and 700 units to offer. The project aims to provide ample open spaces and lifestyle amenities suitable for all age groups.

RERA ID: A52100008324

Amenities

- Children's Pool
- Play Area
- Banquet Facilities
- Gymnasium
- Yoga Studio
- Swimming Pool
- Wide Roads Entrance
- Gate With 24*7 Security
- Landscaped Garden
- Shop & Grocery
- Stilt Parking
- Open Parking

When you call, please mention that you saw this ad on PropertyWala.com.

Features

General

- Power Back-up
- Centrally Air Conditioned
- Lifts
- High Speed Internet
- Wi-Fi

Lot

- Balcony
- Corner Location

Exterior

- Reserved Parking
- Visitor Parking

Maintenance

- Maintenance Staff
- Water Supply / Storage
- Rain Water Harvesting
- Waste Disposal

Location

Security

- Security Guards
- Electronic Security
- Intercom Facility

Interior

- Woodwork
- Modular Kitchen
- Marble Flooring
- Granite Flooring
- Wooden Flooring
- Fly Proofing
- Feng Shui / Vaastu Compliant

Recreation

- Swimming Pool
- Park
- Fitness Centre / GYM
- Club / Community Center

Pictures

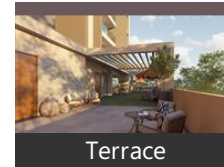

Floor Plans



Project Pictures



* Location may be approximate

Landmarks

Public Transport

Pathare Wasti (<0.5km), Balaji Palace (<0.5km)

Hospitals & Clinics

Sai Clinic (<0.5km), Anant Clinic (<0.5km), Varada Clinic (<0.5km), Cocoon Fertility (<0.5km), Arya Clinic (<0.5km), The Skin Clinic (<0.5km), Swastha Clinic & Day Care Centre (<... DR. Agarawal Dental Clinic (<0.5km), Shalaka Smile Design & Dental Impla.. Dr. Gopal Jaju (<0.5km), Dhantwari Clinic (<0.5km), Rising Medicare Hospital (<1km), Rising Medicare Hospital-ER (<1km), Dr Choudhari Iqbal Clinic (<1km), Mamta Maternity Heart & Diabetes C.. Mamta Maternity Heart & Diabetes C.. Mamta Maternity and Heart and Diab. Mamta Maternity and Hart Daybetic.. Sultana Homeopathic Clinic (<1km), Dhawade Hospital (<1km), Dhawade Hospital-ER (<1km), Dr. Swati, Healthy Tails Pet Clinic (<1km), Thyrocare (<1km), Nihareeka Ayurveda Clinic & Pancha.. Tukaai Multispeciality Hospital (<1km Tukaai Multispeciality Hospital-ER (<.. Ayusanjivani Ayurveda Clinic (<1km), Dr. Dhavde Chinik (<1km), Jeevanrekha Clinic (<1km), Chavde Hospital (<1km)

Hostel

P G Cotbasis Hostel (<0.5km)

ATM/Bank/Exchange

Ibdi Bank (<0.5km), Bank of India (<0.5km), Bank of Maharashtra (<1km), Sai Perna Co-Operative Credit Socie... Kotak Mahindra Bank (<1km), HDFC Bank (<1km), Baramati Sahakari Bank-Thube Naga... Union Bank of India (<1km), Axis Bank-Kharadi (<1km), Saraswat Bank (<1km), The Muslim Cooperative Bank-Khara..

Restaurant & Shops

[more...](#)

Locality Reviews

Kharadi, Pune

One of the promising place to live in. With all the services, malls within 6km radius.

Pros:

- *Easy connectivity*

Cons:

- *Prices high*

Posted: Sep 2, 2020 by Topsy J

Everything is nearby.

Sophisticated atmosphere.

Hygienic.

All shopping malls,schools, hospitals, gymnasium,etc everything is nearby.

Pros:

- *1) Everything is Nearby.*
- *2) Sophisticated atmosphere*
- *3) Hygienic*

Cons:

- *NO CONS*

Posted: Aug 9, 2020 by Shubham Kaswa

Kharadi is the latest, rapidly developing IT Hub of Pune. It is centrally located in the heart of the city.

With EON IT Park, many world renowned businesses are setting up their offices in this location.

Property rates in this location are shooting up fast. It is a sought-after locality for IT brands and residential projects are selling at a rapid pace. Kharadi is the hot location for investments and growing businesses.

Pros:

- *Good connectivity, widest roads*
- *Malls,hospitals, multiplexes, schools in vicinity*

Posted: May 15, 2019 by Sneha Bijlani

One of the fastest growing locality of Pune. Great connectivity to airport, railway station and access to Solapur and Ahmednagar highways. Close to shopping malls and movie theaters

Pros:

- *Good transport connectivity*
- *Proximity to offices*
- *Close to the airport*

Cons:

- *Prices increasing rapidly*

Posted: Feb 11, 2019 by Prabal Deb

Kharadih is one of the fastest growing residential and commercial hubs in Pune. With IT hubs and Commercial Malls, every thing from work to fun is within minutes of reach. Several gated communities and vicinity to airport and areas like Koregaon Park, Kalyani nagar and Viman Nagar are an added advantage.

Pros:

- *Nearer to work places like MIDC, WTC*
- *Several Malls like Seasons Mall, Amonara Mall, Several Hospitals with emergency care units*
- *Cultural Diversity*

Cons:

- *The traffic at peak hours is sometimes bad*

Posted: Jun 7, 2017 by Abhijit Majumdar



Swimming Pool



Night View

* These pictures are of the project and might not represent the property

Project Floor Plans



Floor Plan-A



Floor Plan-B



Location Map

* These floor plans are of the project and might not represent the property

World Trade Center in Kharadi - hub of business in Pune. DP road connecting EON to Wagholi and Surrounding areas.

Pros:

- *IT Hub*
- *International Company Presence*
- *Well developed Infrastructure*

Posted: Jul 17, 2014 by [Jennifer A \(Gulmohar Development\)](#)

Good connectivity to EON IT park, distance is just 3.5 kms, and from Nagar road just a 200 m. Also well connected to Kharadi bypass and Magarpatta city.

Pros:

- *Good connectivity to Eon IT park, Kharadi bypass and also Magarpatta city*

Posted: May 4, 2013 by [Sagar sudame \(Pristine Group\)](#)

Kharadi, Pune is rated 8 out of 10 based on 7 user reviews.

Disclaimer: The reviews are opinions of PropertyWala.com members, and not of PropertyWala.com.

Explore

[Similar Properties](#)

[Properties in Kharadi, Pune](#)

[Projects in Pune](#)

[Brokers in Pune](#)

More Information

Report a problem with this listing

Is this property no longer available or has incorrect information?

[Report it!](#)

Disclaimer: All information is provided by advertisers and should be verified independently before entering into any transaction. You may visit the relevant RERA website of your state to verify the details of this property. PropertyWala.com is only an advertising platform to help connect buyers and sellers and is not a party to any transactions, nor shall be responsible or liable to resolve any disputes between them.