

4 Bedroom Apartment / Flat for sale in CRC Sublimis, Noida Extension, G... 1.85 crore



Sometimes A Perfect Story Needs A Perfect Space To Live In

CRC Sublimis By CRC Homes Pvt Ltd Noida Extension, Gr..

- Project/Society: [CRC Sublimis](#)
- Area: 1775 SqFeet ▾
- Bathrooms: Four
- Total Floors: Twenty
- Furnished: Furnished
- Price: 18,545,000
- Rate: 10,448 per SqFeet **+65%**
- Age Of Construction: 1 Years
- Possession: Immediate/Ready to move
- Bedrooms: Four
- Floor: Second
- Facing: North East
- Transaction: New Property

**Description**

Sometimes a perfect story needs a perfect space to live in, and Sublimis is the perfect place to create a wonderful story of life. This project is a fine example of opulent living. Sublimis is all about living a life of peace and tranquility, surrounded with modern-day amenities and features. This magnificent project reflects fineness in every detail.

Strategically located in Sector 1, Greater Noida West, the homes in Sublimis are not just built, but are judiciously fashioned with a vision that is larger than life. Designed by renowned architect Hafeez Contractor, the project is perfect for individuals want to live a life of comfort and opulence.

So, if you have a desire to write the story of your life in a place that inspires your imagination, Sublimis is the perfect place to be. A place you will not trade for anything in the world!

Don't forget to mention that you saw this ad on PropertyWala.com, when you call.

**Location**

\* Location may be approximate

**Landmarks**

Nearby Localities

[Sector 1](#), [Tech Zone 4](#), [Sector 2](#), [Bisrakh](#), [Aimnabad](#), [Jalpura Village](#), [Sector 12](#), [Ecotech XII](#), [Ecotech XI](#)

\* All distances are approximate

**Locality Reviews**

Noida Extension, Greater Noida

Hotcake location to be developed. Noida Extension is a planned city as per authority and the Parichowk to jewar connector starts from the noida extension. near Delhi and the expressway.

**Pros:**

- Affordable luxurious
- Gated Community

**Cons:**

- Developing area

Posted: Jun 13 by Veena Mahour

Noida extantion is good location near noida , ghaziabad ,greater noida and Delhi. Now noida extantion is very low rent .and resale price so this location attract investment customer. Now ready metro project. Noida extantion safe for human life.with abroad road ,near market all facilities available.all building

**Advertiser Details**

Scan QR code to get the contact info on your mobile  
[View all properties by FAV Consulting Services](#)

**Pictures**

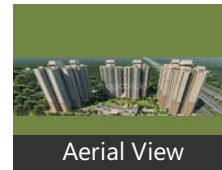

**Project Pictures**

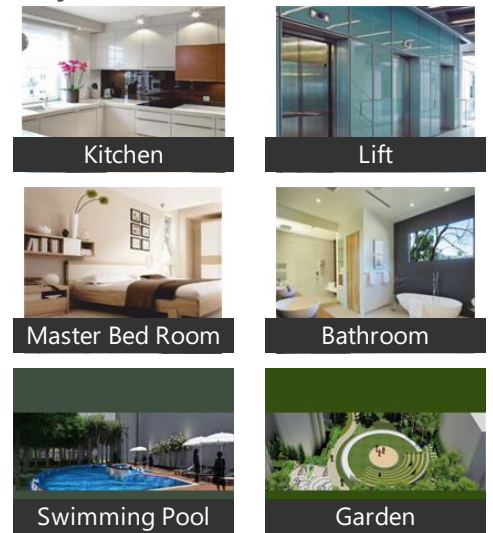

\* These pictures are of the project and might not represent the property

**Project Floor Plans**

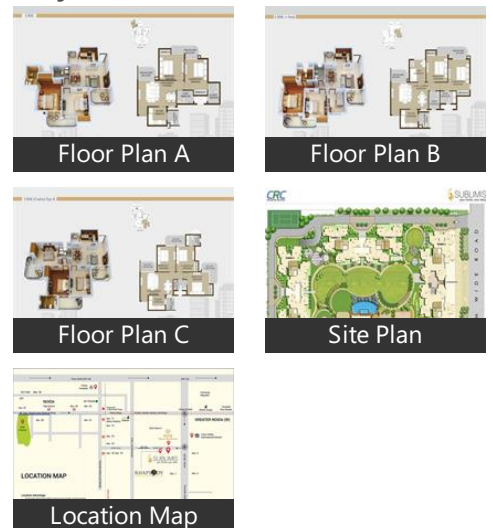

\* These floor plans are of the project and might not represent the property

approved by RERA. and development by authority. So noida extantion is very excellent .

**Pros:**

- All amenities available
- Road
- Water

**Cons:**

- Slow working
- Many work under construction
- Other

Posted: Jan 6, 2020 by [Mr. D. Tomar \(Tomar Rent Property\)](#)

Noida Extn is one of the most prominent location of Greater Noida. It touches the Noida & Ghaziabad and centrally located from Gr.Noida,Noida,GZb. It also in close proximity of Delhi. If anyone wants good affordable property options near Delhi/ Noida then Noida Extn would be excellent option to own a newly constructed property option

**Pros:**

- Affordable
- Centrally located
- New construction

**Cons:**

- High Density
- Future Traffic congession
- Delayed projects

Posted: Jul 25, 2019 by [Xpert Homez \(Xpert Homez\)](#)

Noida Extension is a prime realty hub spot for investors and buyers. This location boasts of numerous advantages like schools, institutions, shopping complexes, restaurants. Also, investing in this location is beneficial as it is easily accessible by roads and expressways. Property rate in this location is increasing each passing day. So, go ahead buy a flat in noida extension.

**Pros:**

- Gaur International School Manthan school Ryan Group international school DPS World School Sarvottam

**Cons:**

- No

Posted: Sep 19, 2018 by [Vijay Gupta \(Skylark Group\)](#)

Its a very big area adjoining Noida,Ghaziabad,Greater Noida.In close proximity to Delhi. Sector 62,63 (the corportae hub of Noida) is 10 minutes drive from here.Metro is approved & work is in progress.Several affordable housing projects are there for all the categories of customers

**Pros:**

- low cost
- affordable
- bank approved

Posted: Feb 21, 2017 by [Abhishek S \(Spaces India\)](#)

most planned upcoming residential hub of DELHI NCR with provisions of all leading brands

**Pros:**

- connectivity
- proximity
- affordablity

**Cons:**

- underconstruction

Posted: Feb 9, 2017 by Abhishek Shankar

Noida Extension is ideal organized location to stay, away from dust and pollution.

**Pros:**

- Located Opposite to Gaur city International School

**Cons:**

- Its not yet fully developed

Posted: Feb 4, 2017 by Rajeev Sinha

Noida Extension going to be the best residential and IT Hub in Delhi NCR. It has access to 2 expressways Eastern Peripheral Expressway and FNG Expressway. More than 3 lakh Flats are in developing phase. Few societies already in possession. Schools like DPS, Saint Jones, Gaur International, Aster public School, Ryan International school etc are already there. Shopping malls, Business Centers, IT Space all are present within one location so it would be beneficial for residents of Noida Extension. Metro is also proposed by 2019 so it would be hot cake for investors in future.

**Pros:**

- Biggest Residential development
- Wide roads
- 50% Green area

**Cons:**

- Farmers Dispute

Posted: May 9, 2016 by [Anand Prakash \(Propright Infra Services\)](#)

Noida Extension having great builder background with school, commercial space, hospital etc

**Pros:**

- All amenities available

Posted: Apr 25, 2016 by [Manish bansal \(Capital Estate\)](#)

Noida Extension is the most sought after both for residential and commercial purpose, with many

residential apartment flats and malls at this location and due to close connectivity from Delhi NCR and due to affordable flats at this location, Noida Extension has high demand. Many apartments now offering Possession soon.

**Pros:**

- *Good connectivity*
- *Well developed*
- *Affordable price*

Posted: Jan 28, 2016 by Ajay Pathak

Noida Extension, Greater Noida is rated 7 out of 10 based on 10 user reviews.

Disclaimer: The reviews are opinions of PropertyWala.com members, and not of PropertyWala.com.

Explore

[Similar Properties](#)

[Properties in Noida Extension, Greater Noida](#)

[Projects in Greater Noida](#)

[Brokers in Greater Noida](#)

More Information

Report a problem with this listing

Is this property no longer available or has incorrect information?

[Report it!](#)

**Disclaimer:** All information is provided by advertisers and should be verified independently before entering into any transaction. You may visit the relevant RERA website of your state to verify the details of this property. PropertyWala.com is only an advertising platform to help connect buyers and sellers and is not a party to any transactions, nor shall be responsible or liable to resolve any disputes between them.