

Apple a Day Hill Palace Phase I - Tripunithura, ...



Residential Apartments

This project consists Total of 54 flats and 2 pent houses. It is R.C.C. Framed structure. Walls made of super quality hollow blocks. Best quality teak wood front door.

- Project ID : J781190944
- Builder: Apple a Day Properties Pvt. Ltd
- Location: Apple a Day Hill Palace Phase I, Tripunithura, Kochi (Kerala)
- Completion Date: Oct, 2011
- Status: Starting

Description

Apple a Day Properties Pvt. Ltd is a household name in the construction fraternity of Kerala. Through its sheer endeavor to provide its esteemed customers with the very best of property services, the company has soared to the higher echelons of the region's realty sector. Operating under the dynamic and youthful entrepreneurial duo of Mr. Saju Kadavilan and Mr. Rajeev Kumar Cheruvara, the firm functions out of the major coastal tourism hub of Cochin. The organization has accomplished many massive ventures such as marketing 1000 units in 2007-08 and recording a profit of Rs. 250 crore in the same year.

Hill Palace Phase I is the first apartment project by Apple a Day Properties Pvt. Ltd. This project consists Total of 54 flats and 2 pent houses. It is R.C.C. Framed structure. Walls made of super quality hollow blocks. Best quality teak wood front door. Hard wood with paneled shutters for internal doors. Powder coated aluminum windows with grills and glazed shutters. PVC molded doors for toilets. Round the clock water supply through sump and overhead tank. Drinking water from KWA line. Water drawn from borewell for other purposes.

Lifestyle Amenities:

- Generator Backup
- Concealed Copper Wiring
- Ceramic Tiles
- Wooden Frames
- RCC Framed Structure
- Anodised Aluminium Glazing
- Stainless Steel Sink
- Granite Working Top
- Elevators
- Indoor Games
- Round The Clock Manual Security
- Health Club
- Indoor Games
- Watchman's Room
- Driver's Room
- Guest Room
- Auditorium

Features

Luxury Features

- Power Back-up ■ Lifts

Lot Features

- Balcony ■ Corner Location

Exterior Features

- Reserved Parking

Maintenance

- Water Supply / Storage

Security Features

- Security Guards ■ Electronic Security

Interior Features

- Modular Kitchen ■ Feng Shui / Vaastu Compliant

Recreation

- Swimming Pool ■ Park ■ Fitness Centre / GYM
- Club / Community Center

Land Features

- Clear Title ■ Freehold Land ■ Plot Boundary Wall
- Society Boundary Wall ■ Corner Plot
- Feng Shui / Vaastu Compliant
- Club / Community Center ■ Adjacent to Main Road
- Water Connection ■ Electric Connection
- Close to Hospital ■ Close to School
- Close to Shopping Center/Mall

Other features

- Society Name: Apple Hilpalace Apartment
- Transaction: Resale Property ■ Possession: Immediate
- Ownership: Freehold
- Age of Property: Less than 5 Years

Gallery

Pictures



Elevation

Floor Plans



Location Map

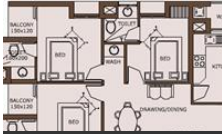

Floor Plan-1



Floor Plan-2



Floor Plan-3



Floor Plan-4



Floor Plan-5



Floor Plan-6

Location

Landmarks

Transportation

Seaport-Airport Highway (<2km), Seaport To Airport Road (<11km), Seaport-Airport Road (<12km), Old Domestic Cochin Airport Termin... Old Airport Ramp Equipment Parking. Kochi Airport (<14km), Kochi Old Airport (<15km), Cok Cochin Airport (<15km), Nedstar Airport Hotel (<15km), Seaport Airport Road (Starting) (<17k.. Proposed Bus Terminal By Muncipal... Kannankulangara Bus Stop (<3km), Bus Terminal Tripunithura (<4km), Tripunithura Pvt.Bus Stand (<4km), Mgps Bus Shed (<4km), Ambadimala Bus Stop (<4km), Pottayil Bus Stop[(<5km), Pisharikovil Bus Stop (<5km), Tpra Railway Station (<2km), Tripunithura Railway Station (<2km), Thripunithura Railway Station (<2km.. Railway Yard Is On The Side Of Sea P... Kureekkad Railway Station (<5km), Mulanthuruthy Taxi Stand (<9km), Mqs The Coustomer Not Satisfied Ta...

Markets & Shopping Malls

Unitechs Property For Shopping Mal... Prestiges Plot For Forum Mall (<8km), Proposed Site For Fortune Mall (<11k.. Land For Mall And Multiplex (<12km), Anish Memorial Shopping Complex ... Vajra Garments(Shopping Complex) ...

Banks & ATMs

Icici Bank (<2km), Hdfc Bank And Bajaj Allianz .Co.Ltd (.. Peoples Urban Coperative Bank (<3k... Canara Bank (<3km), State Bank Of Travancore (<3km), Punjab National Bank (<3km), Federal Bank (<4km), Joseph V Bobby (<4km), Peoples Urban Cooperative Bank (<6... Icici Atm (<8km), Federal Bank (<8km), The Dhanalakshmi Bank Ltd With Atm Federal Bank And Atm (<10km), Atm Gardens (<11km), Tranquil Towers (<12km), Icici Bank Atm (<12km)

Hotels & Guest Houses

Hotel Food Palace (<1km), Hotel Hill Palace (<2km), Shaju Joseph (<2km), Hotel Zenana (<2km), Kunjunni Nair Hotel (<4km), Bharath Cafe Hotel (<4km), Sukus Hotel (<4km), Sass Complex: Mummys Hotel (<4k... Amritha Hotel (<5km), Guest House (<14km), Cumi Guest House (<18km)

Movie Halls

Class Xii A Cinema Theatre (<4km)

Restaurants & Clubs

Cooks In Restaurant (<2km), Green Land Drive In Restaurant And I... Ayyappas Brahmins Restaurant (<5km
Love Land Bar And Restaurant Chott... The Club (<2km), Souzcricket Club Chithrapuzha (<2km
Tripunithura Cricket Club (<4km), Classic Club (<4km), Boat Club (<5km), Ambika Arts Club (<5km),
Arjuns Sports Club (<5km), Cochin Refineries Club (Crc) (<6km), Lovedale Family Club (<6km)

Hospitals & Clinics

Esi Hospital Hill Palace Museum (<1k.. Rakesh Hospital Rcm Eye (<3km), Rcm Hospital (<3km),
Govt. Hospital Tripunithura (<4km), Lakshmi Hospital (<4km), Gov.Hospital (<4km), Varma Hospital (<4km),
Devi Hospital (<4km), Vkm Hospital (<4km), Op(Govt Ayurveda Hospital) (<4km),
Valiyakulangara Dental Clinic (<3km), Naliath Dr Thomas Dental Clinic (<3k.. Dr Nkkm Dental Clinic (<3km),
Srhomeo Clinic (<3km), Keerthi Clinic (<4km), Dr Rajkrishnans Dental Clinic (<4km)

Offices

Sobbys Office (<2km), Makaliyam Samithi Office (<3km), C K Ramadas Pais Office (<3km),
Irimpanam Post Office (<3km), Tripunithura Post Office (<3km), Tripunithura Municipal Office (<3km..
Tripunithura News Office (<4km), Bjp Tripunithura Office (<4km), B I And Get Cochin Office (<4km),
Rlv College Union Office Sfi (<4km)

Schools & Colleges

Jayaraj.Kalpaka (<1km), Kalagramam School Of Arts (<2km), St George School Karingachira (<2km.
Irimpanam School (<2km), High School Section (<2km), Karingachira Church Lp School (<2km Puthuppillil (<2km),
Sndp School (<2km), Old Entrance To Choice School (<3k... Gardens Choice School (<3km),
Govt.Arts College (<3km), Govt Ayurvedih College Tripunithura.. Mqucte Tripunithura(B.Ed College) (...
Vidyabhavan College (<3km), Sanskrit College (<4km), Victory College (<4km),
Rlv College Of Fine Arts New Buildin... Rlv College Of Finearts Constrn.Site (... Nss Arts College For Women (<4km),
Mgps B.Ed College (<4km)

Parks

Hill Palace Museum And Deer Park (<. Deer Park (<1km), Childrens Park (<1km), Cyber Park (<3km),
Grigary Park (<4km)

* All distances are approximate

Properties

Apple a Day Hill Palace Phase I News

Expert Reviews on Apple a Day Hill Palace Phase I

Explore
[Projects in Kochi](#)
[Brokers in Kochi](#)

More Information

Report a problem with this listing
Is any information on this page outdated or incorrect?
[Report it!](#)

Disclaimer: All information is provided by builders, advertisers, or collected from publicly available sources and may not be verified as per RERA guidelines. Any information provided on this website, including facts and figures, should be verified independently before entering into any transaction. PropertyWala.com is only an advertising platform to help connect buyers and sellers and is not a party to any transaction, nor shall be responsible or liable to resolve any disputes between them.