

## 4 Bedroom Apartment / Flat for sale in Palm Olympia, Noida Extension, G. 1.78 crore

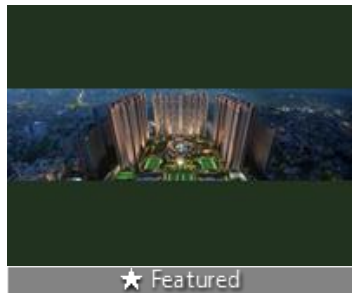

★ Featured

Palm Olympia Located In Noida Extension, Noida Is A Well-Crafted Township. It Has A Number Of Apart

Palm Olympia Phase II By Sam India Abhimanyu Housing..

- Project/Society: [Palm Olympia](#)
- Area: 1890 SqFeet ▾
- Bathrooms: Four
- Total Floors: Twenty
- Furnished: Furnished
- Price: 17,850,000
- Rate: 9,444 per SqFeet **+35%**
- Age Of Construction: Under Construction
- Possession: Immediate/Ready to move
- Bedrooms: Four
- Floor: Second
- Facing: North East
- Transaction: New Property

### Description

Discover an exuberant life of luxury and joy in this elegantly constructed project situated in Noida Extension. Palm Olympia is suitably designed giving you the option of selecting from 2BHK, 3BHK and 4BHK residential apartments. These flats are available for different area sizes as 2BHK covers an area ranging between 883sq.ft. to 1445sq.ft., 3BHK apartment are sized between 1253sq.ft. and 2089sq.ft. while 4BHK residential apartments can be found within the area size of 1906sq.ft. and 2186sq.ft. All the apartments are systematically designed to offer not only panoramic views but to also receive plenty of natural light and fresh air.

Don't forget to mention that you saw this ad on PropertyWala.com, when you call.

### Features

#### Private Amenities

- Air Conditioning
- Balcony
- Basement
- Home Automation
- Private Garage
- Private Garden
- Private Lift
- Private Terrace
- Reserved Parking
- RO System
- Servant Room

#### Shared Amenities

- Visitor Parking
- Power Back-up
- Maintenance Staff
- Water Supply / Storage
- Water Softner
- Rain Water Harvesting
- Waste Disposal

#### Security

- Biometric Access
- CCTV
- Fire Alarm
- Intercom
- Security Guards
- Corner Location
- Near Metro

#### Interior

- Woodwork
- Modular Kitchen
- Marble Flooring
- Granite Flooring
- Wooden Flooring
- Vaastu Compliant

#### Recreation

- Swimming Pool
- Park
- Fitness Centre / Gym
- Club / Community Center

#### Location

- Corner Location
- Near Metro

### Location

\* Location may be approximate

### Landmarks

#### Restaurants & Cafes

- Green Chick Shop (<0.5km)
- Pizza King (<0.5km)
- Licious Bite (<0.5km)
- Zaika Kathi Rolls (<0.5km)
- The Taste (<0.5km)
- Doons Vaishno (<0.5km)
- Punjabi Chaska (<0.5km)
- Waha Kya Dosa He (<0.5km)

### Advertiser Details

**FAV Consulting Services**  
**Shweta Mishra**  
Agent

Sector 1, Noida  
mob: 7053593369  
tel: +91-124-4249600  
mail: maira.vatika2014@gmail.com  
propertywala.com/fav-consulting-services



Scan QR code to get the contact info on your mobile  
[View all properties by FAV Consulting Services](#)

### Pictures

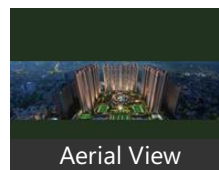

Aerial View

### Project Pictures

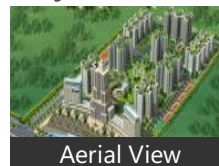

Aerial View

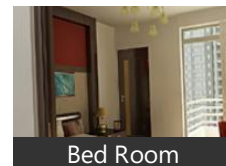

Bed Room

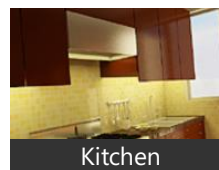

Kitchen

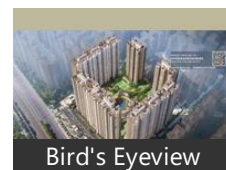

Bird's Eyeview



Aerial View

\* These pictures are of the project and might not represent the property

### Project Floor Plans

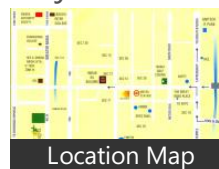

Location Map



Floor Plan-1

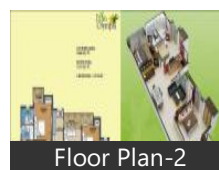

Floor Plan-2

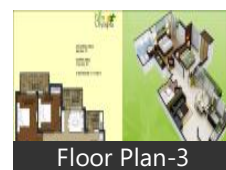

Floor Plan-3

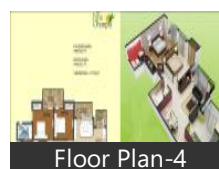

Floor Plan-4

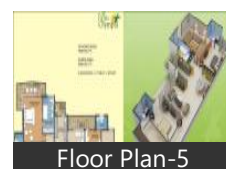

Floor Plan-5

\* These floor plans are of the project and might not represent the property

Anna South Indian Restaurant (<0.5km... Asmis Mughlai Kitchen (<0.5km) Lucknawi Rasoi (<0.5km)  
A Square Cakes & Cupcakes (<0.5km) Superb Cake (<0.5km) Food From Home (<1km) Chops & Slices (<1km)  
Dilkash Rasoi (<1km) Neeraj Fast Food (<1km) Chinese Sabor (<1km) Maa Sweets & Restaurant (<1km)  
Sahukara Restaurant (<1km) Punjabi Tadka (<1km) Lazeez Kolkata Kathi (<1km) Pari Baker's (<1km)  
The Asian Kitchen (<1km) Brajwasi Restaurant (<1km) Hunger Point (<1km)

Hospitals & Healthcare

Dr Saurabh Gupta Clinic (<0.5km) Pahel Mother And Child Clinic (<0.5k.. Breeze Dental Hub (<0.5km)  
A.K. Optical (<0.5km) Dentarch Solutions (<0.5km) Apollo Diagnostics (<0.5km)  
Meraki Homeopathy Clinic (<0.5km) S R L Diagnostics (<0.5km) Dr Nishit Palo Clinic (<0.5km)  
16th Dental Avenue (<0.5km) Dr S S Chandel - Orthopaedic Surgeo... Rudra Fracture Hospital & Diagnostic..  
Jeevan Anand Family Clinic (<0.5km) Thyrocare Lab (<0.5km) Sai Shila Dental Clinic (<0.5km)  
Nikhils Physioup Physiotherapy Clini... Thyrocare (<0.5km) SRL Diagnostics (<0.5km) Max Lab (<0.5km)  
Dr. Gaurav Gupta Clinic (<0.5km) Dr Plus Pharmacy (<0.5km) Sai Physiotherapy Clinic (<1km)  
Charak Ayush Clinic (<1km) Dr. Agarwal Homeoclinics (<1km) Care Home Nursing Attendant (<1km).  
Arhant Homoeopathic Clinic (<1km) Petsmile (<1km) Shashi Wellness Center (<1km)  
Krishna Eye Care and Opticals (<1km) Dr. Ashish Clinic (<1km) Madas Dental Care (<1km)  
Midas Dental Care (<1km) Blossoms Kids Clinic (<1km)

Shopping

Tirupati Bala Ji Supermarket (<0.5km) Eco Village Market (<0.5km) Supertech Ecobazar I (<0.5km)  
Aarav Megha Mart (<1km) Shri Radhey Super Store (<1km)

[more...](#)

Locality Reviews

Noida Extension, Greater Noida

Hotcake location to be developed. Noida Extension is a planned city as per authority and the Parichowk to jewar connector starts from the noida extension. near Delhi and the expressway.

Pros:

- Affordable luxurious
- Gated Community

Cons:

- Developing area

Posted: Jun 13, 2024 by Veena Mahour

Noida extantion is good location near noida , ghaziabad ,greater noida and Delhi. Now noida extantion is very low rent .and resale price so this location attract investment customer. Now ready metro project. Noida extantion safe for human life.with abroad road ,near market all facilities available.all building approved by RERA. and development by authority. So noida extantion is very excellent .

Pros:

- All amenities available
- Road
- Water

Cons:

- Slow working
- Many work under construction
- Other

Posted: Jan 6, 2020 by [Mr. D. Tomar \(Tomar Rent Property\)](#)

Noida Extn is one of the most prominent location of Greater Noida. It touches the Noida & Ghaziabad and centrally located from Gr.Noida,Noida,GZb. It also in close proximity of Delhi. If anyone wants good affordable property options near Delhi/ Noida then Noida Extn would be excellent option to own a newly constructed property option

Pros:

- Affordable
- Centrally located
- New construction

Cons:

- High Density
- Future Traffic congeseation
- Delayed projects

Posted: Jul 25, 2019 by [Xpert Homez \(Xpert Homez\)](#)

Noida Extension is a prime realty hub spot for investors and buyers. This location boasts of numerous advantages like schools, institutions, shopping complexes, restaurants. Also, investing in this location is beneficial as it is easily accessible by roads and expressways. Property rate in this location is increasing each passing day. So, go ahead buy a flat in noida extension.

Pros:

- Gaur International School Manthan school Ryan Group international school DPS World School Sarvottam

Cons:

- No

Posted: Sep 19, 2018 by [Vijay Gupta \(Skylark Group\)](#)

Its a very big area adjoining Noida,Ghaziabad,Greater Noida.In close proximity to Delhi. Sector 62,63 (the corpotaie hub of Noida) is 10 minutes drive from here.Metro is approved & work is in progress.Several affordable housing projects are there for all the categories of customers

Pros:

- low cost
- affordable
- bank approved

Posted: Feb 21, 2017 by [Abhishek S \(Spaces India\)](#)

most planned upcoming residential hub of DELHI NCR with provisions of all leading brands

Pros:

- connectivity

- proximity
- affordability

**Cons:**

- underconstruction

Posted: Feb 9, 2017 by Abhishek Shankar

Noida Extension is ideal organized location to stay, away from dust and pollution.

**Pros:**

- Located Opposite to Gaur city International School

**Cons:**

- Its not yet fully developed

Posted: Feb 4, 2017 by Rajeev Sinha

Noida Extension going to be the best residential and IT Hub in Delhi NCR. It has access to 2 expressways Eastern Peripheral Expressway and FNG Expressway. More than 3 lakh Flats are in developing phase. Few societies already in possession. Schools like DPS, Saint Jones, Gaur International, Aster public School, Ryan International school etc are already there. Shopping malls, Business Centers, IT Space all are present within one location so it would be beneficial for residents of Noida Extension. Metro is also proposed by 2019 so it would be hot cake for investors in future.

**Pros:**

- Biggest Residential development
- Wide roads
- 50% Green area

**Cons:**

- Farmers Dispute

Posted: May 9, 2016 by [Anand Prakash \(Propright Infra Services\)](#)

Noida Extension having great builder background with school, commercial space, hospital etc

**Pros:**

- All amenities available

Posted: Apr 25, 2016 by [Manish bansal \(Capital Estate\)](#)

Noida Extension is the most sought after both for residential and commercial purpose, with many residential apartment flats and malls at this location and due to close connectivity from Delhi NCR and due to affordable flats at this location, Noida Extension has high demand. Many apartments now offering Possession soon.

**Pros:**

- Good connectivity
- Well developed
- Affordable price

Posted: Jan 28, 2016 by Ajay Pathak

Noida Extension, Greater Noida is rated 7 out of 10 based on 10 user reviews.

Disclaimer: The reviews are opinions of PropertyWala.com members, and not of PropertyWala.com.

Explore

[Similar Properties](#)

[Properties in Noida Extension, Greater Noida](#)

[Projects in Greater Noida](#)

[Brokers in Greater Noida](#)

More Information

Report a problem with this listing

Is this property no longer available or has incorrect information?

[Report it!](#)

**Disclaimer:** All information is provided by advertisers and should be verified independently before entering into any transaction. You may visit the relevant RERA website of your state to verify the details of this property. PropertyWala.com is only an advertising platform to help connect buyers and sellers and is not a party to any transactions, nor shall be responsible or liable to resolve any disputes between them.