

## Pristine Meadows - Thirumanahalli, Bangalore



premium residential project

Pristine Meadows by Pristine Homes at Agrahara Badavane, Thirumenhalli in Bangalore offers residential project that host 2 bhk and 3 bhk apartment in various sizes.

- Project ID: J466651189
- Builder: Pristine Homes
- Location: Pristine Meadows, Agrahara Badavane, Thirumanahalli, Bangalore (Karnataka)
- Completion Date: Dec, 2018
- Status: Completed

### Description

**Pristine Meadows** presents 2 BHK and 3 BHK Apartments in Agrahara Badavane, Thirumenhalli, Bangalore in the size ranges in between 1144 to 1733 sqft. The project makes you feel that every day is an excursion. All the world-class amenities such as Multi-purpose Hall, Video Intercom, Walking Track, 24Hrs Water Supply etc. Pristine Meadows is conveniently located at Thanisandra Main Road to provide unmatched connectivity from all the important landmarks and places of everyday utility such as hospitals, schools, super marts, parks, recreational centers etc.

**RERA No :-** PRM/KA/RERA/1251/309/PR/171016/000780

### Amenities:

- CCTV
- Children's play area
- Gymnasium
- Indoor Games
- Jogging Track
- Lift Available
- Power Backup
- Rain Water Harvesting
- Swimming Pool
- Visitor Parking
- Landscaping & Tree Planting
- Water Supply

**Pristine Homes** is a property development company in Bangalore. It is committed to developing projects that are an excellent investment for the present that is bound to bear fruits in the future. It believes in maintaining business ethics and transparency in all the dealings to create an enduring customer base. The firm believes in delivering high-quality construction to the customers to help them realize their dream of owning a home. It ensures that there is no compromise on the quality of its projects.

### Features

#### Luxury Features

- Power Back-up
- Lifts
- High Speed Internet

#### Lot Features

- Balcony

#### Recreation

- Swimming Pool
- Park
- Fitness Centre / GYM
- Club / Community Center

#### Security Features

- Security Guards
- Intercom Facility

#### Exterior Features

- Reserved Parking

#### Maintenance

- Maintenance Staff
- Rain Water Harvesting

### Gallery

#### Pictures



Swimming Pool



Elevation

#### Floor Plans



Master Plan

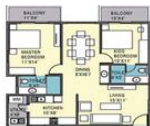

Floor Plan A



Floor Plan B



Floor Plan C



Floor Plan D



Location Map

## Location

## Landmarks

### Building

Orchid Woods (<5km), Sobha Chrysanthemum (<5km), Krishna Northwoods (<2km), Karle Town Centre (<8km), Kemp Fort (<10km), Sobha City ■■■■■ (<2km), SLS Symphony (<7km), Vivek Marvel (<5km), R & S Riviera (<6km), R and S Riviera Bangalore (<6km), Adithya Celestial (<6km), Crystal Enclave (<9km), Supertech Micasa (<2km), Oceanus Greendale (<12km), Eco Narasimha (<11km), DS Max Spring Dale (<9km), Railway Wheel Factory West Colony ... Sobha Petunia (<9km), Manito Shelters (<12km), Nagarjuna Meadows Phase-1 (<9km), Vamshi Residency (<10km), SLS Spencer (<10km), Kalathoor House (<5km), VDB Celadon (<5km), Sobha Emerald-2 (<5km), Bornmann Enclave (<5km)

### Hotel

Royal Orchid Resort & Convention C... Chairman, The Royale Senate-Hebbal (<11km), Roseline Suites (<11km), Godrej Woodsman Estate (<9km), Ramanashree California Resort-Dodd.. Howard Johnson-Nagavara (<8km), Liwa Hotel (<7km), Hotel Nandhana Vista (<13km), The Sanctum Suites Bangalore (<14k... Maple Inn-Kempapura (<8km), Country Inn & Suites By Radisson Be... Howard Johnson by Wyndham Beng... Arra Suites (<10km)

### Recreation

Manyata Embassy Business Park (<6k.. Lumbini Gardens (<9km), PVR Cinemas-MSR Elements Mall (<... Decathlon Sports India (<12km), Hennur Banaswadi Cosmopolitan Cl... Pushpanjali-Sultanpalya (<12km), Mukunda Theatre (<14km), Naatyakalakshetra Academy for Fine... Shri Amruth Chithra Mandira (<13km).

### Public Transport

Yelahanka Railway Station (<6km), Hebbal (<10km), Hebbal Railway Station (<11km), Banaswadi Railway Station (<14km), Nagavara (<9km), Bel Circle (<14km), Bmtc Kalyannagar Bus Station (<10k... Mekhri Circle-NB (<14km), Vishwanath Nagenahalli-EB (<9km), Nagashettyhalli B M T C Bus Station ... Kodigehalli Railway Station (<10km)

### Shopping Centre

MSR Regaliaa Elements Mall (<8km), Esteem Mall (<9km)

### Business & Services

Kirloskar Business Park (<9km), Rail Wheel Factory-Main Gate (<8km... Bharat Electronics-Main Gate ■■■|...

### ATM/Bank/Exchange

City Union Bank-Yelahanka New Tow. State Bank of India (<7km), Canara Bank (<8km), State Bank of India-R A C P C Banasa... Karnataka Bank-Banaswadi (<11km), Bank of Baroda-Defence Colony (<9k... South Indian Bank (<11km), Uco Bank (<9km), Idbi Bank (<13km)

### Restaurant & Shops

Reliance Fresh (<7km), Lulu Value Mart (<5km), Five Star Chicken (<5km), Patels Inn (<12km), Pawan Textiles (<9km), Korea (<10km)

### Hospitals & Clinics

Columbia Asia Hospital-ER (<9km), Dr Ambedkar Medical College Hosp ... Yelahanka Govt Hospital (<6km), MS Ramaiah Memorial Hospital-ER (... Specialist Hospital (<12km), Orthopaedic Clinic (<12km), Sham, Dr B R Ambedkar Medical & Hospita... MS Ramaiah Memorial Hospital (<14.. cloudnine clinic (<8km), DR. Agarwal, M S Ramaiah Medical Hosp (<14km), Dr Lal PathLabs (<9km), Banaswadi Hospital (<11km), Manipal Ankur (<9km), Chaya Hospital (<13km), M S Ramaiah Hospital (<14km), Chaitanya Hospital (<12km)

### Accommodation

Club Cabana (<9km)

\* All distances are approximate

Properties

Pristine Meadows News

Expert Reviews on Pristine Meadows

Explore

[Projects in Bangalore](#)

[Brokers in Bangalore](#)

More Information

Report a problem with this listing

Is any information on this page outdated or incorrect?

[Report it!](#)

**Disclaimer:** All information is provided by advertisers, including builders/agents/owners, or collected from publicly available sources and may not be verified under RERA. Any information provided on this website, including facts and figures, should be verified independently, including via the relevant RERA website, before entering into any transaction. PropertyWala.com is only an advertising platform to help connect buyers and sellers and is not a party to any transaction, nor shall be responsible or liable to resolve any disputes between them.

[Home](#) » [Bangalore Real Estate](#) » [Projects in Bangalore](#) » [Pristine Meadows - Thirumanahalli, Bangalore](#)