

# 4 Bedroom Apartment / Flat for sale in Palm Olympia, Noida Extension, G. 1.85 crore

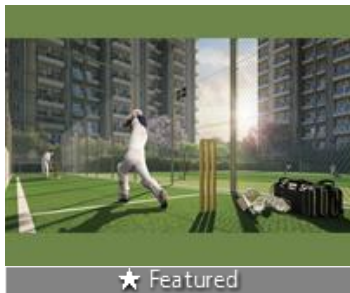

★ Featured

Palm Olympia Phase II Is A Well-Planned Project That Is Ideally Positioned In Noida Extension...

Palm Olympia Phase II By Sam India Abhimanyu Housing..

- Project/Society: [Palm Olympia](#)
- Area: 1806 SqFeet ▾
- Bathrooms: Four
- Total Floors: Twenty
- Furnished: Furnished
- Price: 18,545,000
- Rate: 10,269 per SqFeet **+60%**
- Age Of Construction: Under Construction
- Possession: Immediate/Ready to move
- Bedrooms: Four
- Floor: Second
- Facing: North East
- Transaction: New Property

## Description

Palm Olympia Phase II project is an offering from the well-established developer Sam India Abhimanyu Housing. In Palm Olympia Phase II you may take advantage of the best facilities like Earth quake resistant, Private Terrace/Garden, Cafeteria/Food Court, Banquet Hall, AEROBICS ROOM, Event Space & Amphitheatre, Flower Gardens, Park, Lift, Indoor Games Room. Noida Extension, Noida is the official address of this project. The pin code of this project is 201009. Palm Olympia Phase II spells convenience and comfort at a competitive price.

When you call, don't forget to mention that you found this ad on PropertyWala.com.

## Location

\* Location may be approximate

## Landmarks

### Nearby Localities

[Sector 1](#), [Tech Zone 4](#), [Sector 2](#), [Bisrakh](#), [Aimnabad](#), [Jalpura Village](#), [Sector 12](#), [Ecotech XII](#), [Ecotech XI](#)

\* All distances are approximate

## Locality Reviews

Noida Extension, Greater Noida

Hotcake location to be developed. Noida Extension is a planned city as per authority and the Parichowk to Jewar connector starts from the Noida Extension, near Delhi and the expressway.

### Pros:

- Affordable luxurious
- Gated Community

### Cons:

- Developing area

Posted: Jun 13 by Veena Mahour

Noida extension is good location near Noida, Ghaziabad, Greater Noida and Delhi. Now Noida extension is very low rent and resale price so this location attracts investment customers. Now ready metro project. Noida extension safe for human life with a broad road, near market all facilities available. All buildings approved by RERA and development by authority. So Noida extension is very excellent.

### Pros:

## Advertiser Details

**FAV Consulting Services**  
Shweta Mishra  
Agent

Sector 1, Noida  
mob: 7053593369

tel:  
mail: maira.vatika2014@gmail.com  
propertywala.com/fav-consulting-services



Scan QR code to get the contact info on your mobile  
[View all properties by FAV Consulting Services](#)

## Pictures

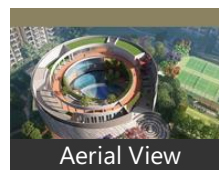

Aerial View

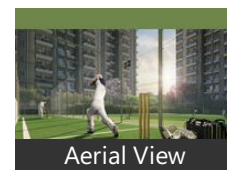

Aerial View

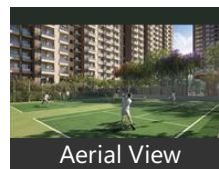

Aerial View

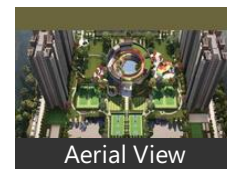

Aerial View

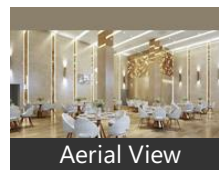

Aerial View

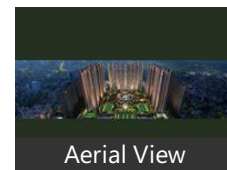

Aerial View

## Project Pictures

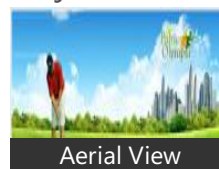

Aerial View

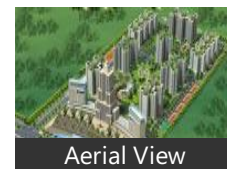

Aerial View

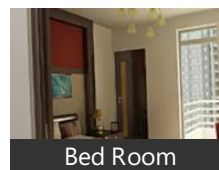

Bed Room

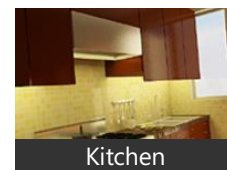

Kitchen

\* These pictures are of the project and might not represent the property

## Project Floor Plans

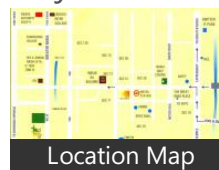

Location Map

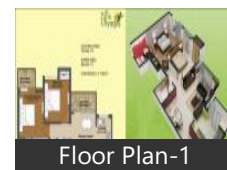

Floor Plan-1



Floor Plan-2

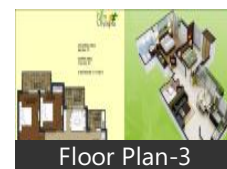

Floor Plan-3

- All amenities available
- Road
- Water

**Cons:**

- Slow working
- Many work under construction
- Other

Posted: Jan 6, 2020 by [Mr. D. Tomar \(Tomar Rent Property\)](#)



Floor Plan-4



Floor Plan-5

\* These floor plans are of the project and might not represent the property

Noida Extn is one of the most prominent location of Greater Noida. It touches the Noida & Ghaziabad and centrally located from Gr.Noida,Noida,GZb. It also in close proximity of Delhi. If anyone wants good affordable property options near Delhi/ Noida then Noida Extn would be excellent option to own a newly constructed property option

**Pros:**

- Affordable
- Centrally located
- New construction

**Cons:**

- High Density
- Future Traffic congesation
- Delayed projects

Posted: Jul 25, 2019 by [Xpert Homez \(Xpert Homez\)](#)

Noida Extension is a prime realty hub spot for investors and buyers. This location boasts of numerous advantages like schools, institutions, shopping complexes, restaurants. Also, investing in this location is beneficial as it is easily accessible by roads and expressways. Property rate in this location is increasing each passing day. So, go ahead buy a flat in noida extension.

**Pros:**

- Gaur International School Manthan school Ryan Group international school DPS World School Sarvottam

**Cons:**

- No

Posted: Sep 19, 2018 by [Vijay Gupta \(Skylark Group\)](#)

Its a very big area adjoining Noida,Ghaziabad,Greater Noida.In close proximity to Delhi. Sector 62,63 (the corpotaie hub of Noida) is 10 minutes drive from here.Metro is approved & work is in progress.Several affordable housing projects are there for all the categories of customers

**Pros:**

- low cost
- affordable
- bank approved

Posted: Feb 21, 2017 by [Abhishek S \(Spaces India\)](#)

most planned upcoming residential hub of DELHI NCR with provisions of all leading brands

**Pros:**

- connectivity
- proximity
- affordablity

**Cons:**

- underconstruction

Posted: Feb 9, 2017 by Abhishek Shankar

Noida Extension is ideal organized location to stay, away from dust and pollution.

**Pros:**

- Located Opposite to Gaur city International School

**Cons:**

- Its not yet fully developed

Posted: Feb 4, 2017 by Rajeev Sinha

Noida Extension going to be the best residential and IT Hub in Delhi NCR. It has access to 2 expressways Eastern Peripheral Expressway and FNG Expressway. More than 3 lakh Flats are in developing phase. Few societies already in possession. Schools like DPS, Saint Jones, Gaur International, Aster public School, Ryan International school etc are already there. Shopping malls, Business Centers, IT Space all are present within one location so it would be beneficial for residents of Noida Extension. Metro is also proposed by 2019 so it would be hot cake for investors in future.

**Pros:**

- Biggest Residential development
- Wide roads
- 50% Green area

**Cons:**

- Farmers Dispute

Posted: May 9, 2016 by [Anand Prakash \(Propright Infra Services\)](#)

Noida Extension having great builder background with school, commercial space, hospital etc

**Pros:**

- All amenities available

Posted: Apr 25, 2016 by [Manish bansal \(Capital Estate\)](#)

Noida Extension is the most sought after both for residential and commercial purpose, with many residential apartment flats and malls at this location and due to close connectivity from Delhi NCR and due to affordable flats at this location, Noida Extension has high demand. Many apartments now offering

Possession soon.

**Pros:**

- *Good connectivity*
- *Well developed*
- *Affordable price*

Posted: Jan 28, 2016 by Ajay Pathak

Noida Extension, Greater Noida is rated 7 out of 10 based on 10 user reviews.

Disclaimer: The reviews are opinions of PropertyWala.com members, and not of PropertyWala.com.

Explore

[Similar Properties](#)

[Properties in Noida Extension, Greater Noida](#)

[Projects in Greater Noida](#)

[Brokers in Greater Noida](#)

More Information

Report a problem with this listing

Is this property no longer available or has incorrect information?

[Report it!](#)

**Disclaimer:** All information is provided by advertisers and should be verified independently before entering into any transaction. You may visit the relevant RERA website of your state to verify the details of this property. PropertyWala.com is only an advertising platform to help connect buyers and sellers and is not a party to any transactions, nor shall be responsible or liable to resolve any disputes between them.