

## 2 Bedroom Apartment / Flat for rent in Tata New Haven, Yeshwanthpur, ... 15,000



★ Featured

Situated At A Prime Location Of Tumkur Road, Tata New Haven.

Tata New Haven, Tumkur Road, Yeshwanthpur, Bangalor...

- Project/Society: [Tata New Haven](#)
- Area: 1163 SqFeet ▾
- Bathrooms: Two
- Total Floors: Fourteen
- Furnished: Unfurnished
- Monthly Rent: 15,000
- Age Of Construction: 2 Years
- Available: Immediate/Ready to move
- Bedrooms: Two
- Floor: Fifth
- Facing: East
- Lease Period: 11 Months
- Rate: 13 per SqFeet **-30%**

### Description

Situated at a prime location of Tumkur Road, Tata New Haven is a meticulously designed project of Bangalore. The residential units in Tata New Haven are This project has its expanse over an area of 25 Acre. The project features a total of 1892 units that are well-ventilated.

This Residential property ensures to cater to the modern needs of all residents. All the units in the property are Ready To Move. Flat are the various types of units available, each of which has been created to provide total satisfaction. The size of different units available for sale in this project are 2 BHK Flat (708. 0 Sq. Ft. - 1163. 0 Sq. Ft. ) The well-planned site has 35 towers, and each of them have their own plus points. The launch date of this grand project is 01 December 2015. 01 September 2019 is the date of possession.

Please mention that you saw this ad on PropertyWala.com when you call.

### Location

\* Location may be approximate

### Landmarks

Nearby Localities

[Goraquntepalva](#), [HMT Layout](#), [Mathikere](#), [Peenya Industrial Area](#), [Jalahalli](#), [Dollars Colony](#), [New BEL Road](#), [RMV Stage II](#), [Raj Mahal Villas Stage 2](#), [Jalahalli West](#)

\* All distances are approximate

### Locality Reviews

Yeshwanthpur, Bangalore

Heart of city metro station, hospitals railway station ms ramaiah college bus stop

**Pros:**

- *IT IS GOOD FOR STUDENTS*

**Cons:**

- *Not a nice place married and people with family*

Posted: Nov 11, 2016 by Andrew r

Yeshwanthpur is down the time its going to be good locality. Once its developed then the price will be more than now as already prices have gone up.

**Pros:**

### Advertiser Details

**Temptation Realty**  
**Dileep Shetty**  
Director

Brigade Road area, Bangalore  
mob: 9741555559  
tel: 8050079074  
mail: [temptationrealty2011@gmail.com](mailto:temptationrealty2011@gmail.com)  
[temptationrealtyinc.com/](http://temptationrealtyinc.com/)

Scan QR code to get the contact info on your mobile  
[View all properties by Temptation Realty](#)

### Pictures

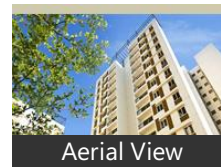
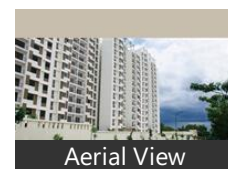
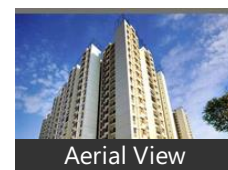
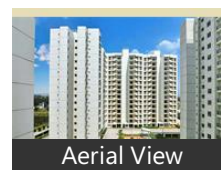

### Project Pictures

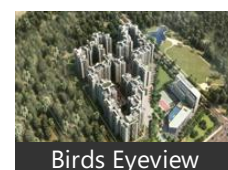
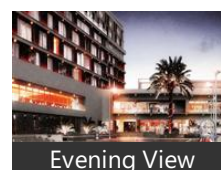
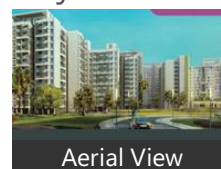

\* These pictures are of the project and might not represent the property

### Project Floor Plans



- Transit Hub
- Huge developments

Posted: Jun 10, 2015 by Anil Kumar

Yeshwanthpur is a commercial hub with metro station nearby.

**Pros:**

- Commercial Hub with all offices & banks present

**Cons:**

- Very busy area.

Posted: Mar 26, 2015 by Suresh iyyappa

Yeshwanthpur is in the heart of city, u can reach any part of Bangalore from Yeshwanthpur at all the 24 hrs of day. well establish education institute are situated in and around Yeshwanthpur, well established hospitals also available, its a trade center.

**Pros:**

- Well Planned Area
- A site seeing place

**Cons:**

- as it located in heart of the city it is thickly populated.

Posted: Nov 20, 2014 by Prasad

Yeshwanthpur is an industrial-cum-residential area located in the north-western part of Bangalore. It is a part of the Bangalore Urban District in the state of Karnataka. The Asian Highway 47 (AH47) and National Highway 4 (NH4) (Tumkur Road) run through this area. It is only 11.9 km away from Bangalore City. Asia's Largest industrial Hub (Peenya) with small, medium & large Scale industries is just stone throw distance. Yeshwanthpur, one of the important area of Bengaluru, is one of the fastest growing areas in the city, since Yeshwanthpur has location advantage as it is adjacent to the Peenya, a well known Industrial estate of Bangalore and also has vast network of important roads. With a mix of residential settlements and industrial units, Yeshwanthpur, today has the finest features that are distinctively representative of a blossoming cosmopolitan neighborhood. It is well connected with the city and has an abundance in amenities and social infrastructure that adds to its convenience.

**Pros:**

- Availability of good shopping centers, stores, cinema halls, schools
- Industrial HUB

Posted: Nov 12, 2014 by [Venu Reddy \(Vikram Structures\)](#)

Best point to enter from north of Bangalore.

**Pros:**

- 5 star hotels in and around
- Good high end hospital
- Good schools, parks, etc. are near to Yeshwanthpur

**Cons:**

- Still not got a elite outlook
- Nearby rail station, lot of mess, but just manageable.
- Few more elevated high ways to be extended to Yeshwanthpur

Posted: Jul 15, 2014 by Giri Iyer

Yeshwanthpur is an excellent location in Bangalore. Very close to railway station, metro station, Columbia hospital, People tree hospital, schools like NPS , Brigade. Malls Like Orion, sapphire mall etc.

**Pros:**

- Excellent location
- Close to railway station, metro station

**Cons:**

- Busy area

Posted: May 17, 2014 by Priti Manjunath

Yeshwanthpur is very good location for business. It is near to railway station, bus terminal, Columbia Asia Hospital, World Trade Center. Very good for area for commercial/business people.

**Pros:**

- Business Center
- Near Railway Station, Bus terminal, Columbia Asia Hospital, World Trade Center

**Cons:**

- Very busy area

Posted: Jun 12, 2013 by Jagadish A

Yeshwanthpur, Bangalore is rated 7 out of 10 based on 8 user reviews.

Disclaimer: The reviews are opinions of PropertyWala.com members, and not of PropertyWala.com.

Explore

[Similar Properties](#)

[Properties in Yeshwanthpur, Bangalore](#)

[Projects in Bangalore](#)

[Brokers in Bangalore](#)

More Information

Report a problem with this listing

Is this property no longer available or has incorrect information?

[Report it!](#)



\* These floor plans are of the project and might not represent the property

**Disclaimer:** All information is provided by advertisers and should be verified independently before entering into any transaction. You may visit the relevant RERA website of your state to verify the details of this property. PropertyWala.com is only an advertising platform to help connect buyers and sellers and is not a party to any transactions, nor shall be responsible or liable to resolve any disputes between them.