

3 Bedroom Apartment / Flat for sale in Palm Olympia, Noida Extension, G. 1.15 crore



★ Featured

3 Bedroom Apartment For Sale In Noida Extension, Greater Noida

Sam India Palm Olympia, Noida Extension, Greater Noida...

- Project/Society: [Palm Olympia](#)
- Area: 1357 SqFeet ▾ ■ Bedrooms: Three
- Bathrooms: Three
- Transaction: Resale Property
- Price: 11,500,000
- Rate: 8,475 per SqFeet **+35%**
- Age Of Construction: 12 Years
- Possession: Immediate/Ready to move

Description

Sam India Palm Olympia - A masterpiece of sorts away from the hectic city life, Palm Olympia is situated on 25 acres of landscaped greenery (approx. 80% open space) at Noida Extension. Homes and amenities have been planned in Palm Olympia keeping clear focus on healthy living. The homes are spacious & efficiently laid out. The township has two sports corridors giving ample opportunities to revitalize both the body and the soul to all. If you had always coveted a premium lush ambience within your budget then Palm Olympia is the perfectly fitting choice, to make your dreams come true.

Amenities & Specifications:

- Vaastu compliant.
- Intercom /Video phone systems.
- Earthquake protection.
- Fire fighting systems.
- Security and safety system backed by Digihome Solutions.
- Sewage treatment plant.
- Lush greenery.
- Rainwater harvesting.
- Sensor switches.
- Garden water recycling.
- 100% power backup.

When you call, please mention that you saw this ad on PropertyWala.com.

Features

General

- Power Back-up ■ Centrally Air Conditioned ■ Lifts
- Wi-Fi

Security

- Electronic Security ■ Intercom Facility

Lot

- Balcony ■ Park Facing

Interior

- Woodwork ■ Modular Kitchen ■ Granite Flooring
- Wooden Flooring ■ Feng Shui / Vaastu Compliant

Exterior

- Visitor Parking

Recreation

- Swimming Pool ■ Park ■ Fitness Centre / GYM
- Club / Community Center

Maintenance

- Maintenance Staff ■ Water Supply / Storage
- Water Softner ■ Rain Water Harvesting
- Waste Disposal

Location

Advertiser Details

Property Studio
Sumit Kumar Sharma
Director

Noida Extension, Greater Noida
mob: 9891770294
tel:
mail:
propertywala.com/property-studio-gr-noida

Scan QR code to get the contact info on your mobile
[View all properties by Property Studio](#)

Pictures

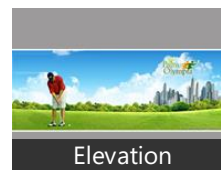

Elevation

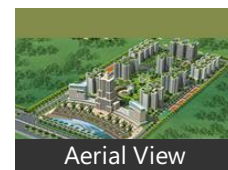

Aerial View

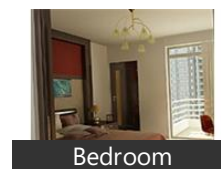

Bedroom

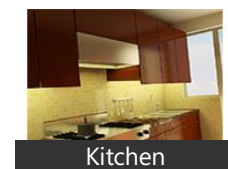

Kitchen

Floor Plans

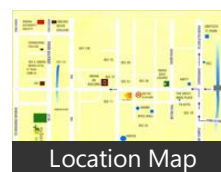

Location Map

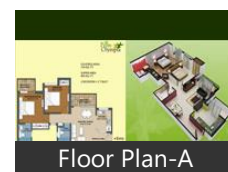

Floor Plan-A

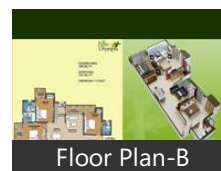

Floor Plan-B



Floor Plan-C



Floor Plan-D

Project Pictures



Aerial View

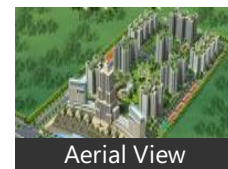

Aerial View

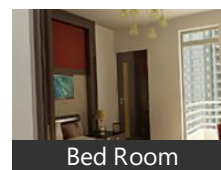

Bed Room

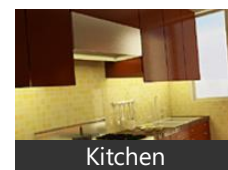

Kitchen

* These pictures are of the project and might not represent the property

Project Floor Plans

* Location may be approximate

Landmarks

Restaurant & Shops

Jockey (<0.5km), Rajan Aaditya Raj Associates (<0.5km.. Anushree Fashion (<0.5km), Eco Village Market (<0.5km), Easy Baby Life (<0.5km), Doorstep Handloom (<0.5km), AJ S Undergarments and Lingirie (<0... Eco Bazar Eco Village 1 (<0.5km), Radhika Pooja Ghar (<0.5km), Gogias Gifting Tree (<0.5km), Hanumant Classic Bazaar (<1km), Bhati Kirana Store (<1km), Sonu Readymade Garments (<1km), Himanshu Vegetable Shop (<1km), Moises Grocery Store (<1km), Shanvi Puja Ghar (<1km), Piyush Rice Shop (<1km), Chaudhary Kirana Store (<1km), Party Elements (<1km), Krishna Kirana Store (<1km), Bhartiya Sales (<1km), Noida Grocery (<1km), Shekhawat General Store (<1km), Fashion Footwear (<1km), Durga Cloths and Hosiery Store (<1k... Radhika Aata Chakki (<1km), Shiv Medical Center (<1km), Jayaswal Kirana Store (<1km), Ryan Fashion (<1km), Sharita Shindhiniya Shoes and Garme.. Neha Garments (<1km), Rocky Clothes House (<1km), Om Sai General Store (<1km), Panipat Handloom (<1km), Stylish Footwear (<1km), Sara Sansar (<1km), Indort Silk Handloom (<1km), Shoe Maker and Chick Contact (<1km)

Hospitals & Clinics

Dr Saurabh Gupta Clinic (<0.5km), Dentarch Solns (<0.5km), Breeze Dental Hub (<0.5km), A.K. Optical (<0.5km), Pahel Health Care (<0.5km), Apollo Diagnostics (<0.5km), Meraki Homeopathy Clinic (<0.5km), Dr Nishit Palo Clinic (<0.5km), 16th Dental Avenue (<0.5km), Dr. Vinod Bhardwaj Clinic (<0.5km), Jeevan Anand Family Clinic (<0.5km), Thyrocare Lab (<0.5km), Nikhils Physioup Physiotherapy Clini... Thyrocare (<0.5km), SRL Diagnostics (<0.5km), Max Lab (<0.5km), Dr. Gaurav Gupta Clinic (<0.5km), Dr Plus Pharmacy (<0.5km), Charak Ayush Clinic (<1km), Dr. Agarwal Homeoclinics (<1km), Sai Physiotherapy Clinic (<1km), Shri Sai Sheel Dental Clinic (<1km), Arhant Homoeopathic Clinic (<1km), Krishna Eye Care and Opticals (<1k... Dr. Ashish Clinic (<1km), Midas Dental Care (<1km), M. D Clinic (<1km), Atul Clinic (<1km), DR.Rohits Physiotherapy & Homecar.. Vaidya Ji Ayurvedic Clinic (<1km), Dr. Pratibha Bhardwaj Clinic (<1km), Petconcern Dog Clinic and Petshop (... Dental Hub and Implant Centre (<1k... Mediworld Health Care Clinic (<1km), D Optikart Noida Extension (<1km), Dr Lal Path Labs Noida Extension [more...](#)

Locality Reviews

Noida Extension, Greater Noida

Noida extantion is good location near noida , ghaziabad ,greater noida and Delhi. Now noida extantion is very low rent .and resale price so this location attract investment customer. Now ready metro project. Noida extantion safe for human life.with abroad road ,near market all facilities available.all building approved by RERA. and development by authority. So noida extantion is very excellent .

Pros:

- All amenities available
- Road
- Water

Cons:

- Slow working
- Many work under construction
- Other

Posted: Jan 6, 2020 by [Mr. D. Tomar \(Tomar Rent Property\)](#)

Noida Extn is one of the most prominent location of Greater Noida. It touches the Noida & Ghaziabad and centrally located from Gr.Noida,Noida,GZb. It also in close proximity of Delhi. If anyone wants good affordable property options near Delhi/ Noida then Noida Extn would be excellent option to own a newly constructed property option

Pros:

- Affordable
- Centrally located
- New construction

Cons:

- High Density
- Future Traffic congession
- Delayed projects

Posted: Jul 25, 2019 by [Xpert Homez \(Xpert Homez\)](#)

Noida Extension is a prime realty hub spot for investors and buyers. This location boasts of numerous advantages like schools, institutions, shopping complexes, restaurants. Also, investing in this location is beneficial as it is easily accessible by roads and expressways. Property rate in this location is increasing each passing day. So, go ahead buy a flat in noida extension.

Pros:

- Gaur International School Manthan school Ryan Group international school DPS World School Sarvottam

Cons:

- No

Posted: Sep 19, 2018 by [Vijay Gupta \(Skylark Group\)](#)

Its a very big area adjoining Noida,Ghaziabad,Greater Noida.In close proximity to Delhi. Sector 62,63 (the corportae hub of Noida) is 10 minutes drive from here.Metro is approved & work is in progress.Several affordable housing projects are there for all the categories of customers

Pros:

- low cost
- affordable
- bank approved

Posted: Feb 21, 2017 by [Abhishek S \(Spaces India\)](#)

most planned upcoming residential hub of DELHI NCR with provisions of all leading brands

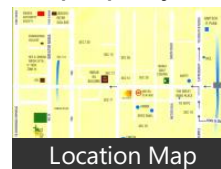

Location Map

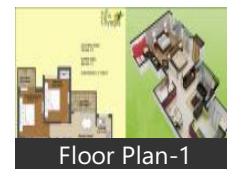

Floor Plan-1

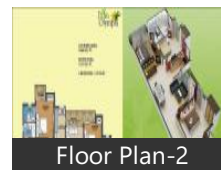

Floor Plan-2

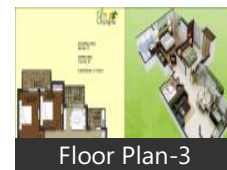

Floor Plan-3



Floor Plan-4



Floor Plan-5

* These floor plans are of the project and might not represent the property

Pros:

- connectivity
- proximity
- affordability

Cons:

- underconstruction

Posted: Feb 9, 2017 by Abhishek Shankar

Noida Extension is ideal organized location to stay, away from dust and pollution.

Pros:

- Located Opposite to Gaur city International School

Cons:

- Its not yet fully developed

Posted: Feb 4, 2017 by Rajeev Sinha

Noida Extension going to be the best residential and IT Hub in Delhi NCR. It has access to 2 expressways Eastern Peripheral Expressway and FNG Expressway. More than 3 lakh Flats are in developing phase. Few societies already in possession. Schools like DPS, Saint Jones, Gaur International, Aster public School, Ryan International school etc are already there. Shopping malls, Business Centers, IT Space all are present within one location so it would be beneficial for residents of Noida Extension. Metro is also proposed by 2019 so it would be hot cake for investors in future.

Pros:

- Biggest Residential development
- Wide roads
- 50% Green area

Cons:

- Farmers Dispute

Posted: May 9, 2016 by [Anand Prakash \(Proprietary Infra Services\)](#)

Noida Extension having great builder background with school, commercial space, hospital etc

Pros:

- All amenities available

Posted: Apr 25, 2016 by [Manish bansal \(Capital Estate\)](#)

Noida Extension is the most sought after both for residential and commercial purpose, with many residential apartment flats and malls at this location and due to close connectivity from Delhi NCR and due to affordable flats at this location, Noida Extension has high demand. Many apartments now offering Possession soon.

Pros:

- Good connectivity
- Well developed
- Affordable price

Posted: Jan 28, 2016 by Ajay Pathak

Noida Extension is a glorious city in India. It have many special facilities like 130 m wide road with one side 100 m shopping center and other side 100 green belt with metro, all most high rise building in this city. Eco friendly industries in this city.

Pros:

- Modern Amenities available here

Posted: Jun 16, 2015 by Bobby nagar

Noida Extension, Greater Noida is rated 7 out of 10 based on 10 user reviews.

Disclaimer: The reviews are opinions of PropertyWala.com members, and not of PropertyWala.com.

Explore

[Similar Properties](#)

[Properties in Noida Extension, Greater Noida](#)

[Projects in Greater Noida](#)

[Brokers in Greater Noida](#)

More Information

Report a problem with this listing

Is this property no longer available or has incorrect information?

[Report it!](#)

Disclaimer: All information is provided by advertisers and should be verified independently before entering into any transaction. You may visit the relevant RERA website of your state to verify the details of this property. PropertyWala.com is only an advertising platform to help connect buyers and sellers and is not a party to any transactions, nor shall be responsible or liable to resolve any disputes between them.