

4 Bedroom Apartment / Flat for sale in Godrej Tropical Isle, Sector 146, N.. 2.6 crores



Under Construction

146, Sector 146, Noida - 201301 (Uttar Pradesh)

- Project/Society: [Godrej Tropical Isle](#)
- Area: 3250 SqFeet ▾
- Bedrooms: Four
- Bathrooms: Five
- Floor: Tenth
- Total Floors: More than 20
- Facing: East
- Furnished: Semi Furnished
- Transaction: New Property
- Price: 26,000,000
- Rate: 8,000 per SqFeet ^{-50%}
- Age Of Construction: 1 Years
- Possession: Immediate/Ready to move

Description

Stunning island-Themed landscapes along with beachfront clubhouse Well connected to noida - Greater noida expressway Close to noida sector 146 metro station Air purification technology to provide fresh air in homes Gated township with 7-Tier security systems

When you contact, don't forget to mention that you saw this ad on PropertyWala.com.

Location

* Location may be approximate

Landmarks

Nearby Localities

[Gulawali Village](#), [Sector 162](#), [Sector 154](#), [Sector 153](#), [Sector 148](#), [Kambakshpur](#)

* All distances are approximate

Advertiser Details

Komal Realty
Shalini Sherma
Agent

Noida Extension, Greater Noida
mob: 7015083800
tel: 7532840347
mail:
www.propertywala.com/komal-realty

Scan QR code to get the contact info on your mobile

[View all properties by Komal Realty](#)

Project Pictures

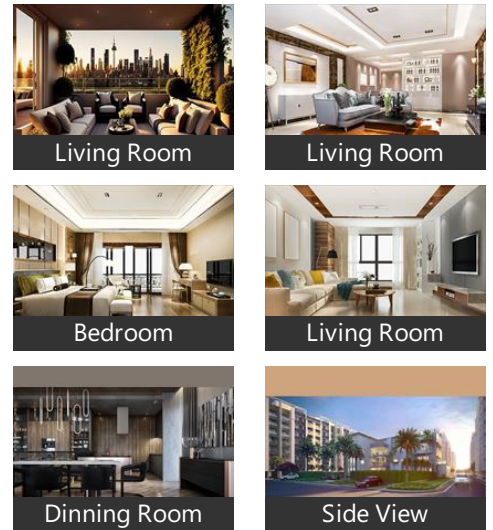

* These pictures are of the project and might not represent the property

Project Floor Plans

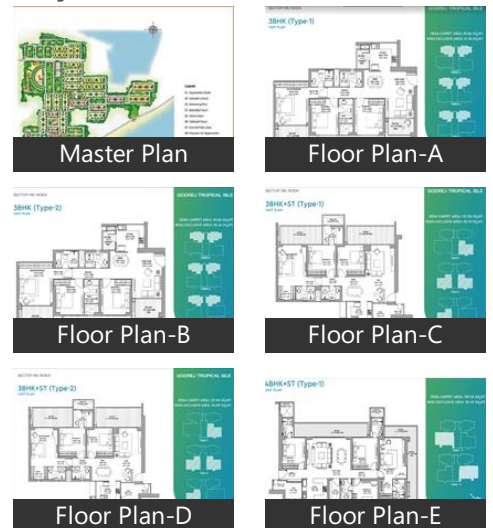

* These floor plans are of the project and might not represent the property

Explore

- [Similar Properties](#)
- [Properties in Sector 146, Noida](#)
- [Projects in Noida](#)
- [Brokers in Noida](#)

More Information

Report a problem with this listing

Is this property no longer available or has incorrect information?

[Report it!](#)

state to verify the details of this property. PropertyWala.com is only an advertising platform to help connect buyers and sellers and is not a party to any transactions, nor shall be responsible or liable to resolve any disputes between them.