

Shreepati Aradhana - Bhuleshwar, Mumbai



Setting new standards for customer centricity

Shreepati Aradhana by Shreepati Group at Bhuleshwar in Mumbai offers residential project that host 1,2 and 3 bhk apartment in various sizes.

- Project ID: J396799118
- Builder: Shreepati Group
- Location: Shreepati Aradhana, Bhuleshwar, Mumbai (Maharashtra)
- Completion Date: Dec, 2019
- Status: Completed

Description

Shreepati Aradhana is an unique residential property which will enhance your quality of life in a great level. The project host magnificent 1,2 and 3 bhk apartment in the size ranges in between 482 to 1011 sqft. Shreepati Aradhana comprises of a wide array of amenities that include Landscaped Garden, CCTV Cameras, Swimming Pool, etc. E njoy a contemporary lifestyle with all the nearby major utilities like schools, colleges, hospitals,super-marts, parks and recreational centres.

RERA ID : P51900000558

Amenities :

- 24Hrs Backup Electricity
- CCTV Cameras
- Security Personnel
- Lift
- Covered Car Parking
- 24Hrs Water Supply
- Club House
- Play Area
- Landscaped Garden
- Swimming Pool
- Gym

Shreepati Group The company activity started in repairing to retro fitting the old buildings, soon it discovered the true potential of the tenanted properties in Mumbai and acquired several such large properties and started redeveloping them under cluster approach. In the 30 years long journey, the group, with the spirit of innovation at its core, has carved a niche for itself as an industry benchmark for quality, customer focus, robust engineering, in-house research, uncompromising business ethics and the unwavering commitment to timeless values and total transparency in every aspect of its business.

Features

Luxury Features

- Power Back-up ■ Lifts ■ High Speed Internet

Lot Features

- Balcony

Recreation

- Swimming Pool ■ Park ■ Fitness Centre / GYM
- Club / Community Center

Security Features

- Security Guards

Exterior Features

- Reserved Parking

Maintenance

- Maintenance Staff ■ Rain Water Harvesting

Gallery

Pictures



Elevation

Floor Plans



Master Plan



Floor Plan A



Floor Plan B



Floor Plan C

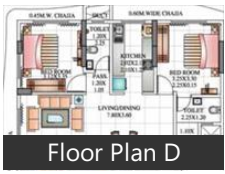

Floor Plan D



Floor Plan E



Floor Plan F



Floor Plan G



Location Map

Location

Landmarks

Hotel

West End Hotel (<2km), Ripon Palace Hotel (<2km), Hotel New Bengal (<2km), Taj Mahal Tower Mumbai (<5km), Residency Hotel (<3km), ITC Grand Central Hotel Mumbai (<7.. Four Seasons Hotel Mumbai (<6km), The Ambassador Marine Drive (<3km. Bentley, Hotel Windsor Mumbai (<3km), Abode Bombay (<5km), Hotel Travellers Inn (<3km), The St. Regis Mumbai (<6km), Regent Hotel (<5km), OYO 16119 Hotel Oliver (<5km), Ascot Hotel (<5km), Hotel Antique (<6km), Hotel Blue Bird (<6km)

Restaurant & Shops

Fashion Street Market (<3km), Bhagat Tarachand (<1km), Gaylord (<3km), Mahesh Lunch Home (<3km), 5 spice (<3km), Delhi Darbar (<5km), Pizza By The Bay (<3km), Chirabazar Fish Market (<1km), Mahavir NX (<1km), Haji Ali Juice Centre (<5km), Aram (<3km), 36 Oak & Barley (<3km), Nokia Solutions Partner (<3km)

Shopping Centre

Bhuleshwar Market (<0.5km), High Street Phoenix (<6km), Manish Market (<2km), Palladium (<6km), Orchid City Centre Mall (<2km), Earth Castle Mall (<1km)

Recreation

Taraporewala Aquarium (<1km), Marine Drive (<2km), Carnival Cinemas (<2km), Alankar Cinema (<1km), Metro Cinema (<2km), Jehangir Art Gallery (<4km), Regal Cinemas (<5km), Maratha Mandir (<3km), Eros Theatre (<3km), Priyadarshini Park (<4km), Colaba Causeway (<5km), Nehru Centre (<6km)

Landmark/Attraction

Mumba Devi Temple (<1km), Gateway of India (<5km), Chhatrapati Shivaji Terminal (<2km), Haji Ali Mosque (<5km), Mumbai High Court (<3km), Old Customs House (<4km), Mumbadevi Mandir (<0.5km), St Thomas Cathedral (<3km), Rajabai Clock Tower (<4km)

Building

Silk House (<1km), Nirmal Park (<5km), Jalimsingh Building (<2km), Rafai Tower (<1km), My Home (<3km), Marine Tower (<2km), Wellington Terrace (<2km)

Public Transport

CST Railway Station East-Entrance 1 ... Mumbai Central Railway Station (<3k.. Churchgate Railway Station (<3km), Grant Road Railway Station (<2km), Charni Road Railway Station East (<1... Marine Lines Railway Station (<1km), CST Railway Station East-Entrance 3 ... Charni Road Railway Station (<1km), CST Railway Station West-Entrance 2... Masjid (<2km), CST Railway Station West-Entrance 4... G T Hospital (<1km), Sandhurst Road Railway Station (<2k... Bhandi Bazar-Johar Chowk (<1km), Cotton Green (<6km)

Hospitals & Clinics

NM Medical (<1km), Prince Aly Khan Hospital (<3km), SVP Road Municipal Dispensary (<1k... Bombay Hospital (<2km), Habib Hospital (<2km), Sir H. N. Reliance Foundation Hospit... Bhatia Hospital (<3km), Atmasing Jessasing Bankerbihar Mun.. Saifee Hospital (<1km), Sir HN Reliance Hospital (<1km)

ATM/Bank/Exchange

Dena Bank-Thakurdwar Branch (<1k... Punjab National Bank (<1km), Federal Bank-Crawford Market (<1km.

Educational Facility

Jai Hind College (<3km)

Museum

Chhatrapati Shivaji Maharaj Vastu Sa... Nehru Planetarium (<6km)

Business & Services

Town Hall (Asiatic Society Library) (<..

Taxi Stand

Nair Hospital (<3km), Mumbai Central Railway Station (<3k..

Snacks/Fast food

Parsi Dairy Farm (<1km)

* All distances are approximate

Properties

Shreepati Aradhana News

Expert Reviews on Shreepati Aradhana

Explore

[Projects in Mumbai](#)

[Brokers in Mumbai](#)

More Information

Report a problem with this listing

Is any information on this page outdated or incorrect?

[Report it!](#)

Disclaimer: All information is provided by advertisers, including builders/agents/owners, or collected from publicly available sources and may not be verified under RERA. Any information provided on this website, including facts and figures, should be verified independently, including via the relevant RERA website, before entering into any transaction. PropertyWala.com is only an advertising platform to help connect buyers and sellers and is not a party to any transaction, nor shall be responsible or liable to resolve any disputes between them.

[Home](#) » [Mumbai Real Estate](#) » [Projects in Mumbai](#) » [Shreepati Aradhana - Bhuleshwar, Mumbai](#)