

Industrial Building for rent in Pawane, Navi Mumbai

8.8 lakhs



★ Featured

Available Industrial Premises Rental Basic: At Pawane TTC MIDC

Pawane, Pawane, Navi Mumbai - 400703 (Maharashtra)

- Area: 22000 SqFeet ▼
- Total Floors: Two
- Furnished: Unfurnished
- Monthly Rent: 880,000
- Age Of Construction: Under Construction
- Available: Immediate/Ready to move
- Floor: Ground
- Facing: East
- Lease Period: 1 Months
- Rate: 40 per SqFeet ^{-25%}

Description

Description of Property

Location of the Premises: At Pawane TTC MIDC

Plot Area: 2100 Sq mtr

Covered Area: 22,000 sq ft

Expected Rent: 8,80,000/-

Facilities Available: 200 HP Power, Toilet , Washroom Storeroom

When you contact us, please mention that you saw this ad on propertywala .com

Please mention that you saw this ad on PropertyWala.com when you call.

Location

* Location may be approximate

Landmarks

Nearby Localities

[Vashi Sector 28](#), [Turbhe](#), [Koper Khairane](#), [Mahape](#), [Vashi](#), [Kopar Khairane Sector-1](#)

* All distances are approximate

Explore

[Similar Properties](#)

[Properties in Pawane, Navi Mumbai](#)

[Projects in Navi Mumbai](#)

[Brokers in Navi Mumbai](#)

More Information

Advertiser Details

Scan QR code to get the contact info on your mobile
[View all properties by Unique Associates](#)

Pictures

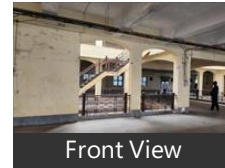

Front View



Front View



Front View



Front View

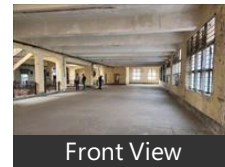

Front View

Report a problem with this listing

Is this property no longer available or has incorrect information?

[Report it!](#)

Disclaimer: All information is provided by advertisers and should be verified independently before entering into any transaction. You may visit the relevant RERA website of your state to verify the details of this property. PropertyWala.com is only an advertising platform to help connect buyers and sellers and is not a party to any transactions, nor shall be responsible or liable to resolve any disputes between them.