

Asvini Amarisa - Ramavaram, Chennai



A Haven Of Luxury And Beauty

The landscape is beautiful with spacious 8 Blocks and over 280 Houses. The generous 63% open area is defined by beautifully kept, mature and extensive gardens with lots of room for children to play in.

- Project ID : J290398011
- Builder: Asvini foundations Pvt. Ltd.
- Properties: Apartments / Flats
- Location: Asvini Amarisa, Ramavaram, Chennai (Tamil Nadu)
- Completion Date: Sep, 2010
- Status: Completed

Description

Asvini foundations Pvt. Ltd. : This underlying philosophy has been the engine for the company's fast paced growth over the last decade. This has also been the catalyst for creating new partnerships as we have moved forward. This lucid approach has clearly helped us in our commendable growth curve and this legacy lives on at Asvini and guides us in our day to day operations. Our endeavor is to excel in every project and the commitment has been unwavering towards achieving the goal. This has resulted in us becoming one of the largest and fastest growing construction companies in South India. Our Material management process and technique coupled with construction and service methodologies are unique and stand to give the best to our customers. We have broad-based our approach and consequently the clientele has also increased who look upon us as a time tested means of investment.

Asvini Amarisa: Indulge in the sheer delight of pampered luxury. AMARISA presents one of the most comprehensive and a premium residential development in the neighbourhood and it is by far a landmark structure at Ramapuram. Lavishly appointed, Amarisa brings together the very best of all modern lifestyle facilities to make you feel as relaxed and pampered as possible. The generous 63% open area is defined by beautifully kept, mature and extensive gardens with lots of room for children to play in. The spacious grounds feature neatly paved driveways, refreshing foliage, a jogging track and excellent parking facilities. Other exclusive amenities provided include a clubhouse with a well-equipped gym, a large pristine swimming pool, a visitors lounge and other attractive features. Be sure to experience life to the maximum, in safe and secure surroundings at Amarisa., now and in the times to come. You may combine relaxation with recreation, quiet with adventure and fun with play.

Location Advantages:

- Situated at a short distance of 10 minutes drive from the Chennai international and domestic airport
- Amarisa is part of a premium residential neighbourhood. There are numerous reputed schools and colleges in the vicinity
- Amarisa is well connected to all parts of the city through a good network of roads
- Amarisa enjoys close proximity to hospitals, banks, shops, places of worship and many other basic amenities.
- Additionally, Amarisa is within easy reach of employment hubs, transportation, entertainment and more, so residents can spend less time commuting

Lifestyle Amenities:

- Modular Sockets and Switches
- Ceramic Tiles
- Anti-skid Ceramic Tiles
- Vitrified Tile Flooring
- Decorative Main Door
- Rainwater Harvesting
- Swimming Pool
- Gymnasium
- Clubhouse
- Parking-Open
- Parking-Close

Features

Luxury Features

- Power Back-up ■ Lifts

Lot Features

- Balcony ■ Corner Location

Exterior Features

- Reserved Parking ■ Visitor Parking

Security Features

- Security Guards ■ Electronic Security
- Intercom Facility

Interior Features

- Woodwork ■ Modular Kitchen
- Feng Shui / Vaastu Compliant

Recreation

- Swimming Pool ■ Park ■ Fitness Centre / GYM
- Club / Community Center

Maintenance

- Maintenance Staff ■ Water Supply / Storage
- Waste Disposal

Land Features

- Clear Title ■ Freehold Land ■ Plot Boundary Wall
- Society Boundary Wall ■ Corner Plot
- Feng Shui / Vaastu Compliant
- Club / Community Center ■ Adjacent to Main Road
- Water Connection ■ Electric Connection
- Close to Hospital ■ Close to School
- Close to Shopping Center/Mall

Other features

- Society Name: ASVINI AMARISA
- Transaction: New Property ■ Possession: Immediate
- Ownership: Freehold
- Age of Property: Less than 5 Years

Gallery

Pictures



Front View



Side View



Nearby View

Floor Plans

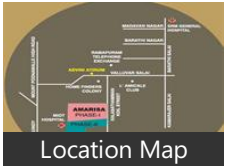

Location Map



Layout Plan

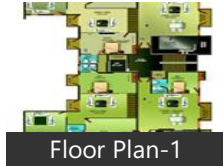

Floor Plan-1



Floor Plan-2



Floor Plan-3



Floor Plan-4

Location

Landmarks

Transportation

Zoom Taxi (<3km), V S N Call Taxi And Travels (<5km), Airport Authority Of India (<4km), Main Runway-Chennai Airport (<5km. Airport Old Traffic Control Tower (<5. Madras International Airport (<5km), National Airport Authority Stadium (... National Airports Authority (<6km), Cargo Terminal Chennai Airport (<6k.. Chennai Airport (<6km), Airport (<6km), Manapakkam And Ramapuram Bus S.. Nandambakkam Bus Stand (<2km), Moon Light Bus Stop (<2km), Nesapakkam Bus Stop (<3km), Bus Terminal (<3km), Bush Boake Allen (<3km), Ramapuram Bus Terminus (<3km), Sands Bus Stop (<3km), S And S Bus Stop (<3km), Guindy Railway Station (<5km), St Thomas Mount Railway Station (<... St. Thomas Mount Railway Station (<.. Pazhavanthangal Railway Station (<6.. Saidapet Railway Station (<6km)

Markets & Shopping Malls

Lokeshs Party Mall (<3km), Prestige Vijaya Mall (<6km), Trinetra Shopping (<4km), T N H B Shopping Complex (<4km), Government Shopping Complex (<4km Tnhb Shopping Complex (<4km), Tnhb Offices Shopping Complex (<5... Ashok Nagar Shopping Complex (<5... Mettupalayam Market (<6km), Saldapet Market (<6km)

Banks & ATMs

State Bank Of India (<2km), United Bank Of India Atm (<2km), State Bank Of India (<3km), Adyar Bakery And Hdfc Atm (<3km), Hdfc Atm (<4km), State Bank Of India Atm (<4km), Hsbc Atm (<4km), Andhra Bank Atm (<4km), Porur Icici Bank And Atm (<4km), Bank Of Baroda (<2km), K.K.Nagar Iob Bank (<3km), Icici Bank (<3km), Indian Bank (<3km), Canara Bank (<4km)

Hotels & Guest Houses

G R Guest House (<4km), Andaman And Nicobar Guest House... Sameera Guest House (<6km), Raj Residency (<3km), Hotel Sri Durga Prasad (<3km), Abbirami Hotels (<3km), Data Udiipi Hotel (<3km), Le Royal Meridien (<3km), Hotel Saravana Bhavan (<4km), Hotel Raja Bhavan (<4km), Empee Hilton Hotel Site (<4km), Radisson Grt Hotel (<4km), Hotel Ganpati Restaurant (<4km)

Restaurants & Clubs

Chennai Food Center Restaurant (<2... Kumarakom Restaurant (<2km), Nattukottai Chettinadu Veg And Non.. Chip Chap Restaurant (<3km), Teppanyaki At Cilantro (<3km), Wangs Kitchen (<4km), Navaratna (<4km), Hotel Ganpati Restaurant (<4km), Saravana Bhavan (<4km), La Amicale Club (<1km), Lions Club Hospital (<2km), Lions Club Chennai (<2km), Landt-Ecc Recreation Club Building (. Marvel Club Royale (<3km), Flame (<4km), Aero Club (<4km), Ashok Nagar Social Club (<4km), Ask Ngr Social Club (<4km), Madras Race Club Stables (<4km)

Parks

Regency Park Apartments (<1km), Infotech Park (<2km), Ibm Dlf Park Centre (<2km), Park Dugar Township (<2km), Dlf It Park (<2km), Yogesh Park (<3km), Krishna Park (<3km), Sabari Nagar Childrens Park (<3km)

Hospitals & Clinics

Miot Hospital (<1km), Lions Club Hospital (<2km), Hospital Canteen-Disease Production. Srm General Hospital (<2km), Defence Hospital (<2km), Military Hospital (<2km), Annai Clinical Laboratory (<1km), Shoba Beauty Clinic (<2km), Golden Jubilee Apartments Block B - ... Kirupu Clinical Laboratory (<3km), Sri Sakthi Diagnostic Centre (<3km), Sarda Poly Clinic (<3km), Mount Multispeciality Dental Clinic (... Homoeo Clinic (<3km), Vijaya Lakshmi Dental Clinic (<4km), Skin Clinic (<4km)

Movie Halls

Indira Cinema (<3km), Kasi Theatre (<3km), Vijaya Cinema (<4km), National Cinema (<4km), Jyothis Cinema (<4km), Udhayam Complex Cinema Hall (<4k.. Mini Udayan Theatre (<4km), Udyam Theatre (<4km), Sri Devi Karumariamman Complex (... Gopala Krishna Cinema (<5km)

Schools & Colleges

Srm Dental College (<2km), Easwari Engineering College (<2km), Easwari College Pg Block (<2km), Srm Dental (<2km), Easwari Engg College (<2km), Easwari Engg. College (<2km), Mariana Engineering College / Kings... Vani Vidyalaya (<3km), Koilpillai Schools-Pimary Class Room.. Koilpillai Memorial Matric Hr.Sec.Sch.. Kovil Pillai Higher Secondary School ... Koil Pillai Memorial Matriculation Hr... Chaple-Koilpillai School (<1km), Mgr School For Deaf (<1km), Sivanthi Matriculation School (<1km), Sivanthi Higher Secondary School (<... Mgr Home And Higher Secondary Sc.. Sri Ram Nursery And Primary School...

Offices

Whirlpool Office (<1km), Records And Data Warehousing Pvt. ... Nandambakkam Post Office (<2km), Office World (<2km), Larsen And Toubro Office (<2km), Township Town Panchayat Office (<... Town Panchayat Office (<2km)

* All distances are approximate

Properties

Type	Area	Possession	Price *
2BHK Apartment / Flat	953 SqFeet	-	₹ 62 lakhs
2BHK Apartment / Flat	1001 SqFeet	-	₹ 15,001-20,000
2BHK Apartment / Flat	1350 SqFeet	-	₹ 63 lakhs
3BHK Apartment / Flat	1251 SqFeet	-	₹ 85 lakhs

* Data has been collected from publicly available sources and may not be up to date.

Asvini Amarisa News

Expert Reviews on Asvini Amarisa

Explore

[Projects in Chennai](#)
[Brokers in Chennai](#)

More Information

Report a problem with this listing

Is any information on this page outdated or incorrect?
[Report it!](#)

Disclaimer: All information is provided by builders, advertisers, or collected from publicly available sources and may not be verified as per RERA guidelines. Any information provided on this website, including facts and figures, should be verified independently before entering into any transaction. PropertyWala.com is only an advertising platform to help connect buyers and sellers and is not a party to any transaction, nor shall be responsible or liable to resolve any disputes between them.