

Aarone Cyberwalk - IMT Manesar, Gurgaon



Retail, Commercial Areas & Service Apartments in Manesar

Aarone Group presented super class commercial project Aarone Cyber Walk, which is located at Manesar, Gurgaon.

- Project ID : J919055171
- Builder: Aarone Group
- Properties: Shops, Office Spaces
- Location: Plot No. CP-09, Sector - 8, IMT Manesar, Gurgaon (Haryana)
- Completion Date: Jan, 2011
- Status: Started

Description

Aarone Cyberwalk by Aarone group is a notable name in Gurgaon. It is the commercial project undertaken by Aarone group for middle class family. The main purpose of this project is to make available newly constructed shops within your budget. Other great offering by the builder is the 12% assured return per year for the next five years. Properties of type Retail, Commercial Areas & Service Apartments are available on first come first serve basis.

Important of this project is making you feel in the lapse on nature. It will make you feel relaxed and comfortable away from hustle and bustle of city life. Birds chirp and trees and greenery are the main attraction, which will make you feel energetic and soothes your nerves.

Invest 15 lacs in ready to possess Retail, Commercial Areas & Service Apartments and get Rs.15000 per month assured returns.

Key Features and Highlights

- 1.4 Million sq ft of Office spaces, Serviced Apartments, retail & commercial areas with sufficient parking facility
- 30 min from IGI airport and 20 min drive from IFFCO Chowk
- Located right on NH-8, KMP (Kundli-Manesar-Palwal) Expressway and Dwarka-Manesar Expressway (NPR)
- LEED Gold pre-certified green campus by Indian Green Building Council
- Part of 150 acre dedicated IT Park campus in Manesar off NH-8, already home to multinational giants such as Agilent Technologies, Nestle, Bharti Group & HCL Technologies
- 25,000 sq ft - 38,000 sq ft office floor plates
- Ready for possession since 2011
- Winner of Asia Pacific Property Award for Best Office Development India-2011, held in Shanghai
- 30 minutes from Delhi IGI Airport
- Metro proposed till Manesar
- Proposed Inter State Bus Terminal
- Wide well built Roads.
- HVAC - Air- conditioning system
- Ground water recharging done through pits and sumps
- Low water consuming plants and trees will be used
- 250 bed super specialty hospital by Rockland group
- 2/3/5 star business hotels, serviced apartments, IT park, golf course, helipad and shopping arcades in the vicinity
- Amity University coming up with 110 acre IT Campus in Manesar
- Air conditioned furnished offices
- Communication Equipments such as teleconferencing, video-conferencing, IP Telephony etc.
- Health & fitness center, swimming pools, day care center, ATMs, food courts, & cafeterias

Aarone Group is a very well known name in the real estate business. It is a Delhi based developer with a very good track record and having more than 20 years of experience in the business of real estate. Mr. Yog Raj Arora, Chartered Accountant, is the head of this group. CYBERWALK, a 1.8 million sq ft is eco IT office complex in Manesar, Gurgaon. There are various other successful project under their belt like Select City Walk in New Delhi- Malviya Nagar, It has bagged the award of most Admired Shopping Center in India for the years 2008, 2009 & 2010. They are know for their timelines, quality and efficient project management. Cyberwalk by Aarone Group, wins award for "Highly Commended Office Development 2011".

Features

Luxury Features

- Power Back-up ■ High Speed Internet ■ Wi-Fi

Exterior Features

- Reserved Parking ■ Visitor Parking

Commercial Features

Security Features

- Security Guards ■ Electronic Security
- Intercom Facility ■ Fire Alarm

Maintenance

- Maintenance Staff ■ Water Supply / Storage
- Rain Water Harvesting ■ Waste Disposal

Land Features

- Cafeteria / Food Court ■ Conference room

- Freehold Land ■ Plot Boundary Wall
- Feng Shui / Vaastu Compliant
- Club / Community Center ■ Adjacent to Main Road
- Park/Green Belt Facing ■ Water Connection
- Electric Connection ■ Close to Hospital
- Close to School

Gallery

Pictures



Floor Plans

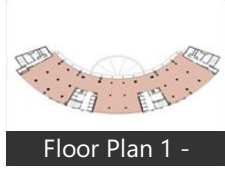

Location

Landmarks

Transportation

IMT Chowk Bus Stop (<3km), Manesar Bus Stop (<3km), Shikohpur More Bus Stop (<6km), Vatika India Next Bus Stop (<7km), ISBT Depot (<9km), Kherki Daula Bus Stop (<10km), Aklimpur Bus Stand (<16km), Basai Station Bus Stop (<16km), Balaji Tempo Stand (<15km), Sai Taxi (<26km), Taxi stand (<29km), Auto Stand (<22km), Rajshree Travels (<23km), Divya Taxi Service (<24km), Auto Stand (<26km), Genpact Auto Stand (<27km), Garhi Harsaru Junction Railway Statio.. Patli Railway Station (<10km), jataula village (<17km), Taj Nagar Railway Station (<14km), Gurgaon Railway Station (<22km), Sultanpur Kaliawas Railway Station (<. Basai Dhankot Railway Station (<16k... Indira Gandhi International Airport (<..

Markets & Shopping Malls

Amrapali Corporate Mall (<2km), Galleria 91 (<5km), SS Group Commercial (<5km), Raheja Mall Gurgaon (<18km), Gold Souk Mall (<24km), MGF Megacity Mall (<28km), Shoppers Stop (<17km), Your shop (<15km), Croma (<20km), Ocus Medley (<16km)

Banks & ATMs

Axis Bank (<1km), Kotak Mahindra Bank - Worksite (<2... Kotak Mahindra Bank – Branch/ATM...

ICICI Bank Ltd. - Manesar (<2km), Axis Bank (<2km), HDFC Bank ATM (<2km), Vijay Bank (<2km), Central Bank Of India (<2km), ICICI Bank ATM (<2km), State Bank of India ATM (<3km), HDFC Bank ATM (<3km), Hdfc Bank (<3km), Dena Bank ATM (<3km), Corporation Bank ATM (<3km)

Hotels & Guest Houses

Anand Villa Gurgaon (<2km), VidKris Home (<4km), Cinnamon Stays (<17km), Perch Service Apartments Gurgaon (... Elegant Home Care and Facilities Priv., Eldeco Mansionz (<17km), PrettyHomeS Guest House & Service... The Signature Leaf (<20km), Shivam Hotel (<1km), Heritage Village Hotel (<2km), Wet n Wild Hotels & Resorts (<5km), Heritage Village Resort & Spa Manes... Heritage Village Resort & Spa (<2km), Best Western Resort Country Club (<... Ginger Hotel Manesar (<2km), Chauhan Hotel (<2km)

Restaurants & Clubs

Manesar Club (<1km), Best Western Resort Country Club (<... Rao G Club (<3km), Haryana Polo Club (<10km), Crowne Plaza Gurgaon (<24km), DLF Golf & Country Club (<28km), China Club (<20km), Nirvana Country (<20km), Kyoto (<2km), Savoy Suites Manesar (<3km), Mc Donald, Nirula, McDonalds (<3km), Nitin Restaurant (<2km), Sonu Karner (<2km), DDN (<3km)

Movie Halls

Raj Cinema (<21km), BIG Cinemas Palam (<27km), SRS Cinemas Celebration/Wedding m. Payal Cinema (<24km), SRS Cinemas (<17km), PVR Gold (<31km), DT Cinemas (<27km), Shakuntala Cinema Hall (<20km)

Parks

Anantraj IT Park (<3km), Cyberwalk - the Greener pastures (<4.. Aapno Ghar (<7km), Tau Devi Lal Park (<2km), Bestech Park View Sanskriti (<6km), Sultanpur Bird Sanctuary (<15km), Unitech South Park (<15km), Ambedkar Park (<10km)

Hospitals & Clinics

Ross Clinics (<3km), Sercare Clinic (<2km), Dr.pale Clinic (<2km), Amba Clinic (<2km), Rao Medicose (<2km), Promla Clinic (<2km), Pooja Medical (<2km), Balaji Medical Store (<3km), Rock Land Hospital (<1km), Yadav Hospital (<2km), Paras Medical Hospital (<2km), Shree Sai Hospital (<3km), Chouhan Hospital (<3km), Sunil Hospital (<3km), Raj Hospital (<3km), Medanta The Medicity (<19km)

Offices

Lifestyle Chair Gallery Private Limited.. Honda Motorcycle & Scooter India P.. Encore Office Systems Pvt Ltd (<1km.. Outright Furniture (<2km), Fine Grace (<2km), Denso International India Pvt. Ltd. (<... Geeken Seating Collection Pvt. Ltd. (... Bundy India Limited (<1km)

Schools & Colleges

Dronacharya College Of Engineering... Haryana IGNOU Community College.. Amity University (<9km), Govt. Polytechnic Manesar (<6km), Dronacharya College of Engineering ... KIIT College of Engineering (<19km), ITM University (<27km), NIIT Corporate Office (<20km), Marshall Technology Center (<1km), DPS Manesar (<3km), GSR Public School (<2km), Rcm Center (<3km), Priynka Public School (<3km), Priyanka Public School (<3km), Kids World School (<3km)

* All distances are approximate

Properties

Type	Area	Possession	Price *
Shop	250 SqFeet	-	₹ 20 lakhs
Shop	341 SqFeet	-	₹ 29 lakhs
Shop	500 SqFeet	-	₹ 40 lakhs
Shop	750 SqFeet	-	₹ 60 lakhs
Shop	1000 SqFeet	-	₹ 80 lakhs
Office Space	250 SqFeet	-	₹ 20 lakhs
Office Space	250 SqFeet	-	₹ 15 lakhs
Office Space	500 SqFeet	-	₹ 30 lakhs
Office Space	500 SqFeet	-	₹ 30 lakhs
Office Space	750 SqFeet	-	₹ 45 lakhs
Office Space	1000 SqFeet	-	₹ 60 lakhs
Office Space	1000 SqFeet	-	₹ 60 lakhs

* Data has been collected from publicly available sources and may not be up to date.

Aarone Cyberwalk News

Expert Reviews on Aarone Cyberwalk

Explore

[Projects in Gurgaon](#)

[Brokers in Gurgaon](#)

More Information

Report a problem with this listing

Is any information on this page outdated or incorrect?

[Report it!](#)

Disclaimer: All information is provided by builders, advertisers, or collected from publicly available sources and may not be verified as per RERA guidelines. Any information provided on this website, including facts and figures, should be verified independently before entering into any transaction. PropertyWala.com is only an advertising platform to help connect buyers and sellers and is not a party to any transaction, nor shall be responsible or liable to resolve any disputes between them.

[PropertyWala.com](#) » [Gurgaon Real Estate](#) » [Projects in Gurgaon](#) » [Aarone Cyberwalk - IMT Manesar, Gurgaon](#)