

Emaar MGF Emerald Floors Premier - Sector-6..



Luxury Villas at Emerald Hills

Emerald Floors Premier, low-rise premium homes featuring the highest design standards and quality amenities at attractive price points. Walk into your home and experience a feeling of luxury, quality and workmanship.

- Project ID : J500011905
- Builder: Emaar MGF Land Limited
- Properties: Apartments / Flats
- Location: Emaar MGF Emerald Floors Premier, Sector-65, Gurgaon (Haryana)
- Completion Date: Dec, 2011
- Status: Started

Description

Emaar MGF Land Limited ("Emaar MGF", "the Company") is a joint venture between Emaar Properties PJSC ("Emaar") of Dubai and MGF Development Limited ("MGF") of India. Emaar is one of the world's leading real estate companies, having developed approximately 89 million square feet of real estate across residential, commercial and other business segments and with operations in 14 countries. MGF has established itself as one of the key players in retail real estate development in Northern India and has delivered approximately 2 million square feet of retail space.

Emerald Floors Premier, low-rise premium homes featuring the highest design standards and quality amenities at attractive price points. Walk into your home and experience a feeling of luxury, quality and workmanship. As part of the larger Emerald Hills community, each apartment is designed to give you the freedom to grow and flourish in a gated community. Undoubtedly the perfect home for you and your loved ones.

"Enjoy the luxury of Villa Floors with the lifestyle and security of a gated community."

Part of a larger master planned community of Emerald Hills, the Emerald Floors Premier is located in a thriving neighbourhood with schools and hospital nearby. It is strategically located in the emerging Suburban Business District on the Golf Course Extension Road, close to the proposed Metro corridor with easy access from Express Highway to the city. The Delhi International Airport is also just a 20 minute drive away.

Highlights:

- Secured Gated Community
- On Proposed Metro Corridor
- One and Only High-End Community by EmaarMGF offering residential plots in Gurgaon
- Streetscaping And Lighting
- Water and Drainage Services
- Facility Management Services
- Spanish styled architecture
- Designed by Californian planners and architects
- Cohesive urban design - street furniture, signages and road lighting
- Green areas and tree-lined streets
- Water features throughout the landscape
- Segregation of pedestal and vehicular movement
- Environment friendly planning
- Choice of Independent plots

Features

Luxury Features

- Power Back-up ■ Lifts ■ RO System
- Water Softner

Exterior Features

- Reserved Parking ■ Visitor Parking ■ Servant Quarter
- Basement

Commercial Features

- Cafeteria / Food Court ■ Conference room
- Service / Goods Lift ■ High Speed Internet / Wi-Fi

Security Features

- Security Guards ■ Electronic Security
- Intercom Facility ■ Fire Alarm

Maintenance

- Maintenance Staff ■ Water Supply / Storage
- Boring / Tube-well ■ Rain Water Harvesting
- Waste Disposal

Land Features

- Society Boundary Wall ■ Corner Plot
- Feng Shui / Vaastu Compliant
- Club / Community Center ■ Adjacent to Main Road
- Park/Green Belt Facing ■ Water Connection
- Electric Connection ■ Close to Hospital
- Close to School ■ Close to Shopping Center/Mall

Gallery

Pictures



Front View



Building View



Side View

Floor Plans



Type-A



Type-B

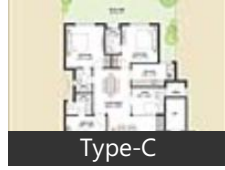

Type-C



Site Plan

Documents



Application Form



Brochure

Location

Landmarks

Transportation

Railway Station (<18km), Gurgaon Railway Station (<18km), Basai Dhankot Railway Station (<19k...
Bijwasan Railway Station (<21km), Sector 56 Bus Stand (<4km), Auto Stand For Bus Stand (<5km), Orchid (<12km),
International Airport Authority Of Ind.. Private Delhi Airport Parking And Sto.. Lnt Site Office For International Airpo..

Markets & Shopping Malls

Central Plaza Mall (<6km), Huda Market (<3km), Sun City Shopping Complex (<5km)

Banks & ATMs

Icici Bank And Atm (<4km)

Hotels & Guest Houses

***** 5 Star Hotel Site (<8km), Huda Approved Five Star Hotel Site (... Krishna Hotel Of Narsi Developer (<8..
Park Plaza Hotel (<9km), King Castle Hotel Resorts (<9km), Sukh Sagar (<9km), Anande Regency Hotel (<9km),
Hotel Hillton (<10km), Hotel Rose Day Inn (<10km), Lemon Tree Hotel (<10km), Pasricha Guest House (<13km),
Surya Guest House (<13km), Lee Guest House (<14km), Maharani Guest House (<15km),
Taikisha Guest House (<16km), Aggarwal Guest House (<16km), Guest House 1 luac (<21km)

Restaurants & Clubs

Just Mughlai (<4km), Shree Sweets & Restaurant (<4km), Raj Restaurant (<4km), Club Florence (<2km),
Lions Club Society (<4km), Tripathi Night Club (<5km)

Movie Halls

Chakarpur Cinema Halls (<10km), Dt Mega Mall - With Dt Cinemas (<1... D T Cinema (<12km)

Hospitals & Clinics

Hospital (Abandoned!) (<3km), Healers Hospital (<5km), Helass Hospital (<5km), Healers Hospital (<6km),
The 32 Pearls Dental Clinic (<3km), Stone Clinic (<4km), Pearl Dental Clinic (<4km),
Dr. Payal Mittal Dental Clinic (<6km)

Parks

Central Park Kendriya Vihar- Raina Su.. Huda Park Sector 55 (<4km), Beautiful Oval Shape Park (<4km),
Main Entrance: Tau Devi Lal Park - Bo. Park Place (<6km)

Schools & Colleges

The Heritage School (<2km), Golden Heights School lscse (<3km), Amazon International School (<3km), Gurugram Public School (<3km), Neeru (<3km), Shuchita (<3km), Scottish High International School (<.. Shiksha Bharti School (<4km), Suncity World School (<5km), Ansal Institute Of Technology (<4km)

Offices

Sector 56 Post Office Pin Code 12201... Bsnl Office-56 (<3km), Post Office (<5km), Sap Office (<5km), Manglam Jain Office (<6km), Unitech Project Office (<6km), Ceb Office (<6km)

* All distances are approximate

Properties

| Type | Area | Possession | Price * |
|-----------------------|-------------|------------|------------------|
| 3BHK Apartment / Flat | 267 SqFeet | - | ₹ 1.24 crore |
| 3BHK Apartment / Flat | 1380 SqFeet | - | ₹ 1.05 crore |
| 3BHK Apartment / Flat | 1380 SqFeet | - | ₹ 1.12 crore |
| 3BHK Apartment / Flat | 1450 SqFeet | - | ₹ 1.25 crore |
| 3BHK Apartment / Flat | 1600 SqFeet | - | ₹ 1.28 crore |
| 3BHK Apartment / Flat | 1650 SqFeet | - | ₹ 1.25 crore |
| 3BHK Apartment / Flat | 1950 SqFeet | - | ₹ 1.2 crore |
| 3BHK Apartment / Flat | 1980 SqFeet | - | ₹ 1.2 crore |
| 3BHK Apartment / Flat | 2125 SqFeet | - | ₹ 1.5 - 2 crores |
| 3BHK Apartment / Flat | 267 SqYards | - | ₹ 1.35 crore |
| 3BHK Apartment / Flat | 2835 SqFeet | - | ₹ 1.27 crore |
| 4BHK Apartment / Flat | 1750 SqFeet | - | ₹ 1.32 crore |
| 4BHK Apartment / Flat | 1750 SqFeet | - | ₹ 1.15 crore |
| 4BHK Apartment / Flat | 1760 SqFeet | - | ₹ 1.55 crore |
| 4BHK Apartment / Flat | 350 SqYards | - | ₹ 1.54 crore |
| 4BHK Apartment / Flat | 350 SqYards | - | ₹ 1.4 crore |

* Data has been collected from publicly available sources and may not be up to date.

Properties available in 'Emaar MGF Emerald Floors Premier'

4 Bedroom Flat for sale in Emaar MGF Emerald Floors Prem... 1.5 crore



350 SqYards Apartment @ Rs.42857/SqYard
ID: P3631235 — Posted: Jul 22 by [Global Wealth Planners Private Limited](#)
Newly constructed luxurious floor by Emaar MGF (Emaar MGF Emerald Floors Premier)
This is a ready to move low rise floor constructed by Emaar Developers. It has 4 bedrooms plus one store room. This society is situated on Golf Course Ext. Road and it has all amenities like club, pool and gym. Please contact for more details. [more details](#)

3 Bedroom Flat for rent in Emaar MGF Emerald Floors Prem.. 34,000



1750 SqFeet Apartment @ Rs.19/SqFeet
ID: P99474413 — Posted: Jun 20 by [Chandra Kant](#)
newly apartment (Emaar MGF Emerald Floors Premier)
3 Bhk Apartment For Rent In Sector-65, Gurgaon. It Is A Semifurnished Apartment, Located On The 3rd Floor Of 3 Floors. The Apartment Has 3 Bedrooms 3 Bathrooms 3 Balcony(S). It Is Also Equipped With 1 Wardrobe(S), 2 Fan(S) And 2 Light(S). It Has Vitrified Flooring. It Is Immediately ... [more details](#)

Emaar MGF Emerald Floors Premier News

Expert Reviews on Emaar MGF Emerald Floors Premier

The project construction activities are going on very very slow pace. As a matter of fact there has been hardly any progress in the status of project in last 6 months and hence delivery / completion scedule is definitely going to be inordinately delayed.

Pros:

- *Good location*

Cons:

- *No 100% power backup*
- *Less greenery/open green spaces*
- *Slow progress*

Posted: Jun 6, 2013 by R. Mattoo

Emaar Mgf Emerald Floors Premier Gurgaon is rated 3 out of 10 based on 1 user reviews.

Disclaimer: The reviews are opinions of PropertyWala.com members, and not of PropertyWala.com.

Explore

[Projects in Gurgaon](#)

[Brokers in Gurgaon](#)

More Information

Report a problem with this listing

Is any information on this page outdated or incorrect?

[Report it!](#)

Disclaimer: All information is provided by builders, advertisers, or collected from publicly available sources and may not be verified as per RERA guidelines. Any information provided on this website, including facts and figures, should be verified independently before entering into any transaction. PropertyWala.com is only an advertising platform to help connect buyers and sellers and is not a party to any transaction, nor shall be responsible or liable to resolve any disputes between them.

[PropertyWala.com](#) » [Gurgaon Real Estate](#) » [Projects in Gurgaon](#) » [Emaar MGF Emerald Floors Premier - Sector-65, Gurgaon](#)