

Ganesh Sai Basera - Ulve, Navi Mumbai



the view of serene as the feast of eyes and thought for mind.

Ganesh Sai Basera is located in the prime sector-23 of ulve, which is walkable (5 min) from the upcoming railway station (bamandongri).

- Project ID : J658119065
- Builder: Ganesha Construction
- Properties: Apartments / Flats
- Location: Ganesh Sai Basera,Sec-23, Ulve, Navi Mumbai (Maharashtra)
- Completion Date: Sep, 2012
- Status: Started

Description

Ganesha Construction has successfully built a reputation in the construction Industry in a short span of time providing premium homes and commercial properties. Ever since we have commenced our journey on the path of building quality homes for a better living, we have only been exceeding expectations but never your budget. To ensure the company is meeting the expectations of today's buyers, our organization offers a blend of quality material and superior design, where every facet is thoroughly and systematically crafted. Complete attention is given to each detail from the beginning to the finish of every spot of the property, It also provided the location for comfortable living in a city that is beyond city life where you have easy connectivity to major hubs. Having an eye for quality construction, the organization has carefully selected extremely qualified professionals to ascertain excellence and eminence in each home. We constantly endeavor our devotion and loyalty to ensure a significant status in the construction industry.

Ganesh Sai Basera is located in Sector 23, Ulve at 11mm Wide Road has a very good Air Ventilation from the front as the frontage area is Sanctioned as Open Space Area by the Cidco Authorities. The Upcoming Railway Station(Named as BAMANDONGRI) is 5min Walkable from the Project. The Plans are Sanctioned by the CIDCO. The Availability of Flats in the Project are Limited as 70% of Stock has been sold.

Amenities :

- Best and attractive elevation for a beautiful look
- Vitrified flooring in all rooms
- Doors with lavish laminate finish
- Aluminum sliding windows with black powder coat with mosquito net
- Glazed tiles in bathroom up to 7 ft height
- Concealed plumbing
- Quality sanitary fittings
- One hot & cold water mixture in flat
- One geyser in each flat
- Water purifier
- Granite kitchen platform with S.S sink
- Tiles in the kitchen up to 7 ft height
- Concealed electric points
- Telephone and t.V cable points in each flat
- Beautifully designed entrance lobby
- Earthquake resistant R.C.C design
- Video door phones.

Location : Ganesh Sai Basera,Ulve, Navi Mumbai (Maharashtra).

Features

Luxury Features

- Power Back-up ■ Lifts ■ RO System
- Water Softner

Lot Features

- Private Terrace ■ Balcony ■ Park Facing

Exterior Features

- Reserved Parking ■ Visitor Parking ■ Basement

Maintenance

- Maintenance Staff ■ Water Supply / Storage
- Rain Water Harvesting ■ Waste Disposal

Security Features

- Security Guards ■ Electronic Security
- Intercom Facility ■ Fire Alarm

Interior Features

- Woodwork ■ Modular Kitchen
- Feng Shui / Vaastu Compliant

Recreation

- Swimming Pool ■ Park ■ Club / Community Center

Land Features

- Clear Title ■ Freehold Land
- Feng Shui / Vaastu Compliant
- Club / Community Center ■ Adjacent to Main Road
- Park/Green Belt Facing ■ Water Connection
- Electric Connection ■ Close to Hospital
- Close to School ■ Close to Shopping Center/Mall

Other features

- Security / Fire Alarm ■ Lift(s) ■ Security Personnel
- Water Storage ■ 2 Balconies ■ East Facing
- New Property ■ Dec ■ 2011 Possession
- Freehold Ownership ■ Under Construction Property
- Maintaince: Rs. 800/- ■ Booking Amount: Rs.280000/-
- Additional Rooms: Others ■ Total Floors: 7
- Property on 4th Floor ■ Vitrified Flooring
- Unfurnished

Gallery

Pictures



Floor Plans

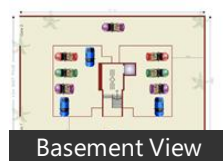

Location

Landmarks

Transportation

Chhatrapati Shivaji International Airp.. Baman Dongri Railway Station (<2km. Belapur CBD Railway Station (<7km), Kharghar Railway Station (<9km), Seawoods Railway Station (<8km), Belapur Station Parking (<7km), Manasarovar Railway Station (<10km.. Juinagar Railway Station (<13km), Vashi Railway Station (<15km), Manraj Tours & Travels (<8km), Seawood Taxi Stand (<7km), Kharghar Taxi Stand (<11km), Khandelwal Tourism (<10km), Gobind Travels (<10km), Kiran Kool Kab Taxi Service (<8km), Nerul Taxi Service (<11km), Sector 6 Taxi Stand (<11km), AtoZMarket.com (<7km), Sector 46/48 Karave NMMT Bus Depo. Belapur Bus Depot (<7km), CBD Belapur Bus Depot (<8km), Jasai (<7km), CBD Belapur (<7km), CIDCO Bhawan (<8km)

Banks & ATMs

Icici (<6km), Ing Vysya Bank ATM (<6km), SBI ATM (<8km), HDFC Bank ATM (<6km), Development Credit Bank Ltd (DCBL... HDFC ATM (<9km), Corporation bank Atm (<8km), Decor Home (I) Pvt Ltd (<9km), Uti Technology Service (<8km), Bank (<6km), Icici Bank (<7km), AXIS Bank (<7km), The Ratnakar Bank Limited (<8km), HDFC (<9km)

Hotels & Guest Houses

Shadan Student Hostel (<6km), CIDCO GuestHouse (<5km), Hotel Neelkiran (<17km), Payal Hotel (<13km), Paying Guest In Koparkhairane (<12k.. Days Inn Navi Mumbai (<21km), Guest House (<13km), K Stars Hotel (<7km), HOTELCORPORATE (MANISHA ENT... Hari Om Nanumal Bhojraj (<7km), Hotel Navrathna (<7km), Tunga (<15km), Humming Bird Suites Pvt Ltd (<6km), Hotel in Navi Mumbai (<8km), Aswith (<6km)

Markets & Shopping Malls

AtoZMarket.com (<7km), D Mart (<9km), Seawoods Estates Shopping Center (... Kakkad Shop (<6km), Jisna (<8km), The Bombay Store (<16km), Apna Bazar (<8km), F Type shopping Centre - Sector 5 (<.. Raghuleela Mall (<15km), R City Mall (<26km), Mahalaxmi Mall (<11km), Atria Millennium Mall (<32km), Horizon The Electronic Mall (<7km), The High Street Phoenix (<31km)

Restaurants & Clubs

K Stars Hotel (<7km), Bombay High Restaurant (<7km), Ice n Spice (<8km), Rockville Bar & Diner (<6km), Dominos (<7km), Kabaab Factory (<7km), Hari Om Nanumal Bhojraj (<7km), Rajesh Restaurant (<4km), Clubhouse (<5km), Club HP Petrol Pump (<7km), Your Fitness Club (<11km), Acres Club (<24km), Just Adventure Club (<11km), Rotary club New Panvel blood bank ... Blue Frog (<31km), Bombay Presidency Golf Club (<23km)

Hospitals & Clinics

Primary Health Center (<1km), D y patil (<11km), Seawoods Hospital (<6km), Terna Sahyadri Speciality Hospital (<... Bombay Hospital (<31km), McClelland Incineration Technologe.. Kem Hospital (<29km), Raj Hospital (<10km), Emeror Life Centre - Emergent Medi-.. Dr. Kalyanshettis Seawoods Health C... OM PHYSIOTHERAPY CLINIC &REHAB. Nexus Clinical Research Pvt Ltd (<8k... Adiraj Clinic (<5km), Braces N Smiles Orthodontics (<9km.. SAI CLINIC - DR. ANUPAMA R YADA... Jack n Jill Children Clinic (<8km)

Movie Halls

BIG Cinemas Kharghar (<10km), Cine Raj Cinema (<7km), Apna Cinema (<13km), Nerul Rock Garden Amphitheatre (<9.. Meghraj Cinema (<16km), Fame Raghuleela (<15km), Ma Krupa Channel 9 (<9km), Metro Big Cinemas (<31km)

Schools & Colleges

DAV Public School (<7km), Padmashree Dr. D.Y. Patil Institute of... School (<3km), Zilla Parishad School (<2km), Delhi Public School (<6km), Aegis School of Business (<6km), Ibsar (<6km), New English School (<2km), SIES College of Management Studies... Terna Engineering College (<9km), St Xaviers College (<31km), Padmashree Dr DY Patil University (<.. Bharati Vidyapeeth College of Archit... Bharati Vidyapeeth, Bharati Vidyapeeth College Of Engin...

Offices

Post Office (<3km), Gram Panchayat (<3km), CIDCO Bhavan (<8km), Konkan Railway (<7km), EGS Survey Pvt Ltd (<7km), Srujan Interiors (<8km), Gram Panchayat (<5km), DE Office Retail (<6km)

Parks

Park (<7km), Rock garden (<9km), Central Park (<14km), Seawoods Estates Phase-I Garden-II (... EGS Survey Pvt Ltd (<7km), Seawoods Estates Phase-I Garden-I (<.. NMMC Park (<6km), Safal Park (<8km)

* All distances are approximate

Properties

Type	Area	Possession	Price *
1BHK Apartment / Flat	595 SqFeet	-	₹ 25 lakhs

* Data has been collected from publicly available sources and may not be up to date.

Ganesh Sai Basera News

Expert Reviews on Ganesh Sai Basera

Explore

[Projects in Navi Mumbai](#)

[Brokers in Navi Mumbai](#)

More Information

Report a problem with this listing

Is any information on this page outdated or incorrect?

[Report it!](#)

Disclaimer: All information is provided by builders, advertisers, or collected from publicly available sources and may not be verified as per RERA guidelines. Any information provided on this website, including facts and figures, should be verified independently before entering into any transaction. PropertyWala.com is only an advertising platform to help connect buyers and sellers and is not a party to any transaction, nor shall be responsible or liable to resolve any disputes between them.

[PropertyWala.com](#) » [Navi Mumbai Real Estate](#) » [Projects in Navi Mumbai](#) » [Ganesh Sai Basera - Ulve, Navi Mumbai](#)