

1 Bedroom Apartment / Flat for sale in Terra Castle, Alwar Road area, Bhi... 15 lakhs



Newly Constructed 1BHK Flat In Gated Community

Q 301, Tower Haver Q, Terra Castle, Alwar Road, Bhiwad...

- Project/Society: [Terra Castle](#)
- Area: 654 SqFeet ▾
- Bedrooms: One
- Bathrooms: One
- Floor: Third
- Total Floors: Twelve
- Furnished: Unfurnished
- Transaction: New Property
- Price: 1,500,000
- Rate: 2,294 per SqFeet **+20%**
- Age Of Construction: 2 Years
- Possession: Immediate/Ready to move

Advertiser Details

Seema Dhankhar
Sales Professional

Tapukra, Bhiwadi
mob: 9999020334
tel:
mail:
www.propertywala.com/U85918089

Scan QR code to get the contact info on your mobile

Description

Newly constructed 1BHK Flat in Gated community
3rd floor
Lift
Wooden flooring in Bed room
Raw Flat
Possession taken

Don't forget to mention that you saw this ad on PropertyWala.com, when you call.

Features

- | | |
|---|--|
| <p>General</p> <ul style="list-style-type: none"> ■ Power Back-up ■ Lifts <p>Lot</p> <ul style="list-style-type: none"> ■ Balcony ■ Park Facing <p>Exterior</p> <ul style="list-style-type: none"> ■ Reserved Parking | <p>Security</p> <ul style="list-style-type: none"> ■ Security Guards ■ Electronic Security ■ Fire Alarm <p>Interior</p> <ul style="list-style-type: none"> ■ Wooden Flooring <p>Maintenance</p> <ul style="list-style-type: none"> ■ Maintenance Staff ■ Water Supply / Storage |
|---|--|

Location

* Location may be approximate

Locality Reviews

Alwar Road area is the main residential hub of Bhiwadi and greater Bhiwadi. Bhiwadi is located very close to Dharuhera in Haryana so due to state advantage Bhiwadi has cheaper rates as compared to Dharuhera in Haryana because of low govt charges by the Rajasthan. Some of people working in Neemrana also residing in Bhiwadi because of all amenities and excellent residential culture in Bhiwadi. Bhiwadi also itself consist of 6 big residential hub.

Pros:

- *Secndry education level is excellent*
- *Good shopping destination with all multiplex*
- *Peaceful area with all facilities near by*

Cons:

- *Lack of good medical facility*

Posted: Feb 24, 2015 by [Dharmendra yadav \(Riddhi Siddhi Promoters\)](#)

Bhiwadi is situated in Alwar district in Rajasthan state and is 70 kilometers away from New Delhi and 200

Pictures



Project Pictures

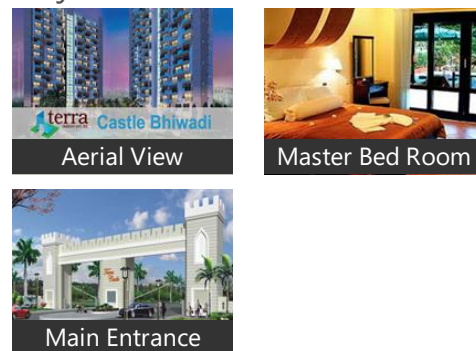

* These pictures are of the project and might not represent the property

Project Floor Plans

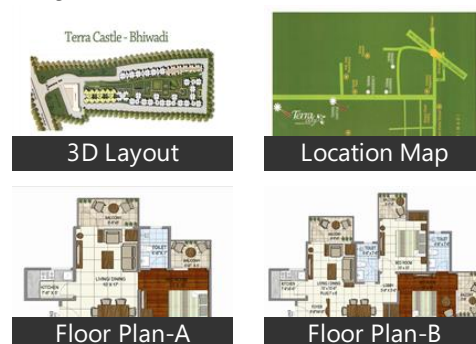

kilometers from Jaipur. The total area of Bhiwadi is 2000 acres out of which 977 are in Khushkhera and 820 acres are in Chopanki.

Pros:

- Well Planned Area
- Availability of good shopping centers, stores, cinema halls, schools

Posted: Jan 4, 2015 by [Deepak kumar \(Lavender Realtech\)](#)



Floor Plan-C

* These floor plans are of the project and might not represent the property

Alwar road is now been most populated and well growing area in Bhiwadi. A lot of industries have already set up there plant.

Pros:

- Well Planned Area
- Well Connected with City

Posted: Mar 15, 2014 by Mintu Rao

Most populated area. With good locality.

Pros:

- 80% Green Area
- On highway location
- Reputed Township by reputed Builder

Posted: Dec 26, 2013 by [Sanjeev Yadav \(Apple Realcon\)](#)

Alwar Road will be the life line of Bhiwadi with 6 lane expressway, metro and freight corridor coming up.

Pros:

- Many industries coming up
- Japanese companies investing in infrastructure.

Cons:

- May take 6 months - 1 year for full swing development

Posted: Oct 2, 2013 by [Vikas Sharma \(Jai Maa Properties\)](#)

Alwar Road is the one of the fastest growing industrial town on the outskirts of Delhi Located just 40 km from Gurgaon, 25 km from Manesar, 70 km from Delhi, 3 km from Daruhera and 80 km from Alwar. A prime industrial town of the NCR and Rajasthan.

Pros:

- Alwar Road Is Growing Area
- Good living atmosphere

Posted: Aug 9, 2013 by [Mukesh Raghav \(Silverx Infratech\)](#)

Alwar road is now been most populated and well growing area in Bhiwadi. A lot of industries have already started here like Honda cars, Honda motors, Shree cement boral gypsum etc., and a lot more to come. Going to be the best area of Bhiwadi as many malls are opening shortly. Haldiram had already been open & MCD is going to give their services soon.

Pros:

- Wide roads
- Availability of conveyance easily
- Lot of industries nearby

Cons:

- Lack of service lanes
- No proper sheltered stop for persons waiting for buses

Posted: May 8, 2013 by [Kapil Singh \(Bhawaani Estate\)](#)

New and upcoming area under NCR of Delhi. Has major international companies like Honda and others renowned brands around the site. DMIC running through.

Pros:

- Excellent appreciation guaranteed.

Posted: May 6, 2013 by Kunal Sangar

Bhiwadi is one of the fastest growing industrial town on the outskirts of Delhi Located just 40kms from Gurgaon, 25kms from Manesar, 70kms from Delhi, 3kms from Daruhera and 80kms from Alwar. A prime industrial town of the NCR and Rajasthan, Bhiwadi comprises three industrial areas: Bhiwadi, Chopanki and Khushkhera. Spread over nearly 5,300 acres, there are around 2,500 industries operating in these three places. All in all, Bhiwadi is extremely well connected and keeps you in touch with the world without the noise and pollution of a metro city.

USD 90 billion DMIC Project Delhi-Mumbai Industrial Corridor, mega infra-structure project

- The project was proposes in 2006 and approved in 2009 and now into action.
- Financial & technical aids from Japan, Ensures timely execution and completion of project.
- Covering Dedicated Freight Corridor (DFC) between Delhi and Mumbai, overall length of 1483 km having high-speed connectivity for High Axle Load Wagons (25 Tonne) of Double Stacked Container Trains supported by high power locomotives.
- Passing through the six States - U.P, NCR of Delhi, Haryana, Rajasthan, Gujarat and Maharashtra
- End terminals at Dadri in the National Capital Region of Delhi and Jawaharlal Nehru Portnear Mumbai
- This project incorporates Nine Mega Industrial zones of about 200-250 sq. km. High speed freight line, three ports, and six air ports; a six-lane intersection-free expressway connecting the country's political and financial capitals and a 4000 MW power plant.

Short listed Investment Regions (IRs): of DMIC Project

- Manesar – Bawal Investment Region in Haryana as Auto Component/ Automobile Investment Region;
- Khushkhera – Bhiwadi – Neemrana Investment Region in Rajasthan as Manufacturing/ Automobile/ Auto Component Investment Region;

Rajeev Kohli

VP Sales

Proviance PropGuide Pvt Ltd

Pros:

- *Developing at very fast pace*
- *Upcoming DMIC Project*

Cons:

- *Best for investors only*

Posted: May 4, 2013 by [Rajeev Kohli \(Province Proppguide\)](#)

Alwar Road area, Bhiwadi is rated 8 out of 10 based on 9 user reviews.

Disclaimer: The reviews are opinions of PropertyWala.com members, and not of PropertyWala.com.

Project Reviews

Terra Castle

Terra castle is a beautifully designed project with 1/2/3 bhk apartments and podium park. Parking is fully covered. Podium concept is going to be introduced first time in Bhiwadi. Project is situated on 6 lane mega highway.

Pros:

- *Podium concept*
- *Optimum sizes*
- *Situated on 6 lane mega highway.*

Cons:

- *1 bhk units are not available now*

Posted: May 30, 2013 by [Pradeep Kumar \(The City Sites Infra Services\)](#)

Terra Castle Bhiwadi is rated 7 out of 10 based on 1 user reviews.

Disclaimer: The reviews are opinions of PropertyWala.com members, and not of PropertyWala.com.

Explore

[Similar Properties](#)

[Properties in Alwar Road area, Bhiwadi](#)

[Projects in Bhiwadi](#)

[Brokers in Bhiwadi](#)

More Information

Report a problem with this listing

Is this property no longer available or has incorrect information?

[Report it!](#)

Disclaimer: All information is provided by advertisers and should be verified independently before entering into any transaction. You may visit the relevant RERA website of your state to verify the details of this property. PropertyWala.com is only an advertising platform to help connect buyers and sellers and is not a party to any transactions, nor shall be responsible or liable to resolve any disputes between them.